



Lytham
Estate Agents

Lytham Estate Agents
2a Clifton Square,
FY8 5JP

Telephone: 01253 796996

Email:
info@lythamestateagents.co.uk

Website:
www.lythamestateagents.co.uk/



19 The Homestead, Lytham St. Annes FY8 5LJ

£155,000

Available with No Chain – First-Floor Retirement Apartment in Sought-After Central Lytham Location



Hallway

Carpeted flooring, electric storage heater, and a wall-mounted intercom system. Features a wall-mounted light and a storage cupboard with fitted shelving and an Ariston water heater.

Lounge

A bright and inviting space with carpeted flooring, a front-facing UPVC double-glazed window offering lovely views of the communal gardens, and an electric storage heater. Features an electric fireplace with a decorative surround and three wall lights.

Kitchen

A modern fitted kitchen with a range of wall and base units and laminate work surfaces. Includes fitted shelving and an obscured UPVC double-glazed window. Appliances include a dishwasher, Smeg oven, and Bosch four-ring induction hob. A stainless steel sink with mixer tap and drainer is complemented by wall lighting.

Bedroom

A well-proportioned room with carpeted flooring, two wall-mounted lights, and ceiling coving. Offers space for freestanding bedroom furniture and includes an electric storage heater. A UPVC double-glazed window provides lovely views of the communal gardens.

Bathroom

Three-piece suite comprising a WC with button flush, pedestal wash basin with mixer tap, and a step-in tiled shower cubicle with a Triton electric shower. Additional features include an extractor fan, ceiling light and wall light, chrome heated towel rail, and loft hatch.

Additional Information

Benefits from communal lounge, laundry room, shower room and on-site House Manager.

Council Tax Band - B

Disclaimer

You may download or store this material for your own personal use and research. You may NOT republish, retransmit, redistribute or otherwise make the material available to any party or make the same available on any website, online service or bulletin board of your own or of any other party or make the same available in hard copy or in any other media without the website owner's express prior written consent. The website owner's copyright must remain on all reproductions of material taken from this website. Please note we have not tested any apparatus, fixtures, fittings, or services. Interested parties must undertake their own investigation into the working order of these items. All measurements are approximate and photographs provided for guidance only.



Floor Plans

GROUND FLOOR
418 sq.ft. (38.8 sq.m.) approx.

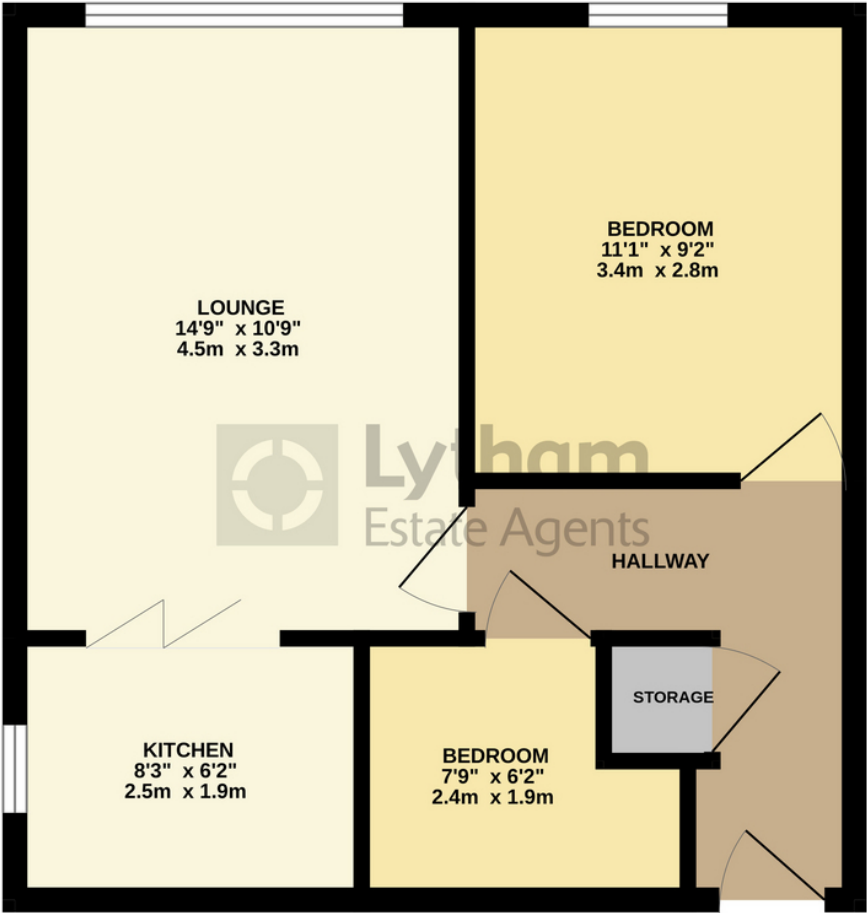

TOTAL FLOOR AREA : 418 sq.ft. (38.8 sq.m.) approx.
Whilst every attempt has been made to ensure the accuracy of the floorplan contained here, measurements of doors, windows, rooms and any other items are approximate and no responsibility is taken for any error, omission or mis-statement. This plan is for illustrative purposes only and should be used as such by any prospective purchaser. The services, systems and appliances shown have not been tested and no guarantee as to their operability or efficiency can be given.
Made with Metropix ©2025