



Lytham
Estate Agents

Lytham Estate Agents
2a Clifton Square,
FY8 5JP

Telephone: 01253 796996

Email:
info@lythamestateagents.co.uk

Website:
www.lythamestateagents.co.uk/



21a West Bank Avenue, Lytham St. Annes FY8 5RB

£320,000

Spacious Three-Bedroom First-Floor Apartment in Prime Lytham Location – Ideal for Homeowners or Investors, Viewing Essential!



Lounge

A spacious and inviting lounge featuring a large front-facing double-glazed bay window. Additional highlights include a radiator, pendant light, wall lighting, and decorative ceiling coving. A side door provides access to the entrance hallway.

Kitchen Diner

Fitted with a range of modern wall and base units, complemented by laminate work surfaces and a tiled splashback. The kitchen is equipped with integrated appliances, including a four-ring gas hob with an extractor fan, an oven, a microwave, and a fridge freezer, with additional space for a washing machine. A kitchen sink with a mixer tap is positioned beneath a side-facing double-glazed window. Vinyl flooring, ceiling downlighting, a wall-mounted intercom system, and a radiator complete the room. There is also ample space for a dining table and chairs.

Hall

Spacious hallway with carpeted flooring, decorative coving, and a skylight. Two pendant lights, two radiators, and doors leading to all rooms.

Bedroom One

A generous double bedroom with two side-facing double-glazed windows, carpeted flooring, and a radiator. The room benefits from downlighting, wall lighting, a built-in storage cupboard, and an en-suite shower room.

Ensuite

A modern, fully tiled en-suite featuring a WC with a button flush, a wash basin with a mixer tap, and a step-in shower cubicle with an overhead shower. Ceiling downlighting and an extractor fan complete the space.

Bedroom Two

A well-proportioned double bedroom with carpeted flooring, a side-facing double-glazed window, a radiator, decorative coving, and ceiling downlighting.

Bedroom Three

Another spacious double bedroom with a rear-facing double-glazed window, carpeted flooring, a radiator, downlighting, and wall lighting.

Bathroom

A stylish, fully tiled bathroom featuring a three-piece suite comprising a WC with a button flush, a wash basin with a mixer tap, and a freestanding bath with a mixer tap. A side-facing obscured double-glazed window. Ceiling downlighting and an extractor fan complete the space.

Cloaks/WC

A fully tiled cloakroom with a rear-facing obscured double-glazed window. Includes a WC with a button flush, a wall-mounted wash basin with a mixer tap, a radiator, and ceiling downlighting.

Disclaimer

You may download or store this material for your own personal use and research. You may NOT republish, retransmit, redistribute or otherwise make the material available to any party or make the same available on any website, online service or bulletin board of your own or of any other party or make the same available in hard copy or in any other media without the website owner's express prior written consent. The website owner's copyright must remain on all reproductions of material taken from this website. Please note we have not tested any apparatus, fixtures, fittings, or services. Interested parties must undertake their own investigation into the working order of these items. All measurements are approximate and photographs provided for guidance only.



Floor Plans

GROUND FLOOR
1214 sq.ft. (112.8 sq.m.) approx.

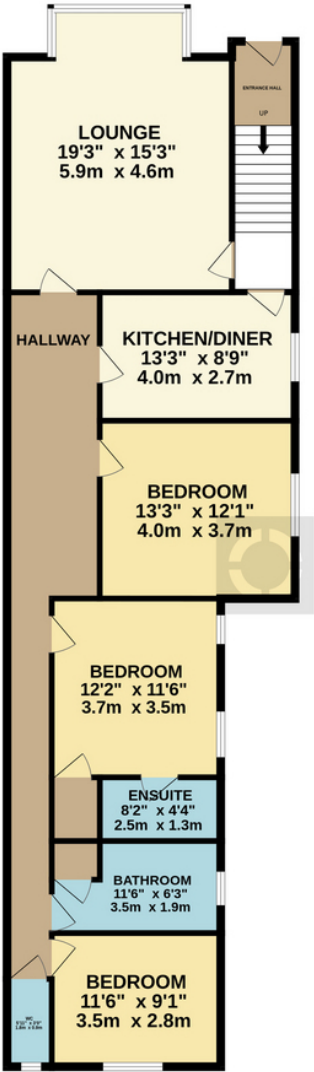

Lytham
Estate Agents

TOTAL FLOOR AREA : 1214 sq.ft. (112.8 sq.m.) approx.

Whilst every attempt has been made to ensure the accuracy of the floorplan contained here, measurements of doors, windows, rooms and any other items are approximate and no responsibility is taken for any error, omission or mis-statement. This plan is for illustrative purposes only and should be used as such by any prospective purchaser. The services, systems and appliances shown have not been tested and no guarantee as to their operability or efficiency can be given.
Made with Metropix ©2025