



Lytham
Estate Agents

Lytham Estate Agents
2a Clifton Square,
FY8 5JP

Telephone: 01253 796996

Email:
info@lythamestateagents.co.uk

Website:
www.lythamestateagents.co.uk/



12 Fairview Avenue, Lytham St. Annes FY8 3TA

£199,950

Charming Three-Bedroom Family Home in a Serene Residential Area. Viewing essential to appreciate the size on offer! VIDEO TOUR AVAILABLE!



Entrance Hall

Composite obscure double glazed door and windows to the front. Carpeted area to entrance, laminate flooring, carpeted staircase leading to the first floor, coving, ceiling light, useful fitted storage/cloaks cupboard, and radiator with decorative cover. Doors leading to the following rooms:

Lounge

UPVC double glazed window to the front. Coving, ceiling light, TV aerial point, carpeted flooring and feature fireplace with granite back and hearth and inset gas fire.

Dining/Sitting Room

UPVC double glazed window to the rear. Carpeted flooring, TV aerial point, coving, ceiling light and recessed fireplace housing log burner.

Kitchen

UPVC double glazed window to the rear and obscure door to the side. Range of fitted wall and base units with laminate work surfaces and inset single bowl sink and drainer with chrome mixer tap. Integrated Zanussi oven and four ring gas hob, with extractor above. Cupboard housing combi boiler. Splash back panelling, tiled flooring, part tiled walls, chrome ladder style towel radiator, coving, ceiling light and space for under counter fridge freezer. Door to:

Utility

UPVC double glazed obscure window to the side. Laminate work surface, tiled flooring and space and plumbing for washing machine and tumble dryer.

First Floor Landing

Aforementioned staircase from the ground floor. UPVC double glazed obscure window to the side. Carpeted flooring, coving and ceiling light. Doors leading to the following rooms:

Bedroom One

UPVC double glazed window to the front. Range of fitted wardrobes and drawers with cupboards above and fitted mirror. Carpeted flooring, wall lights, ceiling light, coving and radiator.

Bedroom Two

UPVC double glazed obscure window to the rear. Range of fitted wardrobes housing TV aerial point. Carpeted flooring, radiator, coving and ceiling light.

Bedroom Three

UPVC double glazed window to the front. Carpeted flooring, radiator, ceiling light, coving and TV aerial point.

Family Bathroom

UPVC double glazed obscure window to the rear. Two piece white suite, comprising: panelled bath with chrome mixer tap, wall mounted chrome controls with handheld shower attachment on riser rail, and glass shower screen; and pedestal wash hand basin with chrome mixer tap. Tiled walls and flooring, two chrome ladder style towel radiators, coving, ceiling light and fitted corner vanity cabinet.

Separate WC

UPVC double glazed obscure window to the side. Ceiling light, tiled walls and flooring, and WC with push button flush.

External

To the front, the garden has been paved and stone chipped with bordering plants and shrubs. Double wrought iron gates give access for parking.
To the rear, the private low maintenance garden has been paved, with bordering shrubs and trees. Large timber shed, external lighting and gated access to the front and rear.

Disclaimer

You may download or store this material for your own personal use and research. You may NOT republish, retransmit, redistribute or otherwise make the material available to any party or make the same available on any website, online service or bulletin board of your own or of any other party or make the same available in hard copy or in any other media without the website owner's express prior written consent. The website owner's copyright must remain on all reproductions of material taken from this website. Please note we have not tested any apparatus, fixtures, fittings, or services. Interested parties must undertake their own investigation into the working order of these items. All measurements are approximate and photographs provided for guidance only.



Floor Plans

GROUND FLOOR

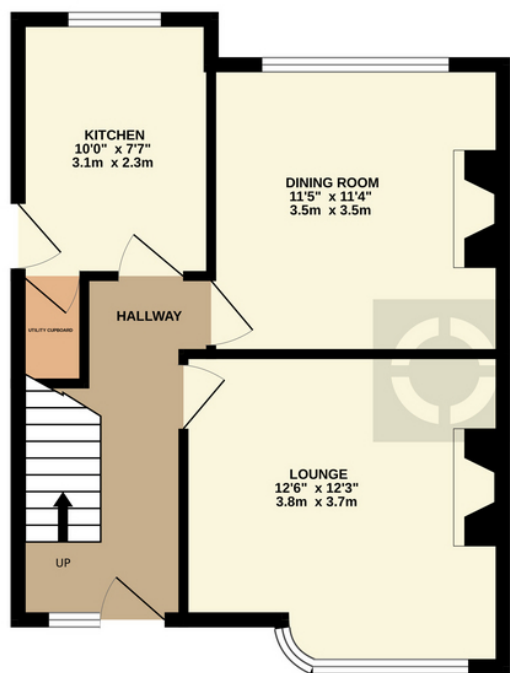

1ST FLOOR

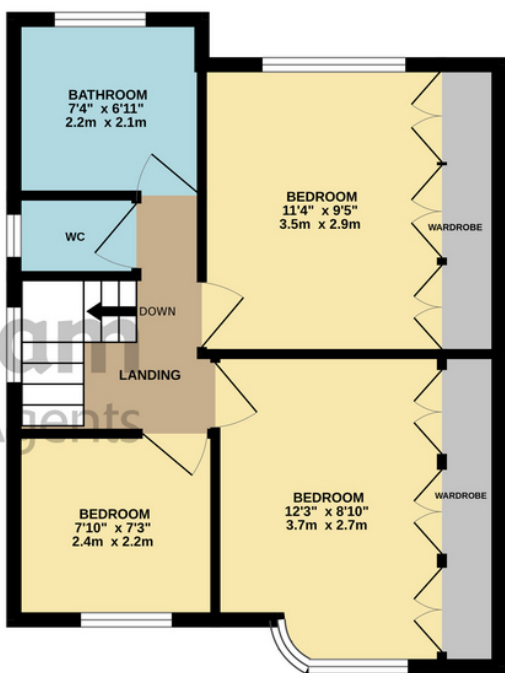

Whilst every attempt has been made to ensure the accuracy of the floorplan contained here, measurements of doors, windows, rooms and any other items are approximate and no responsibility is taken for any error, omission or mis-statement. This plan is for illustrative purposes only and should be used as such by any prospective purchaser. The services, systems and appliances shown have not been tested and no guarantee as to their operability or efficiency can be given.
Made with Metropix 6/2024