

**8 KENNEDY MEADOW
HUNGERFORD**



Russell Marshall
Estate Agents

8 Kennedy Meadow Hungerford, Berkshire, RG17 0LR

Guide Price £635,000

Approximately 9.2 Miles to Newbury

Approximately 0.9 Miles to Hungerford
Railway Station

Approximately 4 Miles to M4 J14

- Freehold
- Detached House
- Entrance Hall
- Cloakroom/W.C.
- Kitchen/Dining Room
- Sitting Room
- Study
- Conservatory/Garden Room
- Four Bedrooms
- En-Suite Shower Room
- Family Bathroom
- Garage (Divided to form a Store Room)
- Driveway
- Pretty Garden



Situation

The pretty market Town of Hungerford is steeped in History and sits on the banks of the chalk stream River Kennet and the Kennet and Avon canal. The Town is well served by a variety of shops including butchers, bakers, independent retailers and of course antique shops. Other amenities include two supermarkets, a post office, two building societies and a doctors surgery. There is also a swimming pool, leisure sports centre, gym and tennis club.



The Property

A superbly presented detached house situated in a highly sought after residential cul-de-sac.

This lovely home includes a bright and airy Kitchen/ Dining room with integrated appliances and a comfortable Sitting room with a feature log burner in the fireplace.

The Sitting room leads through to an attractive Garden room and there is also a useful Study and a Cloakroom/W.C.

Upstairs, four Bedrooms are served by a high quality en-suite Shower room and an equally impressive main Bathroom.

Gas central heating and double glazing are the finishing touch to this very special home.

Outside

At the front of the house there is a neatly lawned garden and a driveway leads to the single garage which has been divided to form a store room at one end.

To the rear there is a pretty garden laid neatly to lawn with a paved patio and a useful deck designed for a hot tub. The garden enjoys a good degree of seclusion.







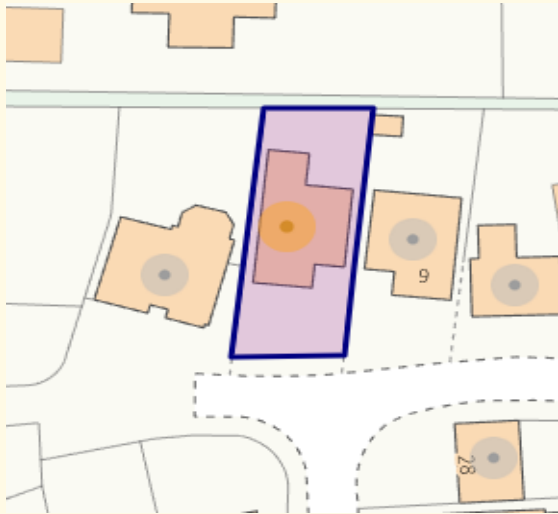

Score	Energy rating	Current	Potential
92+	A		
81-91	B		
69-80	C	69 C	80 C
55-68	D		
39-54	E		
21-38	F		
1-20	G		

Services

Mains Water & Drainage

Mains Electricity

Mains Gas

Council Tax Band: F

What 3 Words Location: ///score.villager.signal



01488 686867

www.russell-marshall.co.uk
19 High Street
Hungerford, Berkshire, RG17 0NL

Kennedy Meadow, Hungerford, RG17

Approximate Area = 1550 sq ft / 143.9 sq m

Limited Use Area(s) = 41 sq ft / 3.8 sq m

Garage = 53 sq ft / 4.9 sq m

Total = 1644 sq ft / 152.6 sq m

For identification only - Not to scale



Denotes restricted
head height

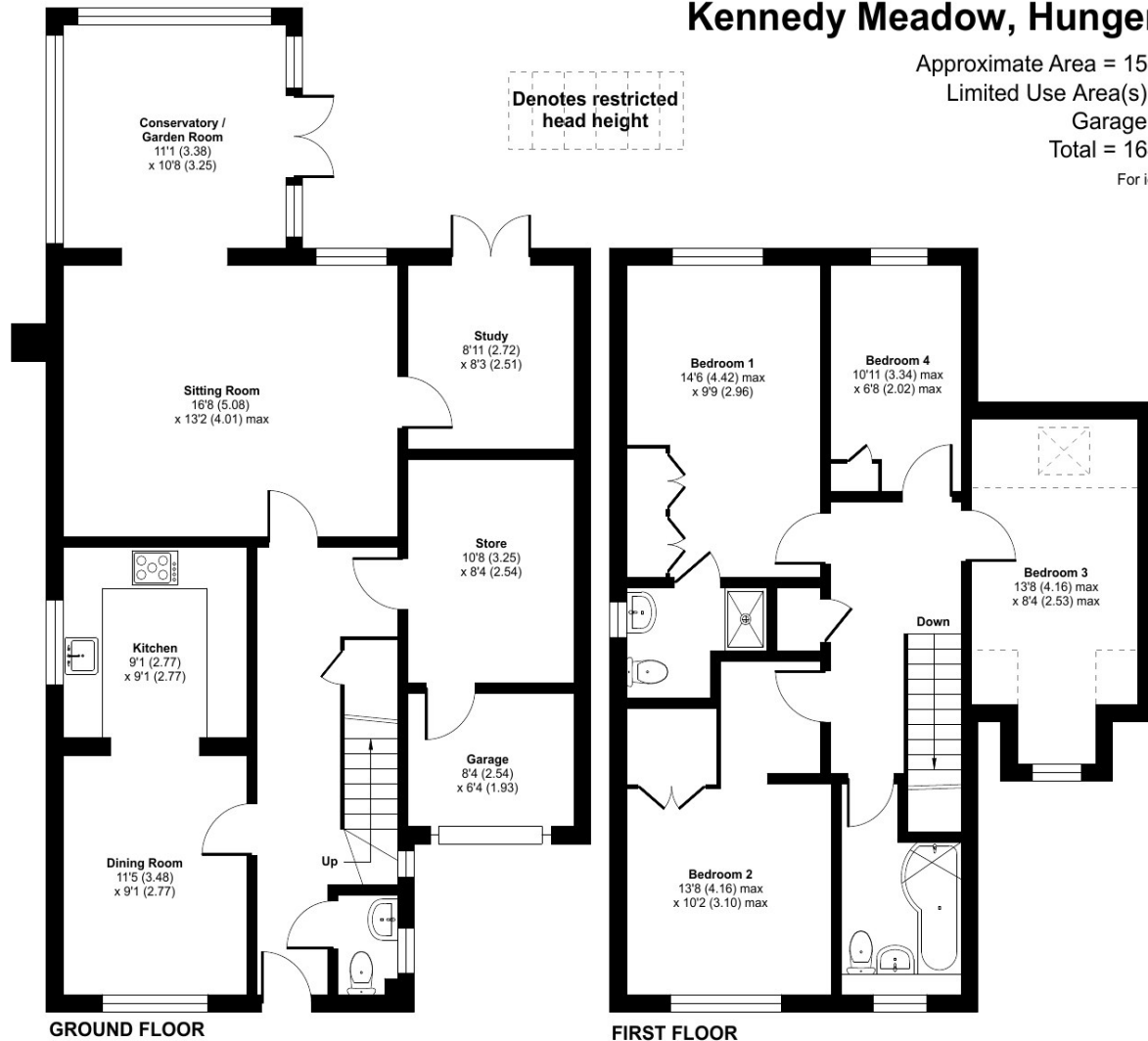

Floor plan produced in accordance with RICS Property Measurement 2nd Edition, Incorporating International Property Measurement Standards (IPMS2 Residential). © nchecon 2025. Produced for Russel Marshall. REF: 1230317



These particulars are not an offer or contract or part thereof. Their accuracy is not guaranteed. No statement made in them shall be relied on as a statement or representation of fact and we and the vendors have no responsibility for them. We and our employees have no authority to and do not make or give any representations or warranty concerning this property any appliances mentioned or general services and any intending purchase must rely upon an inspection of the property.

Russell Marshall Estate Agents is a trading name of RM Property Developments. Registered in England and Wales. No. 4872266. Registered Office Griffins Court, 24-32 London Road, Newbury, Berks RG14 1JX