

NOT TO SCALE: THIS IS AN APPROXIMATE GUIDE TO THE RELATIONSHIP BETWEEN ROOMS

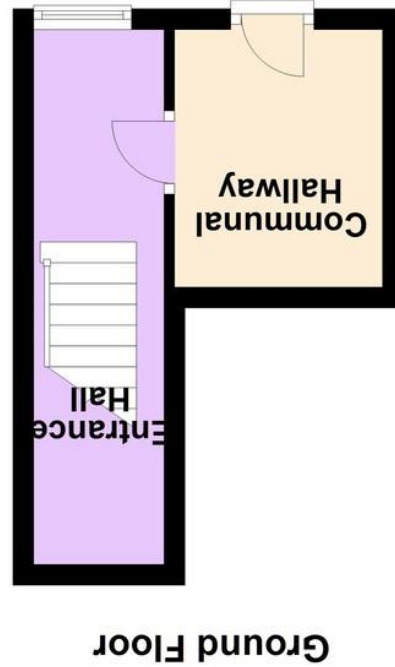
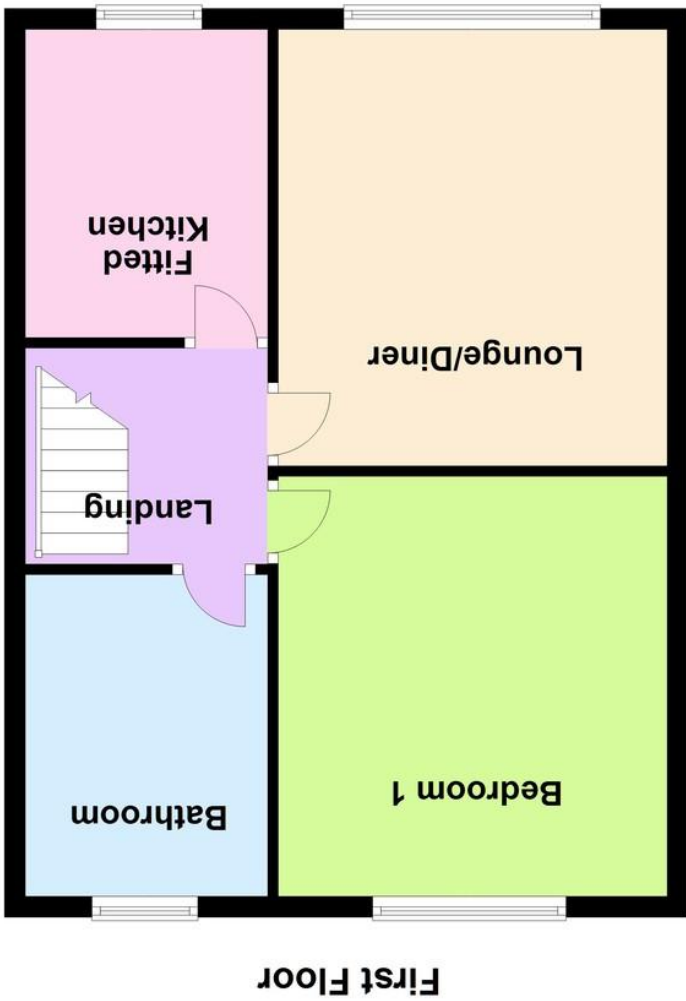

If you require the full EPC certificate direct to your email address please contact the sales branch marketing this property and they will email the EPC certificate to you in a PDF format. Please note that on occasion the EPC may not be available due to reasons beyond our control, the Regulations state that the EPC must be presented within 21 days of initial marketing of the property. Therefore we recommend that you regularly monitor our website or email us for updates. Please feel free to relay this to your Solicitor or License Conveyor.

England & Wales	
EU Directive 2002/91/EC	
www.epc4u.com	
Very energy efficient - lower running costs	A (92+)
	B (81-91)
	C (69-80)
	D (55-68)
	E (39-54)
	F (21-38)
Not energy efficient - higher running costs	G (1-20)
Current	77
Potential	71

Boldmere | 0121 321 3991



- BEING SOLD VIA MODERN METHOD OF AUCTION
- FIRST FLOOR FLAT
- IMMACULATELY PRESENTED THROUGHOUT
- NO UPWARD CHAIN
- DOUBLE BEDROOM

Boldmere Road, Boldmere, Sutton Coldfield, B73 5UE

Auction Guide Price
£130,000

Property Description

BEING SOLD VIA MODERN METHOD OF AUCTION

A fantastic opportunity has arisen to purchase this beautifully presented one bedroom first floor flat where, viewing is considered essential to appreciate the size and standard of accommodation on offer. In brief the accommodation comprises hallway, landing, fitted kitchen, lounge/diner, master bedroom and bathroom. The property benefits from allocated parking space, and double glazing and gas central heating (both where specified). The residence occupies this sought after residential location set in the heart of Boldmere and conveniently situated for amenities including the shops, bars and restaurants within Boldmere with public transport on hand including Wyde Green railway station within reach. Easy access to Birmingham Grand Central Station and commuter networks.

The property is approached via communal parking area with communal entrance door into the communal hall and door off to the side and stairs to the first floor landing.

LANDING Having doors off to bedroom, bathroom and loft access.

LOUNGE 13' 4" max x 12' max (4.06m x 3.66m) Having doors off to bedroom, bathroom and loft access.

KITCHEN 7' 8" max x 9' 7" max (2.34m x 2.92m) Having double glazed window to front elevation, being fitted to comprise of a range of wall, drawer and base level units with work surface over, incorporating a sink unit with drainer and mixer taps, integrated oven, hob and extractor fan and space for further white goods.

MASTER BEDROOM 12' 1" max x 13' 3" max (3.68m x 4.04m) Having double glazed window to rear, central heating radiator and the main focal point of the room being a feature fireplace.

BATHROOM 7' 6" x 9' 8" (2.29m x 2.95m) Having opaque window to rear garden, chrome effect heated towel rail, complimentary tiling, suite comprising panelled bath with mixer shower over, separate shower cubicle with shower over, low flush wc, pedestal hand wash basin.

Council Tax Band A - Birmingham City Council

Predicted mobile phone coverage and broadband services at the property:-

Mobile coverage - voice likely available for EE and O2, limited for Three and Vodafone and data likely available for EE, limited for Three, O2 and Vodafone.

Broadband coverage:-

Broadband Type = Standard Highest available download speed 3 Mbps. Highest available upload speed 0.5 Mbps.

Broadband Type = Superfast Highest available download speed 80 Mbps. Highest available upload speed 20 Mbps.

Broadband Type = Ultrafast Highest available download speed 1000 Mbps. Highest available upload speed 220Mbps.

Networks in your area - Openreach, Virgin Media

The mobile and broadband information above has been obtained from the Mobile and Broadband checker - Ofcom website.

Sellers are asked to complete a Property Information Questionnaire for the benefit of buyers. This questionnaire provides further information and declares any material facts that may affect your decision to view or purchase the property. This document will be available on request.

Looking to make an offer? We are committed to finding the right buyer for the right property and try to do everything we can from the outset to ensure the sales we agree, subject to contract, will proceed to completion of contracts within a fair time frame that meets all parties' expectations. At one point during the offer negotiations, one of our branch-based mortgage advisers will call to financially qualify your offer. We recommend that you take this advice before making an offer.



BUYERS COMPLIANCE ADMINISTRATION FEE: in accordance with the Money Laundering Regulations 2007, Estate Agents are required to carry out due diligence on all clients to confirm their identity, including eventual buyers of a property. Green and Company use an electronic verification system to verify Clients' identity. This is not a credit check, so it will have no effect on credit history. By placing an offer on a property, you agree (all buyers) that if the offer is accepted, subject to contract, we, as Agents for the seller, can complete this check for a fee of £25 plus VAT (£30 inc VAT), which is non-refundable under any circumstance. A record of the search will be retained securely by Green and Company within the electronic property file of the relevant property.

FIXTURES AND FITTINGS as per sales particulars.

TENURE

The Agent understands that the property is leasehold with approximately 120 years remaining. Service Charge is currently running at £50 per annum and Ground Rent is currently running at £200 per annum. However we are still awaiting confirmation from the vendors Solicitors and would advise all interested parties to obtain verification through their Solicitor or Surveyor.

GREEN AND COMPANY has not tested any apparatus, equipment, fixture or services and so cannot verify they are in working order, or fit for their purpose. The buyer is strongly advised to obtain verification from their Solicitors or Surveyor. Please note that all measurements are approximate. If you require the full EPC certificate to direct to your email address please contact the sales branch marketing this property and they will email the EPC certificate to you in a PDF format.

WANT TO SELL YOUR OWN PROPERTY?

CONTACT YOUR LOCAL GREEN & COMPANY BRANCH ON 0121 321 3991

This property is for sale by Green & Company Ltd powered by iamsold Ltd.

The property is for sale by Modern Method of Auction. Should you view, offer or bid on the property, your information will be shared with the Auctioneer, iamsold Limited.

This method of auction requires both parties to complete the transaction within 56 days of the draft contract for sale being received by the buyers solicitor. This additional time allows buyers to proceed with mortgage finance.

The buyer is required to sign a reservation agreement and make payment of a non-refundable Reservation Fee. This being 4.5% of the purchase price including VAT, subject to a minimum of £6,600.00 including VAT. The Reservation Fee is paid in addition to the purchase price and will be considered as part of the chargeable consideration for the property in the calculation for stamp duty liability. Buyers will be required to go through an identification verification process with iamsold and provide proof of how the purchase would be funded.

The property has a Buyer Information Pack which is a collection of documents in relation to the property. The documents may not tell you everything you need to know about the property, so you are required to complete your own due diligence before bidding. A sample copy of the Reservation Agreement and terms and conditions are also contained within this pack. The buyer will also make payment of £300.00 including VAT to wards the preparation cost of the pack, where it has been provided by iamsold.

The property is subject to an undisclosed Reserve Price with both the Reserve Price and Starting Bid being subject to change.

Referral Arrangements

The Partner Agent and the Auctioneer may recommend the services of third parties to you. Whilst these services are recommended as it is believed they will be of benefit; you are under no obligation to use any of these services and you should always consider your options before services are accepted. Where services are accepted the Auctioneer or Partner Agent may receive payment for the recommendation and you will be informed of any referral arrangement and payment prior to any services being taken by you.