

N A I S H

ESTATE AGENTS



YORK
EST. 1939



15 Alma Terrace

, York, YO10 4DQ

Alma House is an incredible example of an historic York building undergoing a grand design with outstanding and unique results.

Asking Price £1,450,000

15 Alma Terrace

, York, YO10 4DQ



- INCREDIBLE REDESIGN OF OLD POLICE STATION
- WALKING DISTANCE TO YORK CITY CENTRE
- OFF STREET PARKING
- LOXONE HOME AUTOMATION SYSTEM
- SEMI COMMERCIAL KITCHEN
- RESIDENTIAL PROPERTY BUT STILL HOLDS COMMERCIAL LICENSE
- RENOVATED THROUGHOUT TO THE HIGHEST STANDARD
- INCREDIBLE CHARACTER AND FEATURES

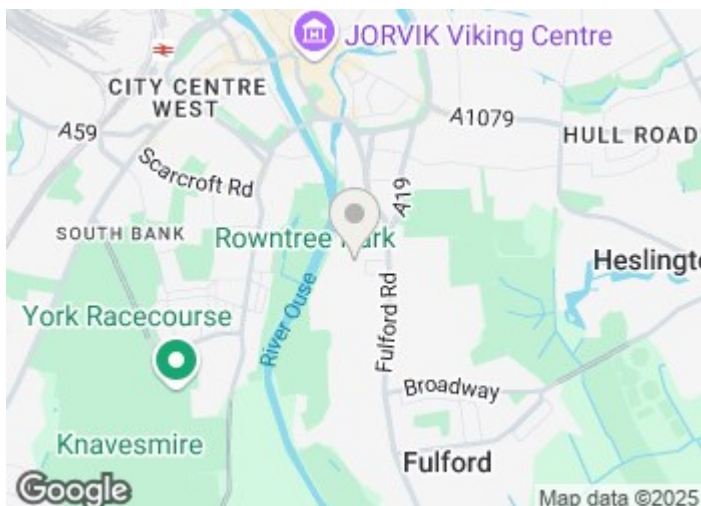

Directions



Floor Plan

Alma Terrace

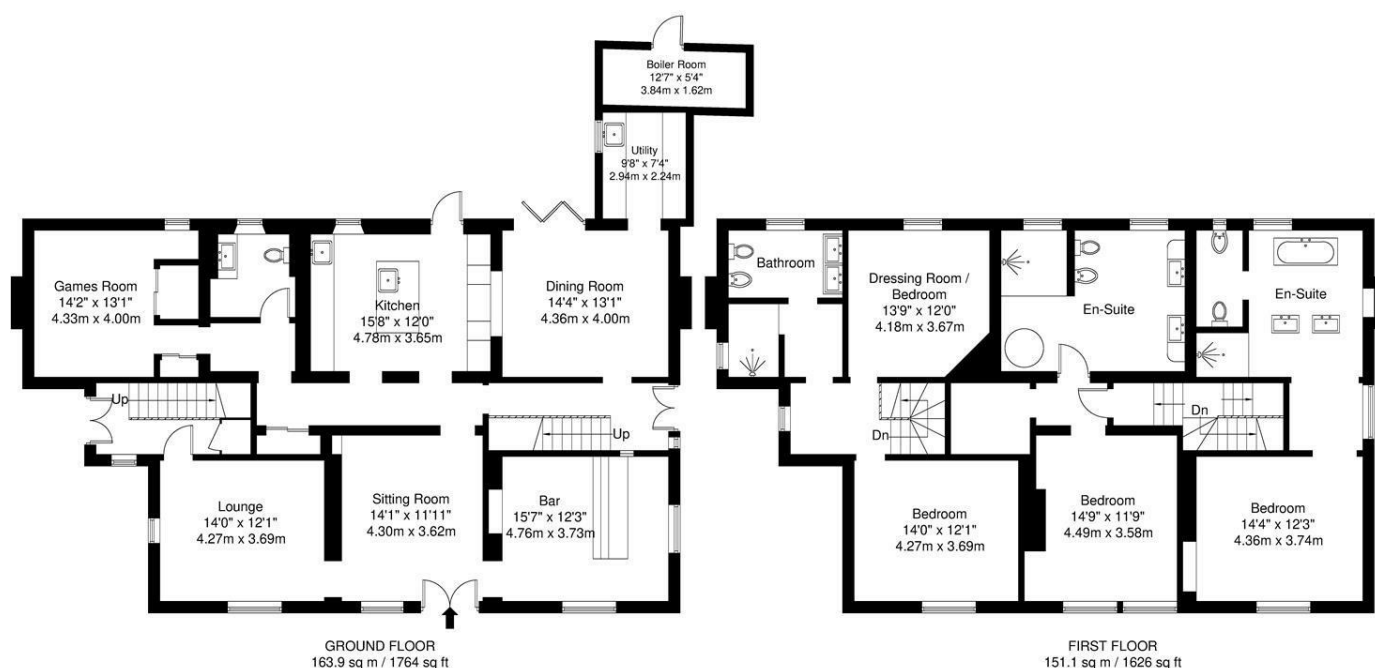

APPROXIMATE GROSS INTERNAL AREA = 315 sq m / 3390 sq ft

Whilst every attempt has been made to ensure the accuracy of the floorplan contained here, measurements of doors, windows, rooms and any other items are approximate and no responsibility is taken for any error, omission or mis-statement. This plan is for illustrative purposes only and should be used as such by any prospective purchaser. The services, systems and appliances shown have not been tested and no guarantee as to their operability or efficiency can be given.

These particulars, whilst believed to be accurate are set out as a general outline only for guidance and do not constitute any part of an offer or contract. Intending purchasers should not rely on them as statements of representation of fact, but must satisfy themselves by inspection or otherwise as to their accuracy. No person in this firm's employment has the authority to make or give any representation or warranty in respect of the property.