



## Apartment 11 Terry's Mews, Bishopthorpe Road , York, YO23 1PG

This delightful ground floor apartment is situated within a most sought-after development to the south of York.  
WATCH THE VIDEO FOR FULL ASPECT.

**£225,000**

# Apartment 11 Terry's Mews, Bishopthorpe Road , York, YO23 1PG



- Ground Floor Apartment
- Two Bedrooms
- Allocated Parking
- Modern Interior
- Walking Distance to City Centre
- Desirable Location

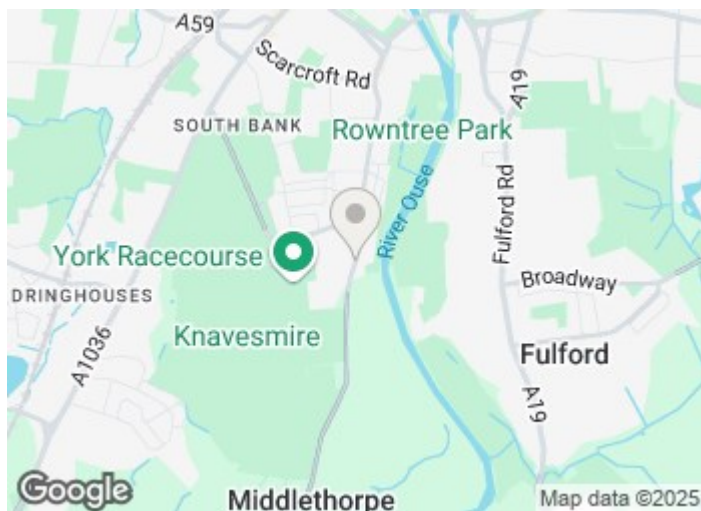

**Directions**





Floor Plan

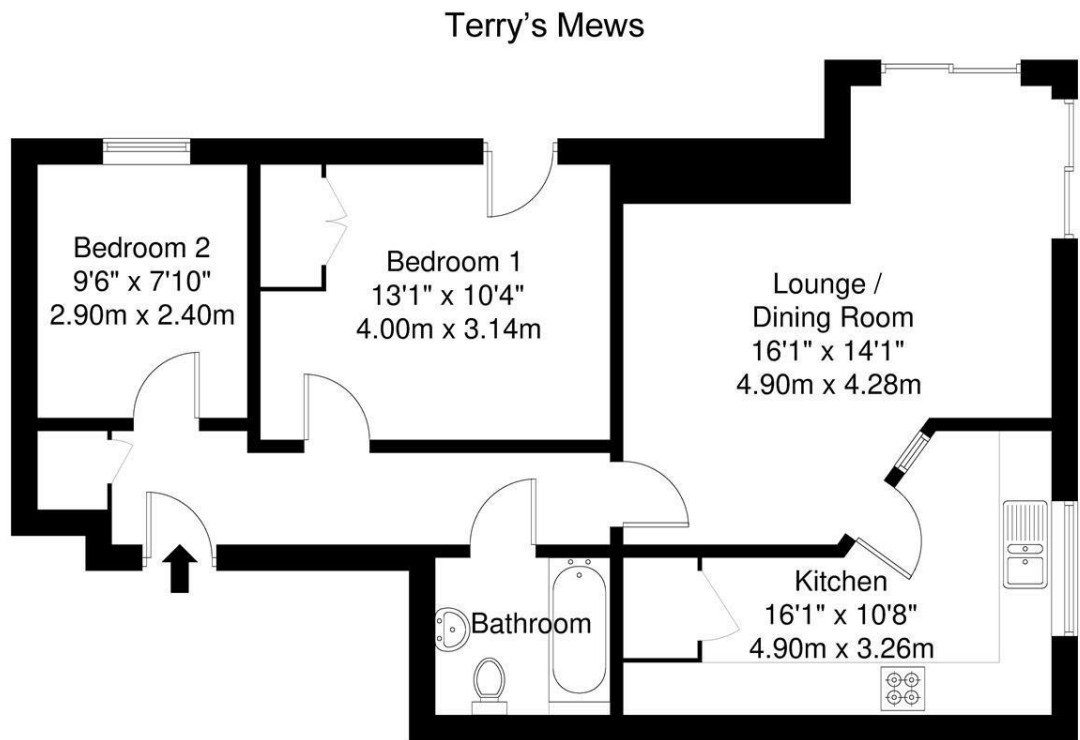

GROUND FLOOR  
65.9 sq m / 709 sq ft

APPROXIMATE GROSS INTERNAL AREA = 65.9 sq m / 709 sq ft

Whilst every attempt has been made to ensure the accuracy of the floorplan contained here, measurements of doors, windows, rooms and any other items are approximate and no responsibility is taken for any error, omission or mis-statement. This plan is for illustrative purposes only and should be used as such by any prospective purchaser. The services, systems and appliances shown have not been tested and no guarantee as to their operability or efficiency can be given.

These particulars, whilst believed to be accurate are set out as a general outline only for guidance and do not constitute any part of an offer or contract. Intending purchasers should not rely on them as statements of representation of fact, but must satisfy themselves by inspection or otherwise as to their accuracy. No person in this firms employment has the authority to make or give any representation or warranty in respect of the property.

