

NAISH

ESTATE AGENTS



YORK
EST. 1939



'The house is so close to access to nature walks whilst still being close to York. it has easy access to all the road networks and the village has so many fantastic facilities with so much going on for all ages. If i could, i would have stayed'

**HONESTY
INTEGRITY**

NAISH
YORK



57 Keble Park North
Bishopthorpe, York, YO23 2SX

Excellent two bedroom home in the heart of Bishopthorpe, York.

Asking Price £260,000

57 Keble Park North

Bishopthorpe, York, YO23 2SX



- Two Bedrooms
- WATCH VIDEO
- Garage
- Extended with spacious garden
- Well presented throughout
- No Onward Chain
- 5-6% investor yield



Directions



Floor Plan

57 Keble Park North

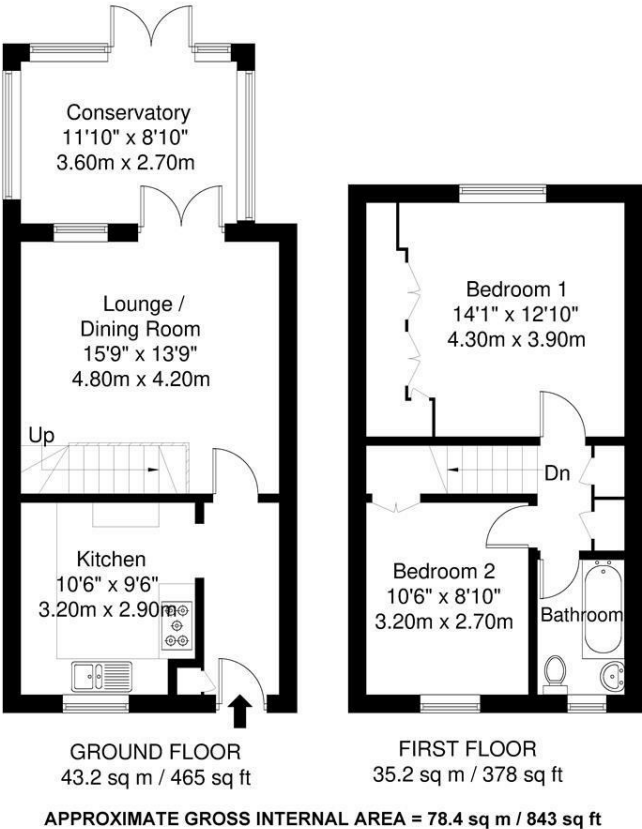

Whilst every attempt has been made to ensure the accuracy of the floorplan contained here, measurements of doors, windows, rooms and any other items are approximate and no responsibility is taken for any error, omission or mis-statement. This plan is for illustrative purposes only and should be used as such by any prospective purchaser. The services, systems and appliances shown have not been tested and no guarantee as to their operability or efficiency can be given.

These particulars, whilst believed to be accurate are set out as a general outline only for guidance and do not constitute any part of an offer or contract. Intending purchasers should not rely on them as statements of representation of fact, but must satisfy themselves by inspection or otherwise as to their accuracy. No person in this firms employment has the authority to make or give any representation or warranty in respect of the property.

