

N A I S H
E S T A T E A G E N T S



Y O R K
E S T . 1 9 3 9



Bishopthorpe Garth Sim Balk Lane

Bishopthorpe, York, YO23 2UE

One of Yorkshires finest homes set in the wonderful village of Bishopthorpe.

Asking Price £2,600,000

Bishopthorpe Garth Sim Balk Lane

Bishopthorpe, York, YO23 2UE



- Exceptional Arts and Crafts property constructed in 1908
- Spectacular location close to York city centre
- Two additional cottages, car park and 20 acre field available separately
- Circa 4 acres of beautifully maintained gardens
- Five bedrooms with additional annex cottage and apartment
- Detached oak framed barn/garage with potential for conversion
- Cinema room and tennis court

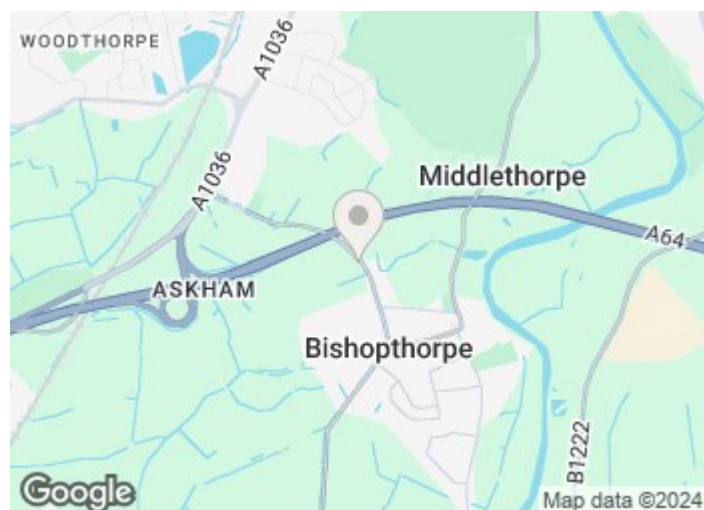

Directions



Floor Plan

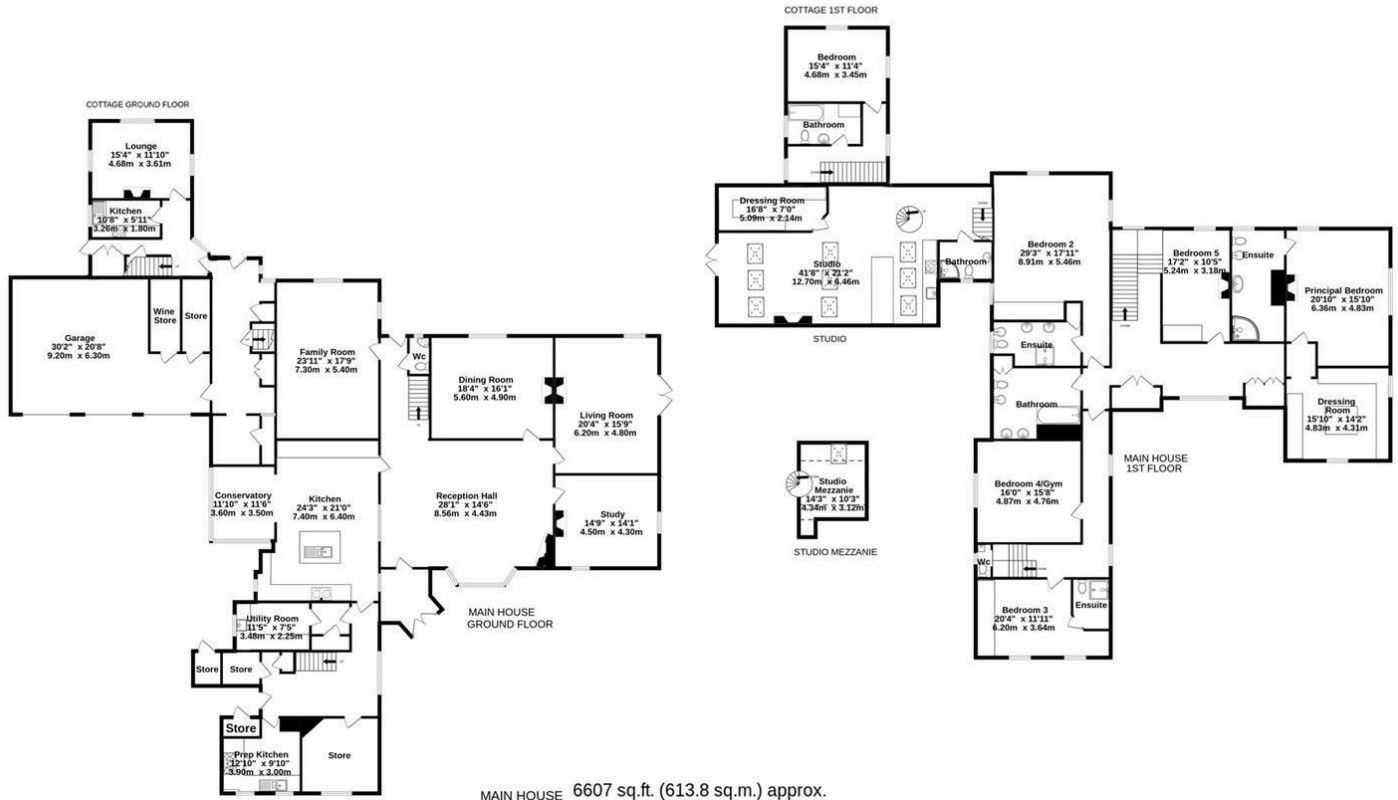

MAIN HOUSE 6607 sq.ft. (613.8 sq.m.) approx.

STUDIO 943 sq.ft. (87.6 sq.m.) approx.

COTTAGE 733 sq.ft. (68.1 sq.m.) approx.

TOTAL FLOOR AREA : 8283 sq.ft. (769.6 sq.m.) approx.

Whilst every attempt has been made to ensure the accuracy of the floorplan contained here, measurements of doors, windows, rooms and any other items are approximate and no responsibility is taken for any error, omission or mis-statement. This plan is for illustrative purposes only and should be used as such by any prospective purchaser. The services, systems and appliances shown have not been tested and no guarantee as to their operability or efficiency can be given.
Made with Metropix ©2024



These particulars, whilst believed to be accurate are set out as a general outline only for guidance and do not constitute any part of an offer or contract. Intending purchasers should not rely on them as statements of representation of fact, but must satisfy themselves by inspection or otherwise as to their accuracy. No person in this firm's employment has the authority to make or give any representation or warranty in respect of the property.