

NAISH

ESTATE AGENTS



YORK  
EST. 1939



## Olympian Court

, York, YO10 3UP

£1,100 PCM



2



1



1



B



# Olympian Court



## Description

An impressive two-bedroom apartment available now in a popular private development set back from Lawrence Street.

- Two-bedroom apartment
- Allocated parking space
- Secure bike storage
- Popular residential area
- Bright & modern interior
- Students & working professionals welcome







## Floor Plan

GROUND FLOOR  
623 sq.ft. (57.8 sq.m.) approx.

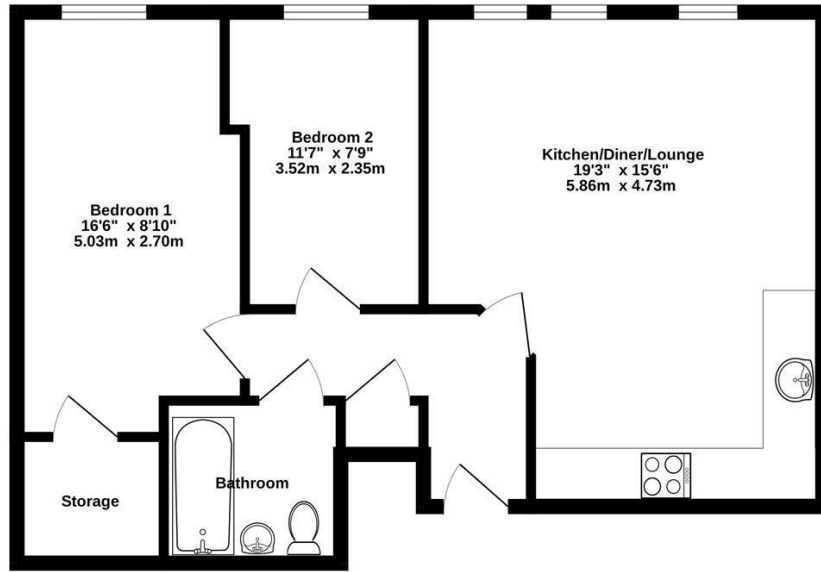

TOTAL FLOOR AREA: 623 sq.ft. (57.8 sq.m.) approx.

Whilst every attempt has been made to ensure the accuracy of the floorplan contained here, measurements of doors, windows, rooms and any other items are approximate and no responsibility is taken for any error, omission or mis-statement. This plan is for illustrative purposes only and should be used as such by any prospective purchaser. The services, systems and appliances shown have not been tested and no guarantee as to their operability or efficiency can be given.  
Made with Metosox, ©2024



## Area Map

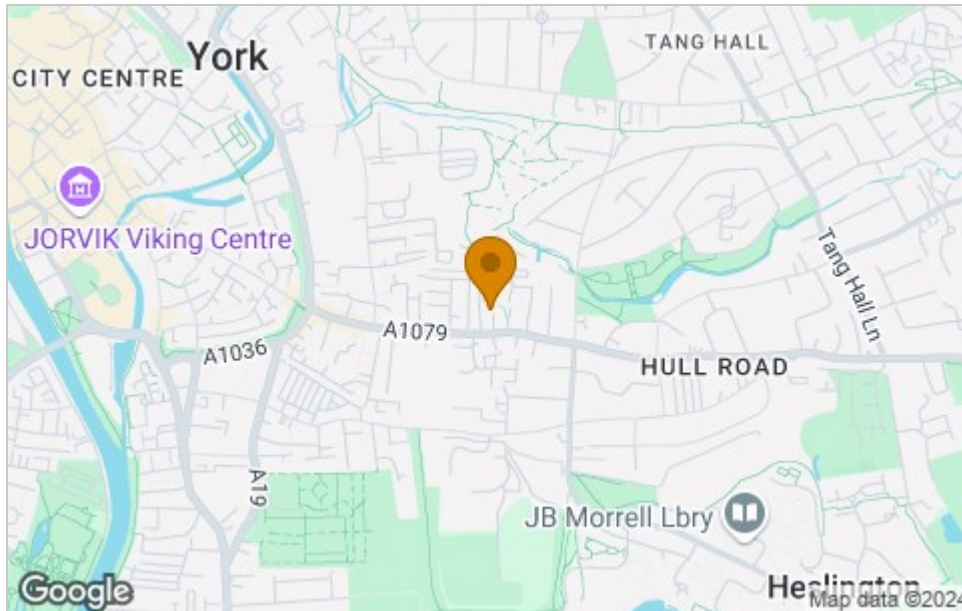

## Energy Efficiency Graph

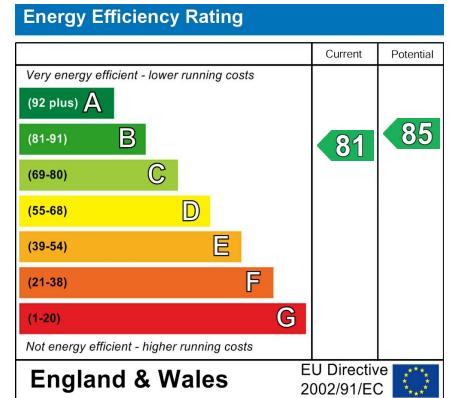

## Viewing

Please contact our Naish Estate Agents Office on 01904 653564 if you wish to arrange a viewing appointment for this property or require further information.

These particulars, whilst believed to be accurate are set out as a general outline only for guidance and do not constitute any part of an offer or contract. Intending purchasers should not rely on them as statements of representation of fact, but must satisfy themselves by inspection or otherwise as to their accuracy. No person in this firm's employment has the authority to make or give any representation or warranty in respect of the property.