



Harvesters Way,
MAIDSTONE ME14 5SJ
Offers Over £260,000

COLES
TOWN & COUNTRY
VALUERS · LETTINGS & ESTATE AGENTS

A nicely presented 2 bedroom terraced house in the popular area of Grove Green on the outskirts of Maidstone. The property has the benefit of a rear garden and 2 allocated parking spaces. A more detailed description is as follows:

Internally:

Lounge/diner with doors to garden.

Kitchen with integrated hob, oven and extractor hood, space for washing machine and fridge freezer.

2 bedrooms (one double, one large single)

Bathroom comprising bath, shower over bath, wash basin and wc.

Externally:

Small front garden.

Enclosed rear garden.

Parking for 2 cars (one in front of property and one to rear within the row of 4 spaces)

Additional Information:

Council Tax Band C.

Part double glazed.

Gas central heating.







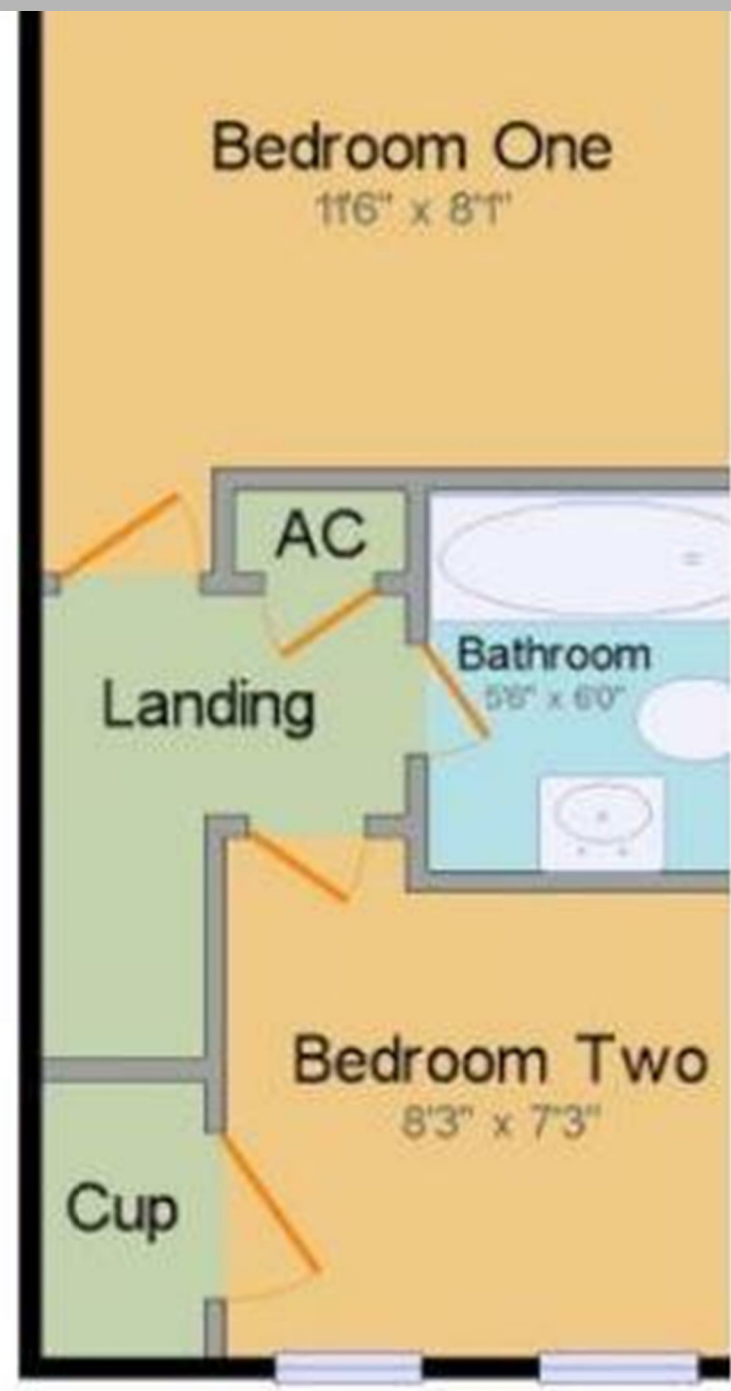
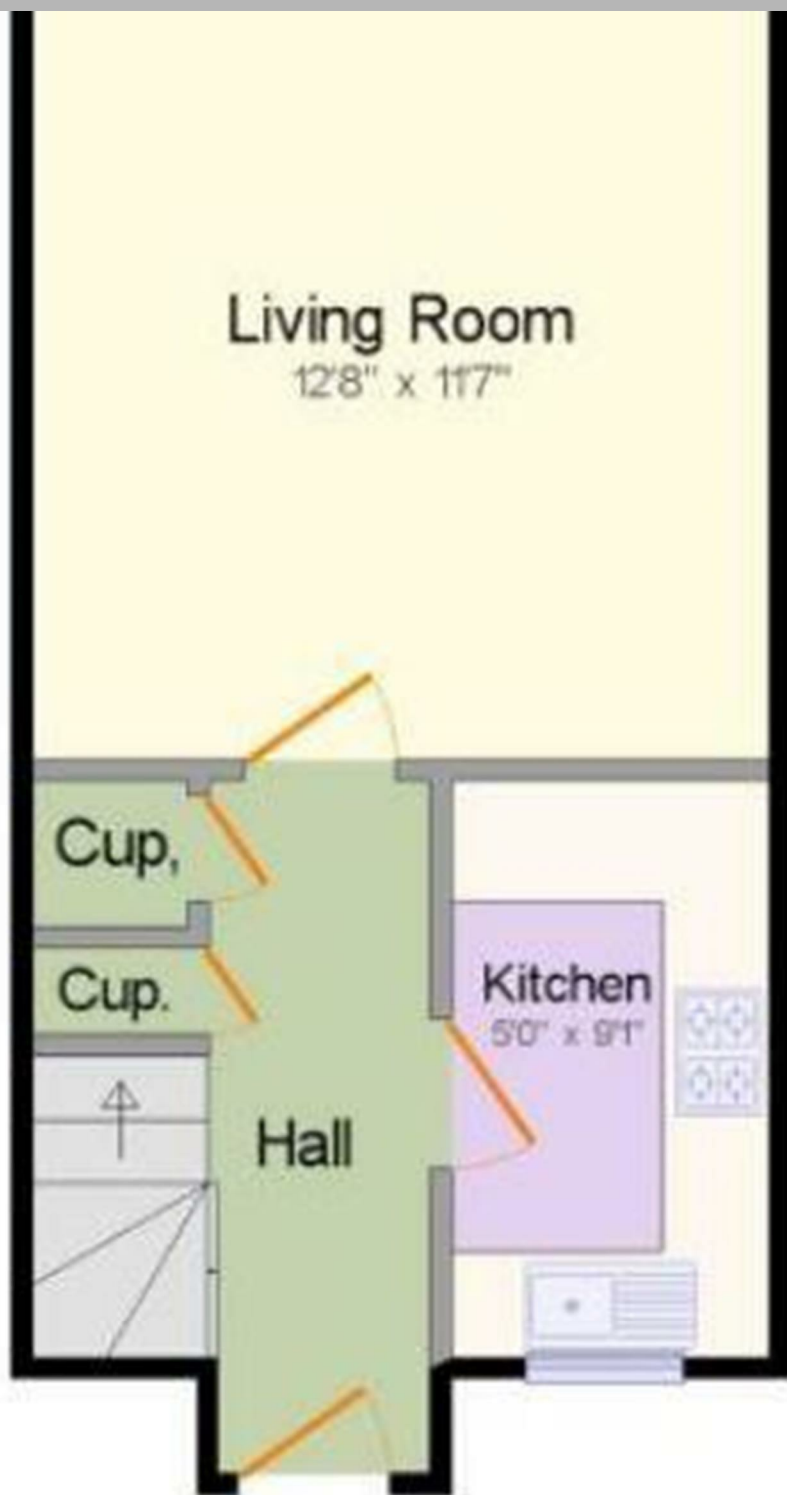

1st Floor

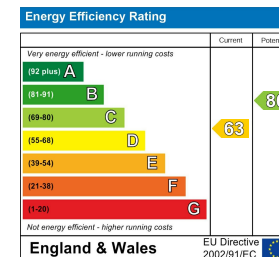

The Estate Office, Roundoak, Heniker Lane, Sutton Valence, Kent, ME17 3ED
 01622 763322
 enquiries@thecolesgroup.co.uk

COLES

TOWN & COUNTRY

VALUERS · LETTINGS · & ESTATE AGENTS

Location Map

