



RESIDENTIAL



Apartment 37 Westbury Fold

Elland, Halifax, HX5 9AL

£675 PCM





Summary:

An attractively presented two bedroom apartment located within this modern contemporary complex convenient for Elland centre. Situated on the third floor (lift access available) the property benefits from alarm system, gas central heating, integrated fridge/freezer and washer/dryer, Juliette balcony, and communal car parking area. Briefly comprising entrance hall, lounge/kitchen, two bedrooms and bathroom with three piece white suite to include over bath shower.

Location:

An attractively presented two bedroom third floor apartment located in the centre of Elland. The property is conveniently situated for a wide range of local amenities offered within West Vale and Elland including shops, bars, restaurants, and supermarkets. Being only a short distance from Halifax, Huddersfield, and Brighouse and benefitting from excellent commuter links along access to the M62 motorway network nearby.

Accommodation:

The property briefly comprises sizable open plan lounge/kitchen benefiting from having a Juliette balcony to the rear, integral refrigerator/integral freezer, washer/dryer, and oven/hob. Two double bedrooms, bathroom having three piece white suite to include low flush WC, sink pedestal and bath with over bath shower. With secure entrance with fob access and lift access, the apartment also benefits from a communal car park available to residents.

Council tax band: B
 EPC rating: C
 Deposit: £778

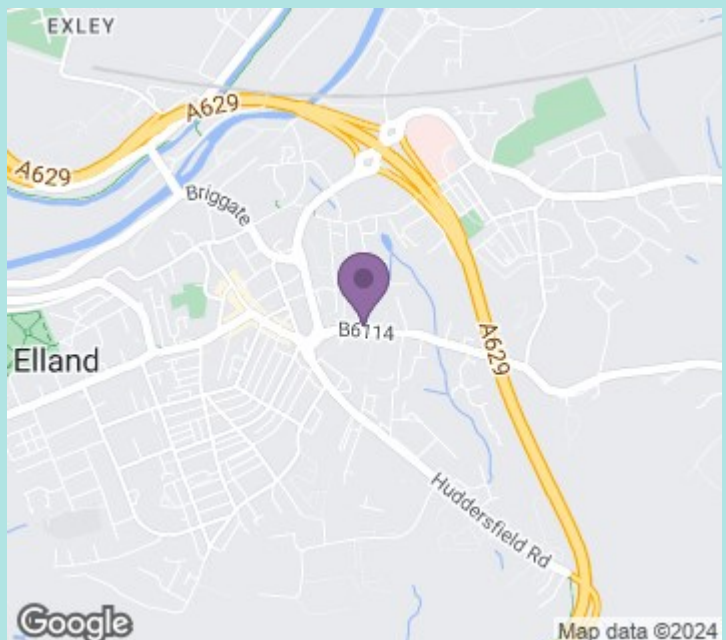
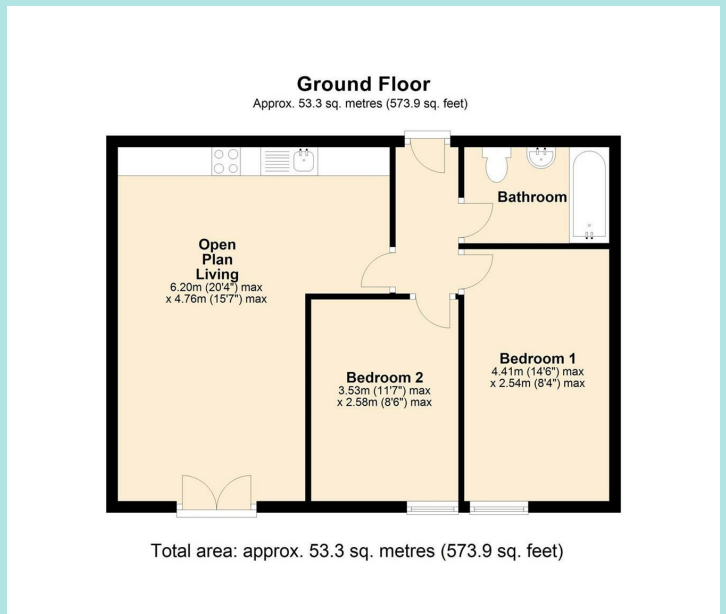

ws-residential.co.uk

01484 711200



These particulars, whilst believed to be accurate are set out as a general outline only for guidance and do not constitute any part of an offer or contract. Intending purchasers should not rely on them as statements of representation of fact, but must satisfy themselves by inspection or otherwise as to their accuracy. No person in this firm's employment has the authority to make or give any representation or warranty in respect of the property.