



9 Dorian Close

Eccleshill, Bradford, BD10 8BQ

£575 PCM





Of special interest to a single person or couple, this 1 bedroom back to back forming part of a quad block provides well planned and easily maintainable accommodation over 2 floors. Ideally situated for local amenities and commuter links to Bradford City Centre this property is not to be missed.

Accommodation

This compact house is ideal for a single occupier, briefly comprising; lounge with neutral decor and carpet, kitchen with range of wall and base units, first floor bedroom with built in wardrobe space and bathroom including WC, sink and bath. The property also has an enclosed lawned garden.

Location

Situated in the locality of Eccleshill benefitting from amenities including a leisure centre, with excellent access routes allowing Leeds Bradford Airport to be reached in approximately 15 minutes.

Ground Floor

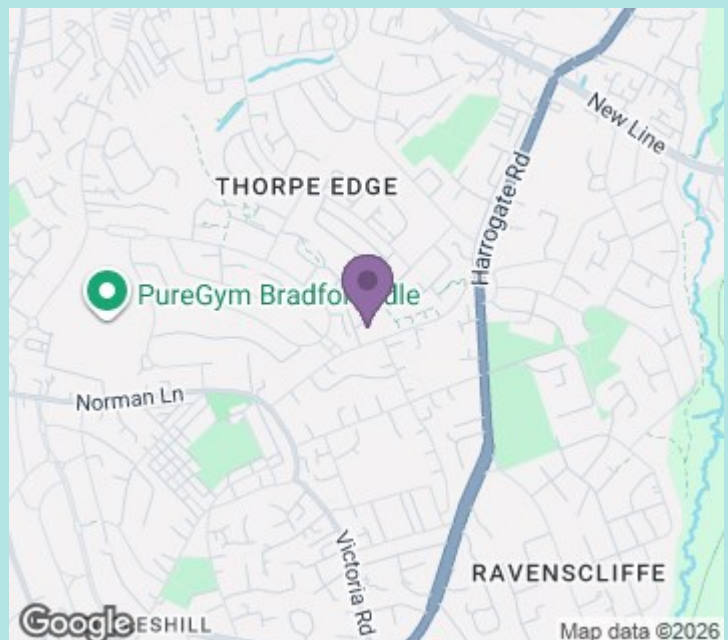
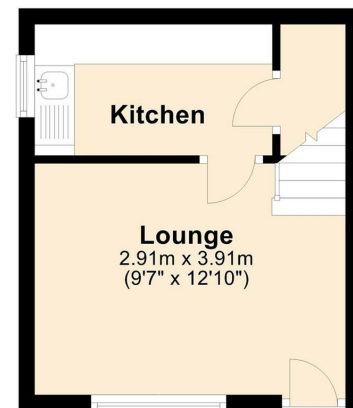

Council tax band: A
EPC rating: C
Deposit: £663

ws-residential.co.uk

01484 711200



These particulars, whilst believed to be accurate are set out as a general outline only for guidance and do not constitute any part of an offer or contract. Intending purchasers should not rely on them as statements of representation of fact, but must satisfy themselves by inspection or otherwise as to their accuracy. No person in this firm's employment has the authority to make or give any representation or warranty in respect of the property.