



100 Saddleworth Road

Greetland, HX4 8BA

£650 PCM





This one bedroom end terraced property provides deceptively spacious unfurnished accommodation set across three floors. Quirky shaped rooms, timber ceiling beams & exposed brickwork add to the character of this unique property. Having recently been refurbished to include a newly fitted kitchen & bathroom improvements, the property is ready to move in & an early viewing is recommended.

Accommodation

The front entrance door opens into an entrance lobby which leads through the lounge. The lounge has a gas fire housed on a painted brick fireplace which extends to display shelving. A window to the rear enjoys views over the cricket ground. A staircase leads up to the landing which has a cupboard housing the central heating boiler, doors open into the bedroom & bathroom with partial wet walling, a three piece suite comprising low flush wc, pedestal wash basin, panelled bath with mixer tap & shower attachment. The kitchen is situated on the lower floor accessed by a staircase from the entrance lobby. The kitchen is fitted with wall, drawer & base units, electric oven & hob. Partially tiled walls incorporate a decorative arch fireplace & island providing extra worktop space. Off the kitchen is a cellar with plumbing facility for a washing machine. Externally there is a shared courtyard space accessed through a door from the kitchen.

Location

In the heart of West Vale, this property gives easy access to a range of amenities to include shops, bars and restaurants. The property is located next to the Greetland Cricket & Bowling Club for recreational activities. Good commuter links with easy access to the M62 network as well as public transport routes to Halifax and Huddersfield town centres.

Council tax band: A
EPC rating: E
Deposit: £750

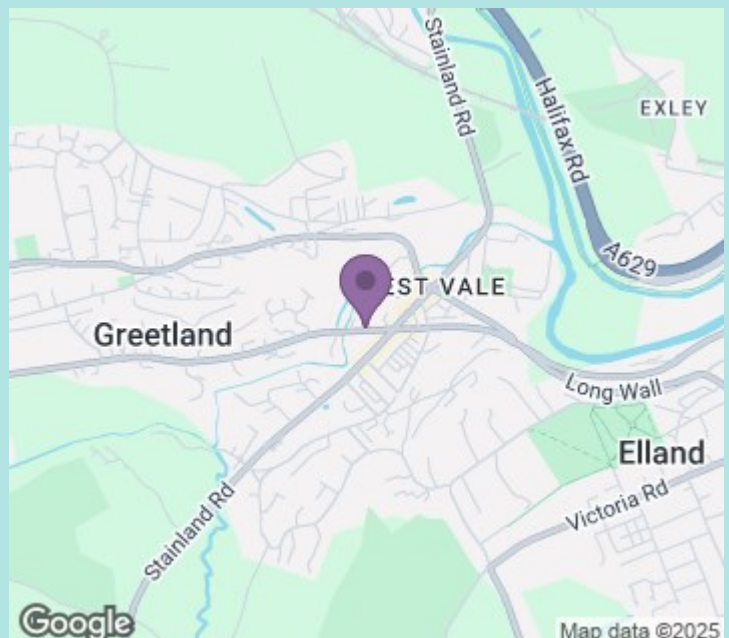
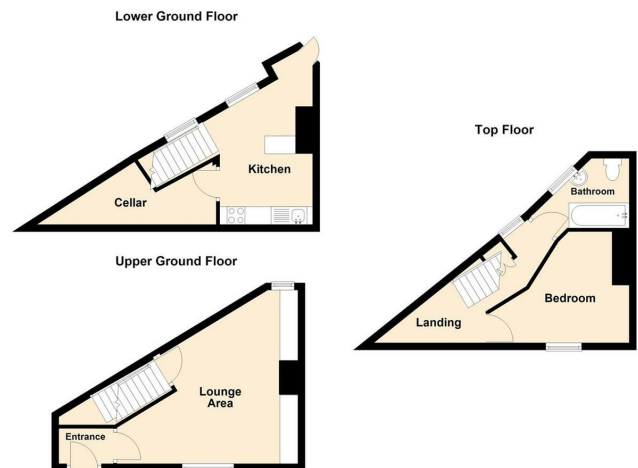

ws-residential.co.uk

01484 711200



These particulars, whilst believed to be accurate are set out as a general outline only for guidance and do not constitute any part of an offer or contract. Intending purchasers should not rely on them as statements of representation of fact, but must satisfy themselves by inspection or otherwise as to their accuracy. No person in this firm's employment has the authority to make or give any representation or warranty in respect of the property.