

# HUNTERS®

HERE TO GET *you* THERE

5 Brierley Lane, Bilston, West Midlands, WV14 8TU

Offers In The Region Of £425,000

Property Images



# HUNTERS®

HERE TO GET *you* THERE

## Property Images



# HUNTERS®

HERE TO GET *you* THERE

## Property Images

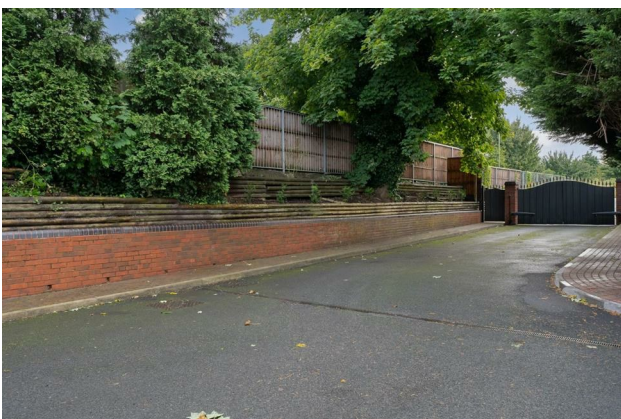

# HUNTERS®

HERE TO GET *you* THERE

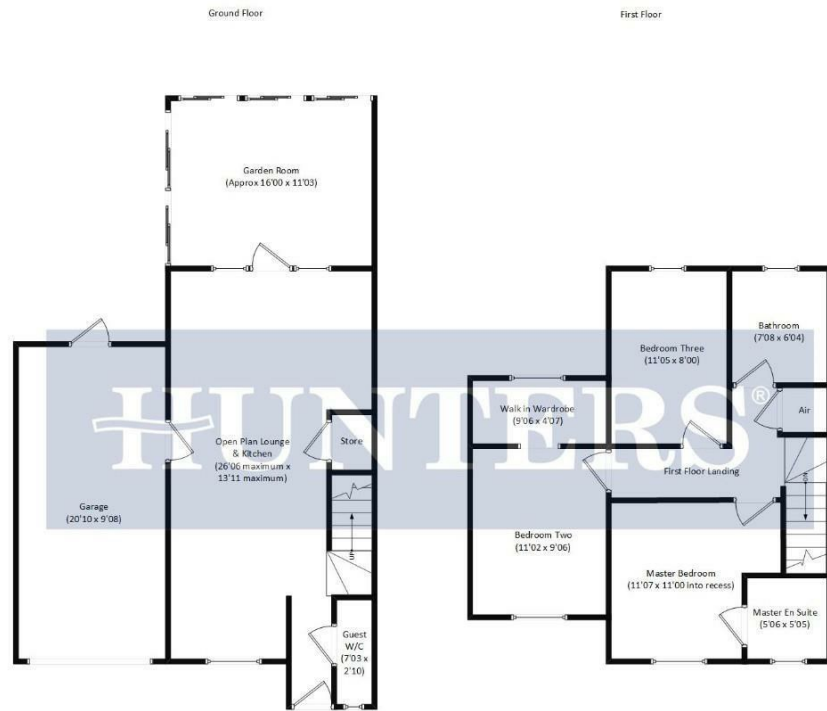

This floorplan is for illustrative purposes only and all measurements are approximate and not drawn to scale.

## EPC

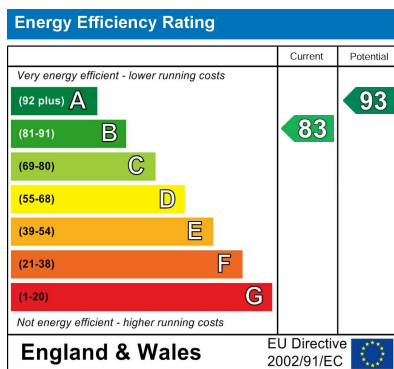

## Map

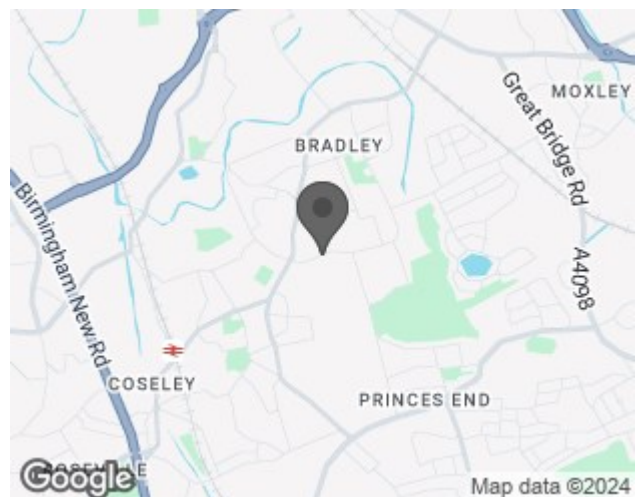

## Details

Type: House - Detached Beds: 3 Bathrooms: 2 Receptions: 1 Tenure: Freehold

## Summary

Hunters are pleased to offer this executive detached home, being sold fully furnished. Situated within a gated community in a popular Bilston neighbourhood, located to nearby amenities and Coseley Rail Station offering regular routes into Wolverhampton & Birmingham city centres.

Beautifully presented throughout, this family home benefits from open plan living accommodation on the ground floor with a high gloss fitted kitchen boasting integrated appliances, a dining space and lounge with feature media wall adorned in panelling.

To the rear is an attractive garden room which can be wholly open with the surround fitting of sliding glass doors and electric roof. A seating area with central firepit is accompanied by a jacuzzi hot tub making this the perfect space to relax on an evening or entertain with friends & family.

A garage with internal access, under stair storage and stylish guest w/c complete the ground floor accommodation.

Upstairs are three good sized bedrooms with the master having a private en-suite and second bedroom having a walk in wardrobe to the rear. Air conditioning is fitted on the first floor landing. Finally an identically designed bathroom to the guest w/c below, benefits from floor to ceiling white marble tiles, a w/c and freestanding bathtub and basin with gold accents.

A truly wonderful family home is complete with generous off road parking and 20ft garage with electric roller door and internal electrics. Entry to the estate is through secure gates with intercom system and front CCTV which can be accessed/ controlled from a smart phone.

A heat pump and air conditioning is installed making warm weather no longer a concern. Meanwhile the gas central heating is controlled through the app 'wiser' giving you full control to operate the heating and temperature from anywhere in the world. To schedule a viewing please call the office and speak with a member of our sales team.

## Features

• DETACHED FAMILY HOME • THREE GOOD SIZED BEDROOMS • EN-SUITE & STYLISH FAMILY BATHROOM • FULLY FURNISHED • BEAUTIUFLLY PRESENTED THROUGHOUT • OPEN PLAN GROUND FLOOR LIVING • GATED COMMUNITY • GARAGE & OFF ROAD PARKING