

HUNTERS®

HERE TO GET *you* THERE

51 Dovedale Road, Ettingshall Park, Wolverhampton, West Midlands, WV4 6RF
Offers In The Region Of £300,000

Property Images



HUNTERS[®]

HERE TO GET *you* THERE

Property Images



Floorplan

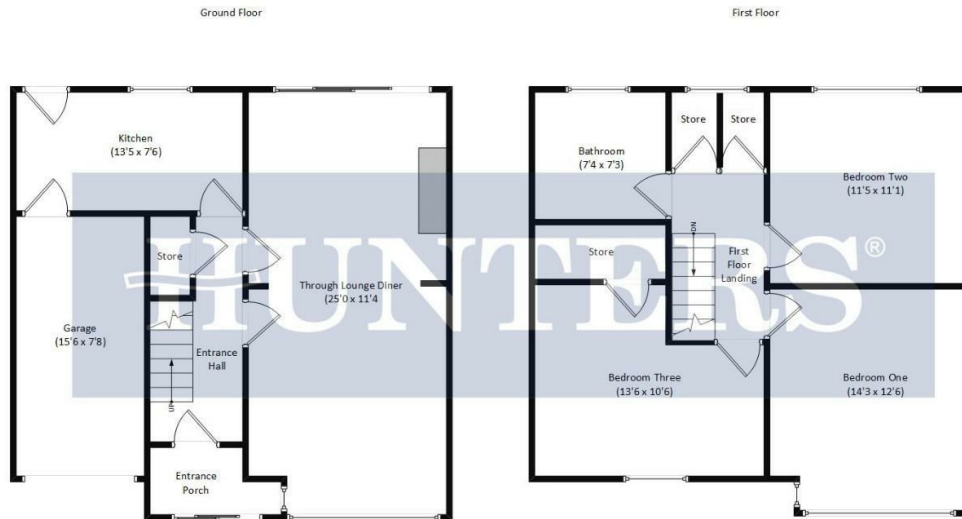

This floorplan is for illustrative purposes only and all measurements are approximate and not drawn to scale.

EPC

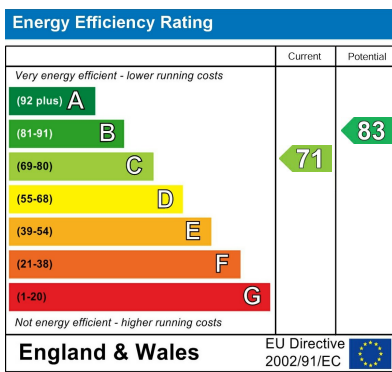

Map

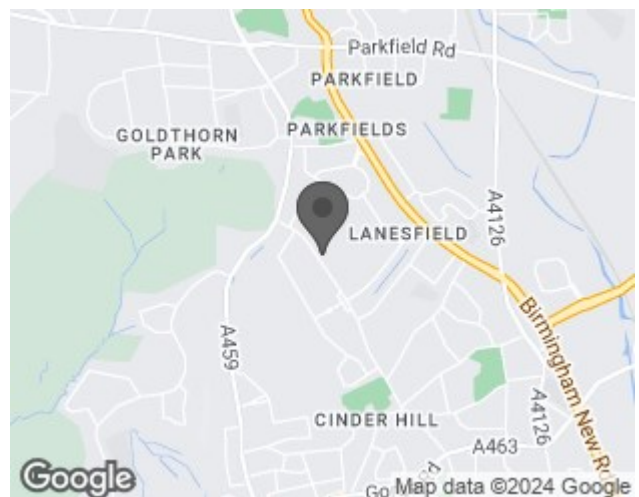

Details

Type: House - Semi-Detached Beds: 3 Bathrooms: 1 Receptions: 1 Tenure: Freehold

Summary

Hunters are delighted to present this spacious semi detached home located on the ever popular Dovedale Road. Positioned nearby to local amenities and schooling whilst also being a short distance from Sedgley.

A beautifully presented family home comprising of an entrance porch leading to the inner hall, a 25ft through lounge with dining space before rear patio doors and a stylish fitted kitchen complete the ground floor accommodation.

Upstairs are three double bedrooms, the master of which has a large bay window adorning the space in natural light and fitted wardrobes. The third has a large store which could be adapted to a walk in wardrobe or children's play area.

Outdoor areas continue to impress with a garage & driveway to the fore and extensive garden to the rear boasting patio and lawn area before reaching the impressive summerhouse with adjoining decking area to provide outdoor seating. The summerhouse itself is fitted with electric and offers flexibility to serve as a home office, gym or entertaining space as per the current owners living arrangements.

Viewing is highly recommended to appreciate the size and internal finish of this wonderful property. To arrange a viewing please call the office.

Features

- SPACIOUS SEMI DETACHED HOME • THREE DOUBLE BEDROOMS • 25FT THROUGH LOUNGE DINER • IDEAL FOR FAMILIES • STYLISHLY FITTED KITCHEN & BATHROOM • GARAGE & OFF ROAD PARKING • IMPRESSIVE SUMMER HOUSE • POPULAR LOCATION