

HUNTERS®

HERE TO GET *you* THERE

59 Coalway Road, Penn, Wolverhampton, West Midlands, WV3 7LY

Offers Over £400,000

Property Images



HUNTERS[®]

HERE TO GET *you* THERE

Property Images



Floorplan

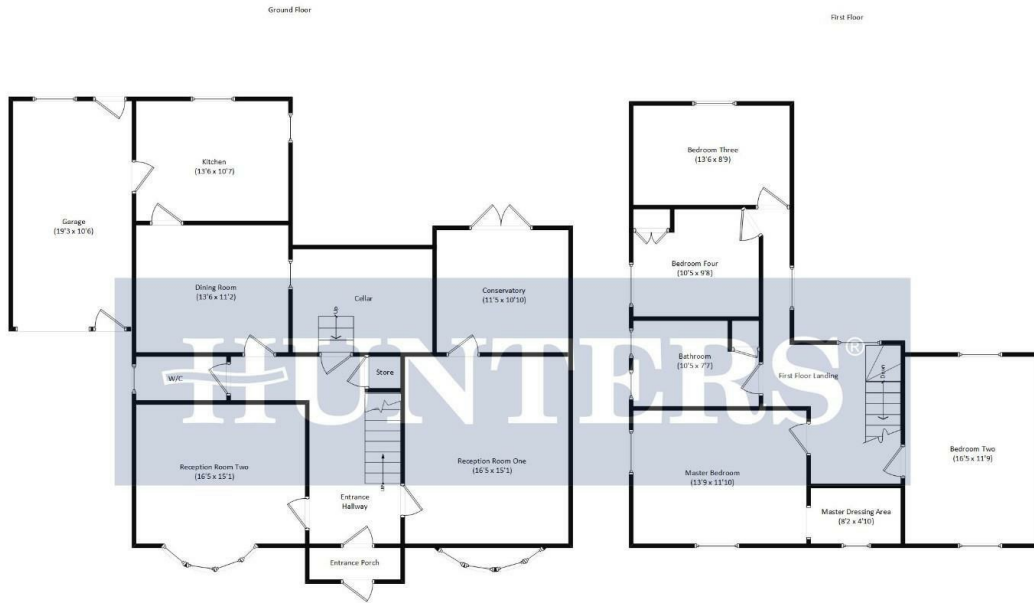

This floorplan is for illustrative purposes only and all measurements are approximate and not drawn to scale.

EPC

Energy Efficiency Rating		Current	Potential
Very energy efficient - lower running costs			
(92 plus) A			82
(81-91) B			
(69-80) C			
(55-68) D		67	
(39-54) E			
(21-38) F			
(1-20) G			
Not energy efficient - higher running costs			
England & Wales		EU Directive 2002/91/EC	

Map

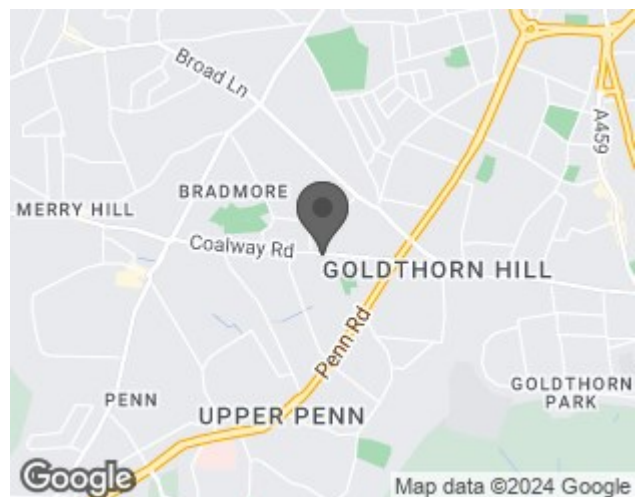

Details

Type: House - Detached Beds: 4 Bathrooms: 1 Receptions: 3 Tenure: Freehold

Summary

Hunters are delighted to present this traditional double fronted home on Coalway Road. Dating back to the 1920's this ideal family abode boasts traditional features throughout whilst offering fantastic potential to modernise the spacious living areas.

Occupying a large plot in a popular Penn location this property offers potential to extend subject to planning permission. Internally the home briefly comprises of a large welcome hallway, three reception rooms, conservatory, cellar, guest w/c and kitchen on the ground floor.

Upstairs benefits of four double bedrooms with a dressing area of the master and family bathroom.

The external gardens are expansive with mature trees, borders and shrubs. Meanwhile there is a large garage and off road parking to the fore.

Features

• DOUBLE FRONTED DETACHED HOME • TRADITIONAL 1920's BUILD • FOUR DOUBLE BEDROOMS • THREE RECEPTION ROOMS • NO UPWARD CHAIN • LARGE PLOT WITH POTENTIAL TO EXTEND STPP • GARAGE & DRIVEWAY • IDEAL FOR FAMILIES • POPULAR LOCATION • PLEASE CALL 01902 672 274 TO SCHEDULE A VIEWING!