

# 184 Market Street

---

EDENFIELD

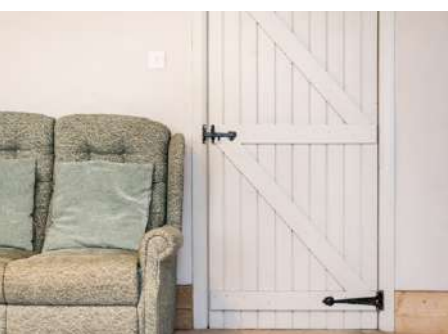

## Welcome

Peacefully settled on the fringe of the popular village of Edenfield, is a charismatically renovated, stone-built home, bursting with character.

Park up outside the end terrace and step inside...

Relax and unwind in the light and inviting living room where two large windows, fitted with blinds, draw the daylight through.

Clad in cream-toned carpet, snuggle up in this cosy room, in front of the atmospheric exposed stone fireplace. Above, traditional beams inset within the ceiling are whitewashed for a fresh, modern feel. Tall, solid wood skirtings reflect the quality design of this home.

Contemporary and classic combine seamlessly in the farmhouse-feel kitchen, located to the rear of the home.

Step through and sense the heritage of the home in the whitewashed, exposed stone walls and slate tiling underfoot.

Inset into the stone inglenook is a Range-style cooker with hob, whilst a traditional Belfast sink is also nestled within the oak worktops. An array of grey cabinets provides plentiful storage. Windows invite light in on two sides.





## And so to bed...

Offering an industrial-style edge, steel balustrades edge the stone stairs, leading up to the first floor.

Originally a three-bedroom home, Number 184 has been modified and enhanced so that two sumptuous bedrooms now provide space and comfort for their residents.

Lavishly-sized and located to the front of the home, the master bedroom spans the full width of the home. Richly-toned wooden flooring gleams underfoot beneath the spotlighting, inset within the whitewashed ceiling. Deep denim tones to the wall are softened by the influx of light through the two wide, front-facing windows, while an exposed stone wall with an inset fireplace to one side adds charm and authenticity.

Sneak a peek at bedroom two to the rear, also fitted with wooden flooring and the added bonus of built in storage. This bedroom also features an original fireplace.

Freshen up in the bathroom, fitted with WC, wash basin with vanity unit storage beneath and bath with overhead shower. Underfoot, wooden flooring extends, balanced by partial tiling to the walls. Pluck your fluffy towel from the heated rail before perfecting your look in the mirror above the sink. Light floods in through the large, frosted window.

On the upper level a boarded loft room, with fitted cupboard units, is great for storage.

Outside, there is a communal yard area to enjoy.



## Total Approx. Floor Area 1488 Sq.ft. (138.1 Sq.M.)

Whilst every effort is made to accurately reproduce these floor plans, measurements are approximate, not to scale and for illustrative purposes only

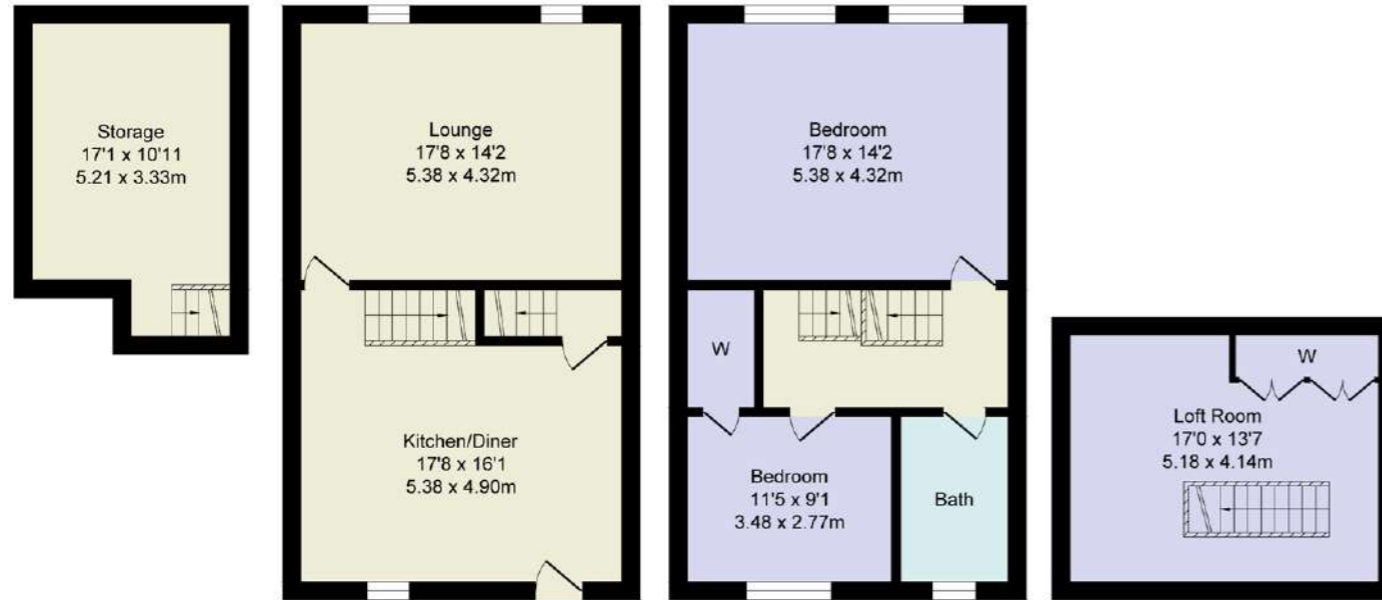

### Basement Level

Approx. Floor Area 171 Sq.Ft (15.9 Sq.M.)

### Ground Floor

Approx. Floor Area 543 Sq.Ft (50.4 Sq.M.)

### First Floor

Approx. Floor Area 543 Sq.Ft (50.4 Sq.M.)

### Loft

Approx. Floor Area 231 Sq.Ft (21.4 Sq.M.)

# 184 Market Street

EDENFIELD

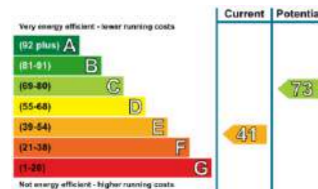

## Out & About

Set amidst countryside and nature, Number 184 is only a brief walk from the shops and amenities of Edenfield village centre.

Outdoor enthusiasts can explore the greenery of Waterfall State Park, or enjoy leisurely strolls along Dearden Brook.

Be sure to stop in at friendly local gastro pub The Coach, which is also dog friendly. Perfect for a refreshing break when walking the pooch.

Surrounded by great schools and restaurants, Number 184, Market Street, is also only a short drive to the motorway and other road links, allowing you to enjoy all the benefits of rural living with the bright lights of the city within easy reach.

Book your viewing for Number 184, Market Street, today to discover its homely charms for yourself.



# 184 Market Street

EDENFIELD

**WAINWRIGHTS**  
ESTATE AGENTS

To view 184 Market Street  
Call 01204 773556  
Email: [sales@wainwrightshomes.com](mailto:sales@wainwrightshomes.com)