



FAREHAM **REACH**

**TO LET**

**5 OFFICE SUITES  
FULLY REFURBISHED/BEING REFURBISHED**



**Suites 100, 110, 120, 125, 130**

**READY FOR OCCUPATION**

**495 sq ft** (46 sq m) - **3,712 sq ft** (345 sq m)



**Features:**

- Accessible location
- Onsite car parking
- Flexible contract terms - subject to status
- Good specification
- Passenger lift
- Air conditioning
- Communal reception & courtyard garden

**Fareham Reach Business Park**  
Fareham Road, Gosport PO13 0FW

[www.farehamreach.co.uk](http://www.farehamreach.co.uk)

 **HELLIER  
LANGSTON**  
**01329 220 111**  
**02382 022 111**  
[www.hlp.co.uk](http://www.hlp.co.uk)

**Lambert  
Smith  
Hampton**

**01489 579579**  
[www.lsh.co.uk](http://www.lsh.co.uk)



# FAREHAM REACH

## 5 Office Suites

### Location

Fareham Reach is an established commercial area situated approximately 1 mile to the south of Fareham Town Centre, midway between Southampton and Portsmouth. There is excellent motorway access onto the M27 at Junction 11.

The offices are located on the south-west corner of the Fareham Reach estate, immediately off the southern junction from Fareham Road.

### Description

All five office suites feature an open plan layout with separate WC facilities. The offices have been, or are in the process of being, comprehensively refurbished to a high standard. The office suites benefit from a communal reception and courtyard garden and there is a newly-opened coffee shop on the corner of the building.



Office Complex.



Communal Courtyard Garden.



Communal Reception.

### Accommodation

The property has been measured on an IPMS 3 basis.

**Suite 100** 495 sq ft (46 sq m)  
Rateable Value: **£7,000**

**Suite 110** 1,827 sq ft (170 sq m)  
Rateable Value: **£25,500**

**Suite 120** 3,712 sq ft (345 sq m)  
Rateable Value: **£51,000**

**Suite 125** 1,012 sq ft (94 sq m)  
Rateable Value: **£14,000**

**Suite 130** 2,468 sq ft (229 sq m)  
Rateable Value: **£33,000**

### Terms

The premises are available on a flexible basis for a term to be agreed.

### Rent

£12.50 per sq ft excluding service charge, utilities, buildings insurance and VAT.

### Energy Performance Certificate (EPC)

The Energy Performance Asset Rating is E110.

### Legal Costs

Each party to be responsible for their own legal costs incurred in any transaction.

### VAT

All prices, premiums and rents, etc. are quoted exclusive of VAT at the prevailing rate.



FAREHAMREACH

5 Office Suites

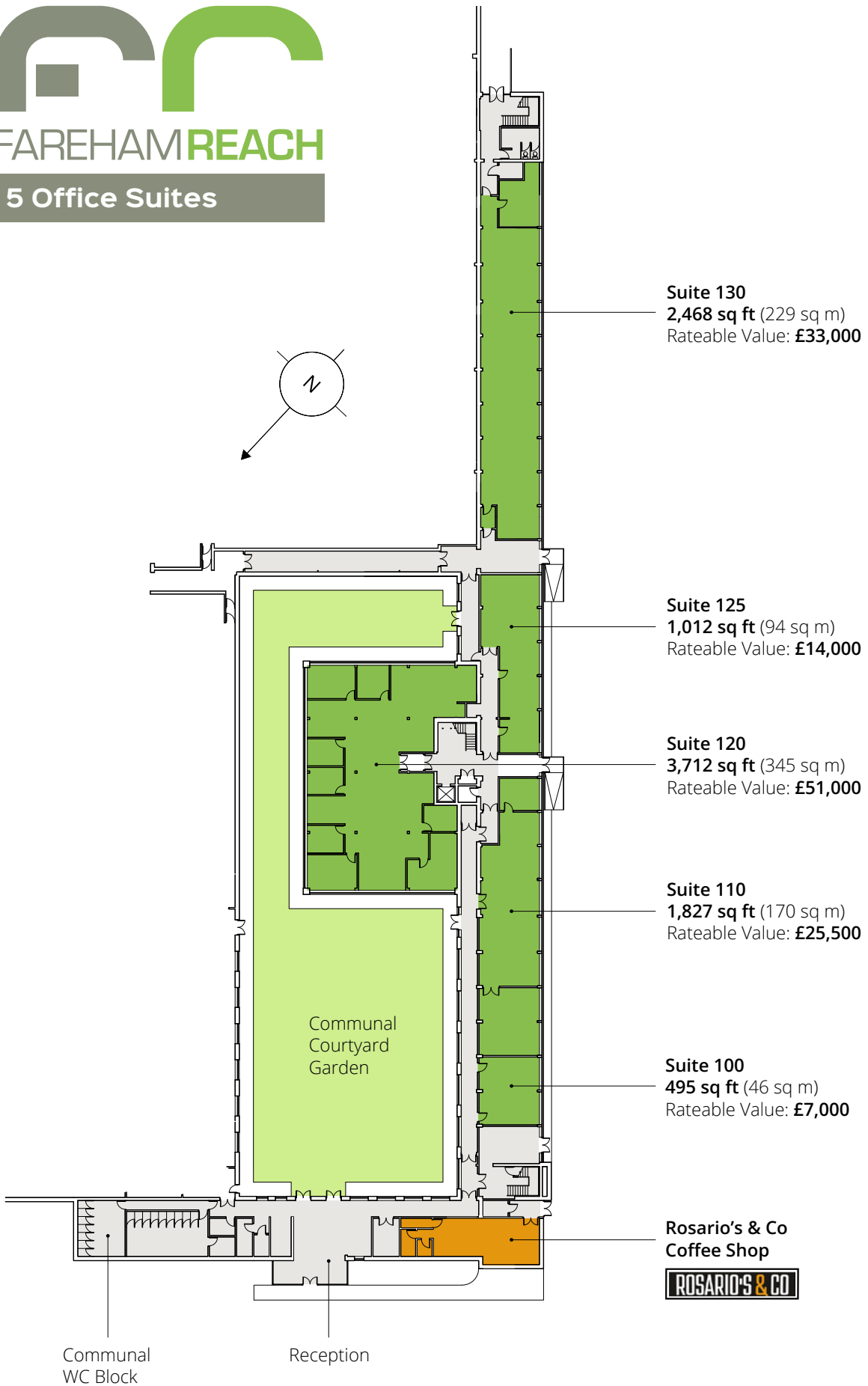



Aerial photograph of Fareham Reach Business Park looking south west.



Ordnance Survey © Crown Copyright 2013. All rights reserved. Licence number 100022432.



# FAREHAM REACH

## Fareham Reach Business Park

Fareham Road, Gosport PO13 0FW

### Towns

Distance from  
Fareham Reach Business Park:

Portsmouth:	10 miles
Southampton:	16 miles
Winchester:	26 miles
Basingstoke:	45 miles
Bournemouth:	48 miles
Brighton:	55 miles
London:	78 miles

### Airports

Distance from  
Fareham Reach Business Park:

Southampton:	16 miles
Bournemouth:	45 miles
Heathrow:	75 miles
Gatwick:	73 miles

### Rail

Journey times from  
Fareham train station:

Southampton:	21 minutes
Portsmouth:	27 minutes
Salisbury:	52 minutes
Bournemouth:	66 minutes
Brighton:	78 minutes
London:	115 minutes

### Ports

Distance to major ports:

Portsmouth:	10 miles
Southampton:	16 miles
Poole:	52 miles

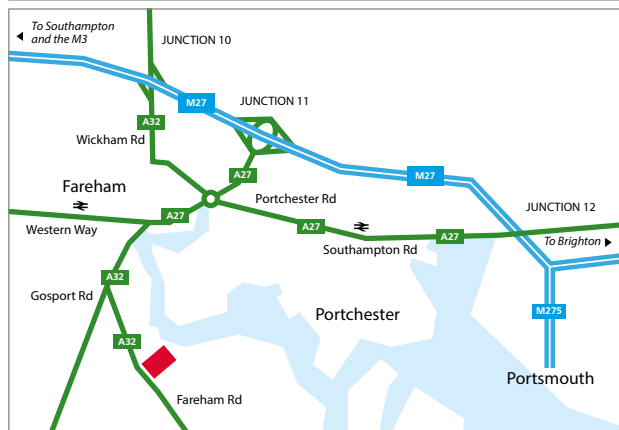

### Viewing

Strictly by appointment through joint sole agents:

#### Matthew Poppett

DDI: 02380 574512

M: 07971 824525

E: [matt@hlp.co.uk](mailto:matt@hlp.co.uk)

#### Andy Hellier

DDI: 01329 225744

M: 07930 661782

E: [andy@hlp.co.uk](mailto:andy@hlp.co.uk)

#### Elise Evans

M: 07703 393120

E: [eevans@lsh.co.uk](mailto:eevans@lsh.co.uk)

#### George Cook

M: 07596 578707

E: [gcook@lsh.co.uk](mailto:gcook@lsh.co.uk)



HELLIER  
LANGSTON

01329 220 111

02382 022 111

[www.hlp.co.uk](http://www.hlp.co.uk)

Lambert  
Smith  
Hampton

01489 579579

[www.lsh.co.uk](http://www.lsh.co.uk)

IMPORTANT NOTICE: Hellier Langston, Lambert Smith Hampton and their clients give notice that: (i) they have no authority to make or give any representations or warranties in relation to the property. These particulars do not form part of any offer or contract and must not be relied upon as statements or representations of fact. (ii) Any areas, measurements or distances are approximate. The text, photographs and plans are for guidance only and are not necessarily comprehensive. It should not be assumed that the property has all necessary planning, building regulation or other consents. Hellier Langston and Lambert Smith Hampton have not tested any services, equipment or facilities. (iii) Purchasers must satisfy themselves by inspection or otherwise.