



Paul Pieri



Pickering Row, Garston Lane  
Monthly Rental Of £570 (Inc utilities)

Wantage,  
Oxfordshire OX12 7DX









- En-suite room to let
- Available immediately, minimum 6 month term
- Rent to include, heat, electric, wi-fi and council tax
- Minimum qualifying income £17,100 per annum
- Holding deposit £131.00
- Tenancy deposit £657.00

## Wantage

Monthly Rental Of £570 (Inc utilities)

En-suite room to let in shared house located a short walk from Wantage market place. The furnished room include bed with new mattress, draw unit and built in wardrobe. The room has it's own en-suite bathroom for private use. Shared facilities within the property include a spacious sitting room, kitchen/dining room, and garden. The is allocated parking available for residents on a first come, first served basis. Available immediately for a minimum six month term.

### Directions:

On foot: Leave Wantage market place via Grove Street. At the far end cross road and proceed into Garston Lane. The property will be found on the right just after the turning for Chapel Court. By Car: From Wantage Market Place, head East on Wallingford Street. Turn right at the mini roundabout and left at the next mini roundabout into Garston Lane. The property will be found on the left had side after the turning for Haywards Close

For more information or to arrange a viewing please contact:

**Wantage**  
3b Newbury Street  
Wantage  
Oxfordshire, OX12 8BU

**Sales**  
Tel 01235 763611  
Email [sales@paulpieri.co.uk](mailto:sales@paulpieri.co.uk)  
Web [www.paulpieri.co.uk](http://www.paulpieri.co.uk)



## First Floor

Approx. 13.7 sq. metres (147.5 sq. feet)

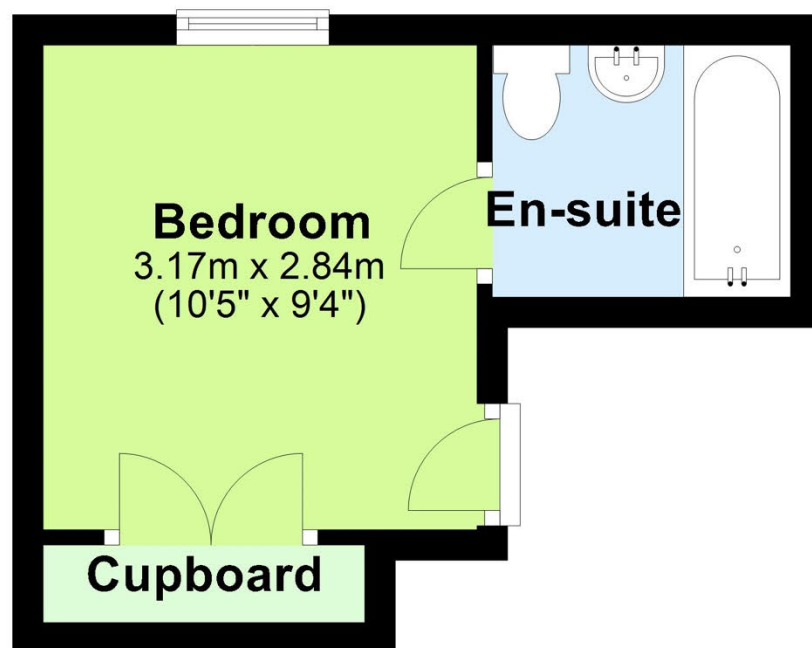

EPC HERE

Total area: approx. 13.7 sq. metres (147.5 sq. feet)

Every attempt has been made to ensure the accuracy of this floor plan. Measurements of doors, windows and rooms are approximate for indicative purposes only. No responsibility is taken for any error, omission, or misstatement. Specifically, no guarantee is given on the total square footage of the property if provided and figures are given for guidance purposes only and must not be relied on as a basis of valuation.

Plan produced using PlanUp.

Paul Pieri Estate Agents Limited. Registered in England and Wales. Registered Number 10485522.  
Registered address Maple Suite, 10-12 High Street, Hungerford, Berkshire, United Kingdom, RG17 0DN.  
Directors: Paul Pieri & Lorna Pieri

For more information or to arrange a viewing please contact:

**Wantage**  
3b Newbury Street  
Wantage  
Oxfordshire, OX12 8BU

**Sales**  
Tel 01235 763611  
Email sales@paulpieri.co.uk  
Web www.paulpieri.co.uk



Whilst every attempt has been made to ensure the accuracy of the floor plans contained here, measurements of doors, windows and rooms are approximate and no responsibility is taken for any error, omission or mis-statement. These plans are for representation purposes only as defined by RICS Code of Measuring Practice and should be used as such by any prospective purchaser. The services, systems and appliances listed in this specification have not been tested by Paul Pieri Estate Agents Limited and no guarantee as to their operating ability or their efficiency can be given.