



Paul Pieri



Grove

£775.00 PCM

Wantage,  
Oxfordshire OX12 0QQ





- LIVING ROOM
- KITCHEN
- TWO BEDROOMS
- BATHROOM
- GARDEN
- GARAGE IN NEARBY BLOCK
- GAS CENTRAL HEATING
- CLOSE TO SHOPS AND OTHER AMENITIES
- AVAILABLE OCTOBER 2020

## Grove

£775.00pcm

Modern two-bedroom terraced house overlooking a green within a short walk of shops, schools, bus stop and walks through the surrounding countryside. LIVING ROOM, KITCHEN, TWO BEDROOMS, BATHROOM, GARDEN, GARAGE IN NEARBY BLOCK, GAS CENTRAL HEATING. Ideal for couple or small family. Qualifying minimum income: £23,250. Holding deposit: £178

### DIRECTIONS:

Take the A338 from Wantage towards Grove. Take the first exit off of the Mably Way (A417) roundabout. Take the third exit at the Aeroplane roundabout onto the Denchworth Road. At the 'T' junction turn left and then the next right, keeping on Newlands Drive. Mallard Way will be found third turning on the right and the property will be at the end facing the green.

For more information or to arrange a viewing please contact:

**Wantage**  
3b Newbury Street  
Wantage  
Oxfordshire, OX12 8BU

**Sales**  
Tel 01235 763611  
Email [sales@paulpieri.co.uk](mailto:sales@paulpieri.co.uk)  
Web [www.paulpieri.co.uk](http://www.paulpieri.co.uk)



### Ground Floor

Approx. 31.4 sq. metres (337.9 sq. feet)

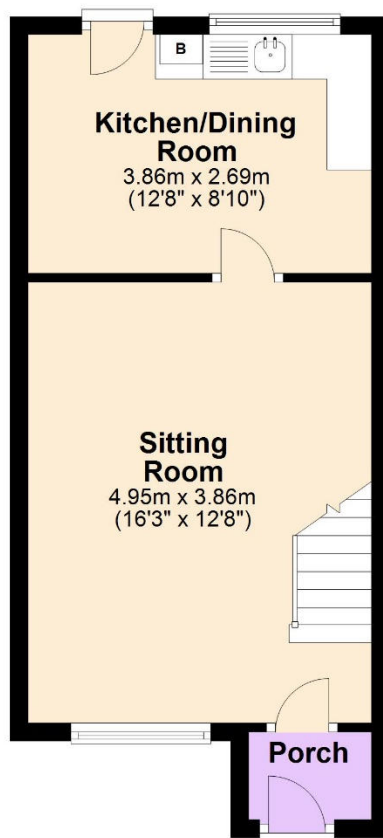

### First Floor

Approx. 29.9 sq. metres (322.1 sq. feet)

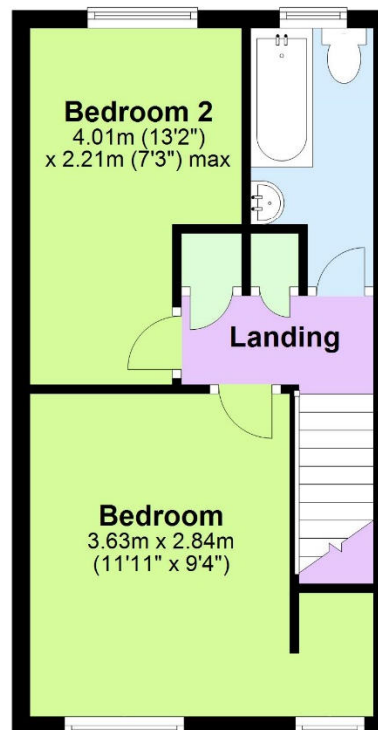

### Garage in block

Approx. 12.2 sq. metres (131.0 sq. feet)

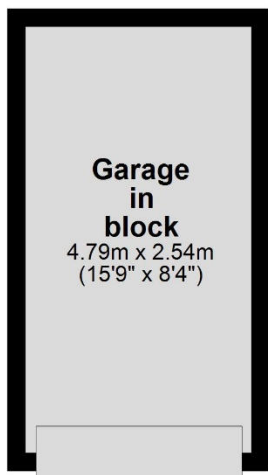

**Total area: approx. 73.5 sq. metres (791.0 sq. feet)**

Every attempt has been made to ensure the accuracy of this floor plan. Measurements of doors, windows and rooms are approximate for indicative purposes only. No responsibility is taken for any error, omission, or misstatement. Specifically, no guarantee is given on the total square footage of the property if provided and figures are given for guidance purposes only and must not be relied on as a basis of valuation. Plan produced using PlanUp.

Paul Pieri Estate Agents Limited. Registered in England and Wales. Registered Number 10485522.  
Registered address Maple Suite, 10-12 High Street, Hungerford, Berkshire, United Kingdom, RG17 0DN.  
Directors: Paul Pieri & Lorna Pieri

For more information or to arrange a viewing please contact:

**Wantage**  
3b Newbury Street  
Wantage  
Oxfordshire, OX12 8BU

**Sales**  
Tel 01235 763611  
Email sales@paulpieri.co.uk  
Web www.paulpieri.co.uk



Whilst every attempt has been made to ensure the accuracy of the floor plans contained here, measurements of doors, windows and rooms are approximate and no responsibility is taken for any error, omission or mis-statement. These plans are for representation purposes only as defined by RICS Code of Measuring Practice and should be used as such by any prospective purchaser. The services, systems and appliances listed in this specification have not been tested by Paul Pieri Estate Agents Limited and no guarantee as to their operating ability or their efficiency can be given.