



Railway View, £215,600

- Easy access to M4 and M48
- TWO Double bedrooms
- Cul-de-sac
- Parking
- Rear access
- EPC Rating: C
- Council Tax: C



2 1 1



About the property

Presenting an immaculate two-bedroom terraced house, offered for sale and ideal for first-time buyers seeking a comfortable and modern home. Situated in a desirable location, this property benefits from excellent public transport links, local amenities, and nearby parks—ensuring convenience and leisure are always within easy reach. The property also provides an easy commute to both the M4 and M48.

Upon entering, you are greeted by a well-appointed reception room, perfect for relaxing or entertaining guests. The adjoining kitchen is thoughtfully designed, providing ample space for culinary pursuits and daily living. Both bedrooms offer comfortable accommodation, ideal for restful nights and personal retreat.

A key highlight is the beautifully maintained private garden, offering a tranquil outdoor space for entertaining, gardening, or unwinding after a busy day. The property also features off-street parking, delivering added convenience and peace of mind.

This home is presented in immaculate condition throughout, showcasing tasteful décor and modern finishes. Its combination of practical features, stylish interiors, and a superb location make it an exceptional opportunity for those starting their property journey.





Accommodation

Living Room

13' 5" Max x 11' 2" Max (4.09m Max x 3.40m Max)

Kitchen

12' 3" x 10' 1" (3.73m x 3.07m)

Bedroom 1

10' x 9' 3" (3.05m x 2.82m)

Bedroom 2

10' 10" x 6' 11" (3.30m x 2.11m)

Floorplan

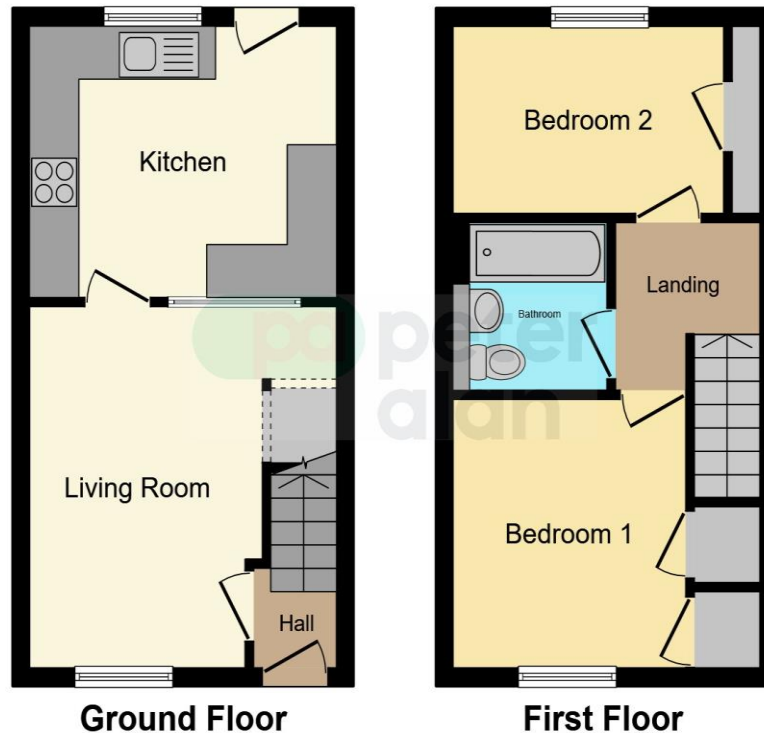

This floor plan is for illustrative purposes only. It is not drawn to scale. Any measurements, floor areas (including any total floor area), openings and orientation are approximate. No details are guaranteed, they cannot be relied upon for any purpose and they do not form part of any agreement. No liability is taken for any error, omission or misstatement. A party must rely upon its own inspection(s). Powered by www.focalagent.com

Important Information

Note while we endeavour to make our sales details accurate and reliable, if there is any point which is of particular interest to you, please contact the office and we will be pleased to confirm the position for you. We have not personally tested any apparatus, equipment, fixtures, fittings or services and cannot verify they are in working order or fit for their purposes. Nothing in these particulars is intended to indicate that carpets or curtains, furnishings or fittings, electrical goods (whether wired or not). Gas fires or light fittings or any other fixtures not expressly included form part of the property offered for sale. This computer generated Floorplan, if applicable, is intended as a general guide to the layout and design of the property. It is not to scale and should not be relied upon for dimensions. Tenure: We cannot confirm the tenure of the property as we have not had access to the legal documents. The buyer is advised to obtain verification from their solicitor or surveyor.

Peter Alan Limited is registered in England and Wales under company number 2073153, Registered Office is Cumbria House, 16-20 Hockliffe Street, Leighton Buzzard, Bedfordshire, LU7 1GN. VAT Registration Number is 500 2481 05. For activities relating to regulated mortgages and non-investment insurance contracts, Peter Alan Limited is an appointed representative of Connells Limited which is authorised and regulated by the Financial Conduct Authority. Connells Limited's Financial Services Register number is 302221. Most buy-to-let