



## Paskin Heights, £240,000

- Highly sought-after location
- Generously proportioned bedrooms
- Council Tax: B
- Parking included
- EPC Rating: B



 2  1  1





## About the property

I am delighted to present to the market this immaculate two-bedroom terraced house for sale. Nestled in a highly sought-after location, this property offers excellent living space, perfect for first time buyers. The property boasts an inviting reception room, providing a welcoming environment for relaxation and entertainment. Additionally, it features a well-equipped kitchen, ideal for all your culinary needs. The house further benefits from two generously proportioned bedrooms, offering plenty of space for comfort and tranquillity. A modern bathroom completes the accommodation, perfectly designed to offer a refreshing space for your daily routines. The house is in an impeccable condition, reflecting the care and attention given to every detail. With an EPC rating of 'B', the property is energy efficient, benefitting from reduced energy costs. It falls under council tax band 'B', providing an affordable charge for local services and amenities. One of the unique features of this property is the inclusion of parking, providing a practical solution to car owners and enhancing the convenience of this residence.

In summary, this is a wonderful opportunity to acquire a beautifully presented terraced house in a desirable location. The property has been maintained to a high standard and offers a fantastic starting point for those stepping onto the property ladder for the first time. I encourage interested parties to arrange a viewing to fully appreciate what this property





# Accommodation

## Lounge

12' 9" x 11' 9" ( 3.89m x 3.58m )

## Kitchen

12' 9" x 11' 3" ( 3.89m x 3.43m )

## Bedroom 1

12' 9" x 9' 3" ( 3.89m x 2.82m )

## Bedroom 2

12' 9" x 7' 5" ( 3.89m x 2.26m )

## Bathroom

6' 4" x 6' 1" ( 1.93m x 1.85m )

## Floorplan

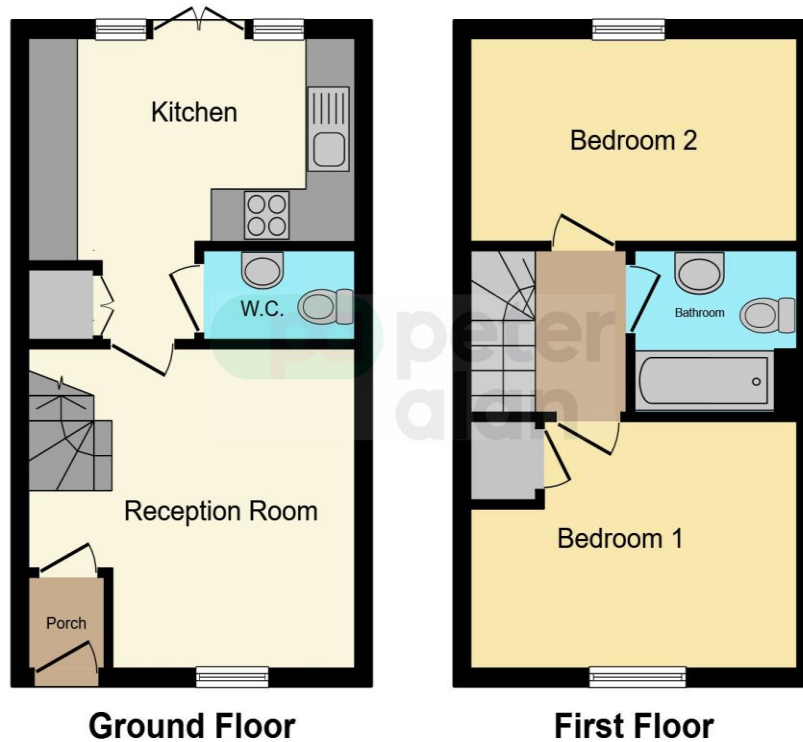

This floor plan is for illustrative purposes only. It is not drawn to scale. Any measurements, floor areas (including any total floor area), openings and orientation are approximate. No details are guaranteed, they cannot be relied upon for any purpose and they do not form part of any agreement. No liability is taken for any error, omission or misstatement. A party must rely upon its own inspection(s). Powered by [www.focalagent.com](http://www.focalagent.com)

## Important Information

Note while we endeavour to make our sales details accurate and reliable, if there is any point which is of particular interest to you, please contact the office and we will be pleased to confirm the position for you. We have not personally tested any apparatus, equipment, fixtures, fittings or services and cannot verify they are in working order or fit for their purposes. Nothing in these particulars is intended to indicate that carpets or curtains, furnishings or fittings, electrical goods (whether wired or not). Gas fires or light fittings or any other fixtures not expressly included form part of the property offered for sale. This computer generated Floorplan, if applicable, is intended as a general guide to the layout and design of the property. It is not to scale and should not be relied upon for dimensions. Tenure: We cannot confirm the tenure of the property as we have not had access to the legal documents. The buyer is advised to obtain verification from their solicitor or surveyor.

Peter Alan Limited is registered in England and Wales under company number 2073153, Registered Office is Cumbria House, 16-20 Hockliffe Street, Leighton Buzzard, Bedfordshire, LU7 1GN. VAT Registration Number is 500 2481 05. For activities relating to regulated mortgages and non-investment insurance contracts, Peter Alan Limited is an appointed representative of Connells Limited which is authorised and regulated by the Financial Conduct Authority. Connells Limited's Financial Services Register number is 302221. Most buy-to-let