

Palmer Crescent
Burton Latimer
NN15 5GP

£112,500 (Fixed Price)



OSCAR JAMES

...expect excellence

FLOOR PLANS

GROUND FLOOR
352 sq.ft. (32.7 sq.m.) approx.

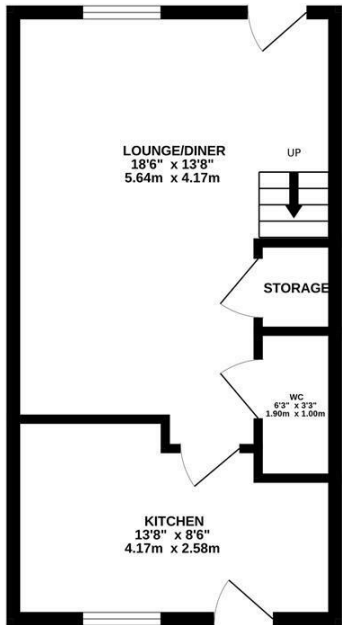

1ST FLOOR
352 sq.ft. (32.7 sq.m.) approx.

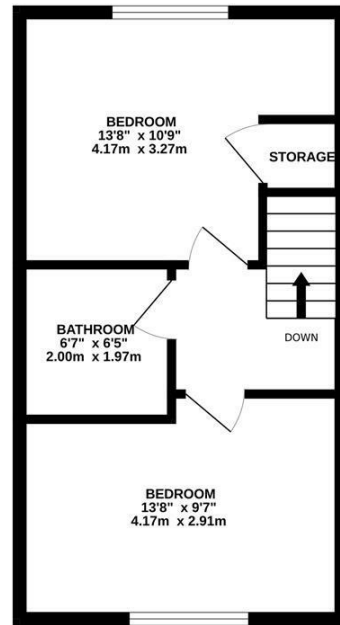

TOTAL FLOOR AREA : 704 sq.ft. (65.4 sq.m.) approx.

Whilst every attempt has been made to ensure the accuracy of the floorplan contained here, measurements of doors, windows, rooms and any other items are approximate and no responsibility is taken for any error, omission or mis-statement. This plan is for illustrative purposes only and should be used as such by any prospective purchaser. The services, systems and appliances shown have not been tested and no guarantee as to their operability or efficiency can be given.

Made with Metropix ©2024



AT A GLANCE...



Lounge Diner



Kitchen with Ample Cupboards and Worktop Space



2 Double Bedrooms



Family Bathroom & W/C



Low Maintenance Garden with High Degree of Privacy



Off Road Parking for 2 Vehicles



WHAT'S GREAT?

**** SHARED OWNERSHIP - 50% SHARE ****

NO ONWARD CHAIN

Nestled in the town of Burton Latimer, this charming 2-bedroom mid-terrace property offers inviting and practical living space. With the added convenience of off-road parking for 2 vehicles, this home is perfect for first-time buyers, small families, or anyone seeking a comfortable and accessible place to call home.

The open-plan lounge diner serves as the central hub of this lovely home, providing a versatile and welcoming space for both relaxation and entertainment. A convenient downstairs W/C adds a touch of practicality to daily living. The kitchen is located at the back of the property, is a delightful space for meal preparation and space for white goods.

Ascending to the first floor, you'll find two spacious double bedrooms, each offering a

peaceful retreat at the end of the day. The family bathroom is well-appointed, featuring modern fixtures.

This 2-bedroom mid-terrace property in Burton Latimer presents a wonderful opportunity. Its welcoming living spaces, practical layout, and accessible location make it a fantastic choice for those seeking their first home or downsizing without compromising on comfort.

The rent on the remaining 50% share is £264.21 per month with the Service charge £36.96 per month. Making this an incredibly affordable option for first-time homeowners.

Act quickly, as shared ownership properties in Burton Latimer are few and far between and always sell incredibly fast.

Contact Oscar James today to arrange your viewing!

...expect excellence



SELLER'S SECRET



Why we like it....

OSCAR JAMES

45 High Street | Burton Latimer | NN15 5LB
01536 722 222
www.oscar-james.com

To buy or not to buy....
