



53 Chichele Street,
Higham Ferrers, NN10 8HT

OSCAR JAMES

Offers Over £180,000

ESTATE AGENTS

The Property in Brief...

This modern, two-bedroom, ground floor apartment is presented to the market in excellent and modern decorative condition, with the added benefit of NO ONWARD CHAIN.

Constructed in 2017 by the award-winning Seagrave Developments, this property boasts a superb specification and is a must-see.

Located in a popular residential area near the vibrant heart of Higham Ferrers town centre and just a short drive from the Rushden Lakes shopping and leisure complex, this property offers excellent road links and convenience.

Inside, the accommodation includes an entrance hall, a spacious open-plan living room and kitchen featuring a range of integrated appliances and granite work surfaces, two double bedrooms and a family bathroom. The master bedroom also benefits from an ensuite bathroom.

Additional features include a car port with electrical points and space for one vehicle. Also, a secure intercom entry system.

Contact Oscar James today for more information and to arrange a viewing!



Dimensions

Lounge/Kitchen/Diner

21'1 x 19'5 (6.43m x 5.92m)

Bedroom 1

14'10 x 11'9 (4.52m x 3.58m)

Ensuite

7'5 x 6'10 (2.26m x 2.08m)

Shower Room

7'5 x 5'4 (2.26m x 1.63m)

Bedroom 2

15'9 x 11'8 (4.80m x 3.56m)

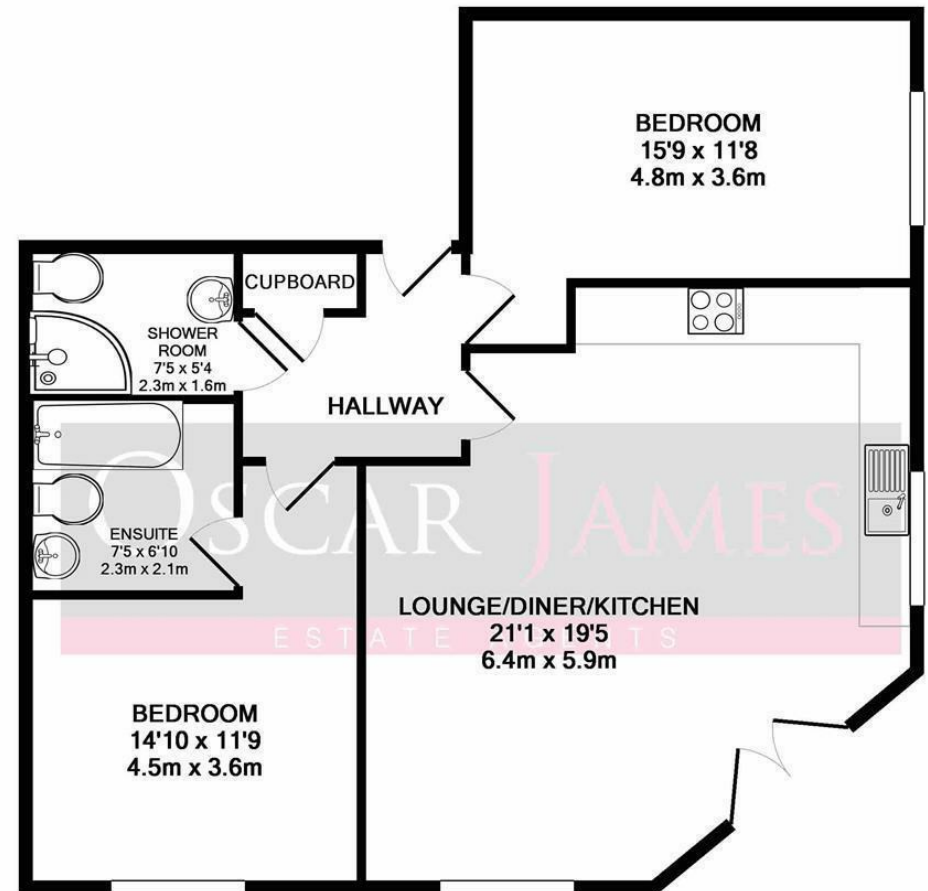

What our vendors say...

TOTAL APPROX. FLOOR AREA 788 SQ.FT. (73.2 SQ.M.)

Whilst every attempt has been made to ensure the accuracy of the floor plan contained here, measurements of doors, windows, rooms and any other items are approximate and no responsibility is taken for any error, omission, or mis-statement. This plan is for illustrative purposes only and should be used as such by any prospective purchaser. The services, systems and appliances shown have not been tested and no guarantee as to their operability or efficiency can be given

Made with Metropix ©2018

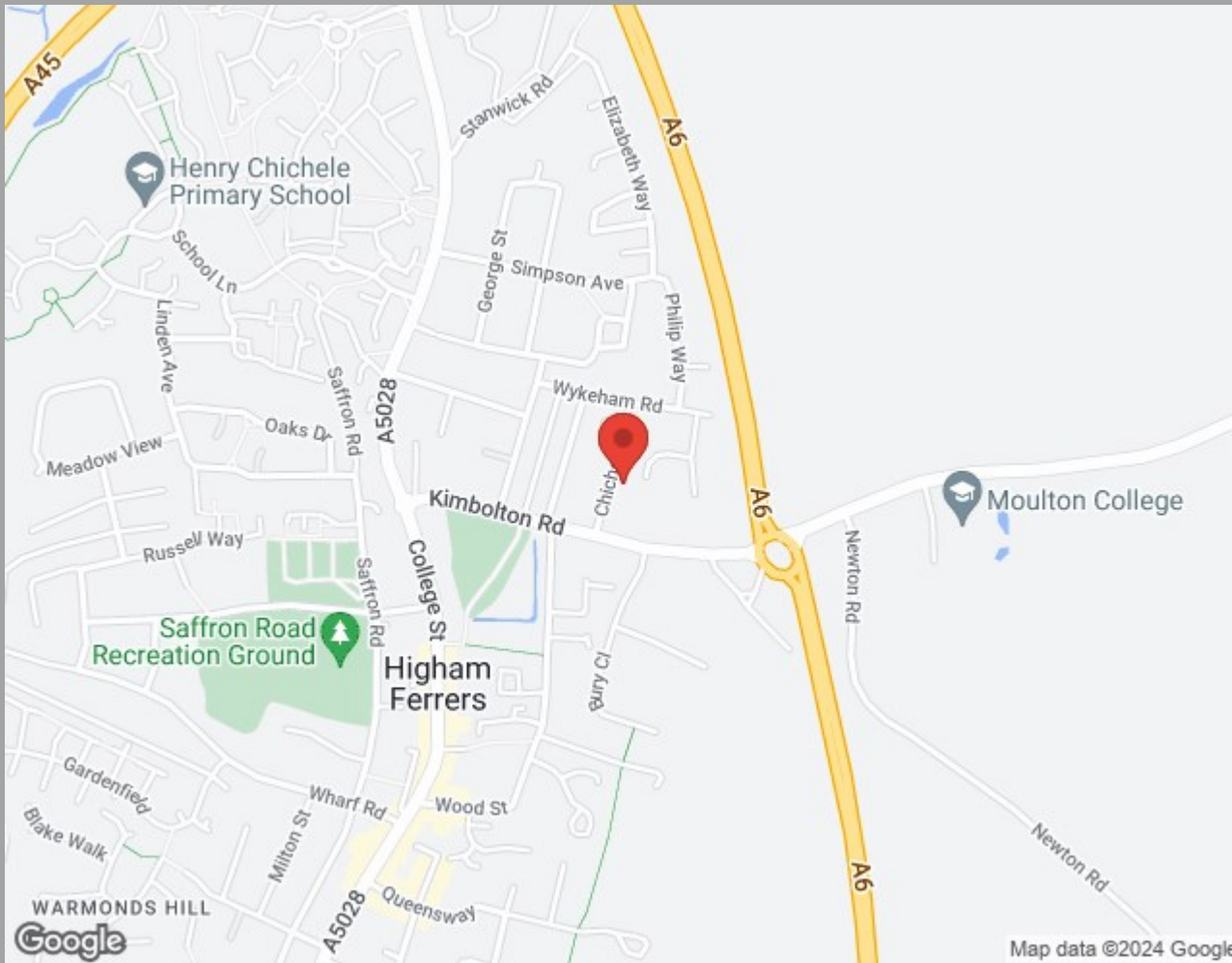

Find us at;
45 High Street
Burton Latimer, NN15 5LB

01536 722 222
burton@oscar-james.com
www.oscar-james.com
Follow us on Facebook

Whilst every attempt has been made to ensure the accuracy of the floor plan and details contained here, measurements of doors, windows, rooms and any other items are approximate and no responsibility is taken for any error, omission, or mis-statement. This plan is for illustrative purposes only and should be used as such by any prospective purchaser. The services, systems and appliances shown have not been tested and have no guarantee as to their operability or efficiency can be given. Floor plan made with Metropix 2014. Fixtures and fittings may vary at point of sale.