



8 Silverstone Road,
Burton Latimer, NN15 5XG

OSCAR JAMES

Offers Over £270,000

ESTATE AGENTS

The Property in Brief...

**** NO CHAIN ****

An exciting opportunity to purchase this exceptionally well presented, three bedroom, detached home situated on a popular modern development on the edge of Burton Latimer.

This lovely home simply must be viewed to be appreciated and offers excellent value for money, as such strong interest is expected so be quick and arrange your internal viewing today!

In brief, the accommodation comprises; entrance hall, lounge opening into spacious kitchen diner with doors leading onto the rear garden. There is also a ground floor WC.

On the first floor expect to find three bedrooms and the family bathroom. The master bedroom also boasts an en-suite shower room.

Outside there is a thoughtfully landscaped rear garden and to the front is a driveway providing off road parking.

For more information or to arrange your internal inspection contact sole selling agents Oscar James today!



Dimensions

Lounge

16' x 9'6" (4.88m x 2.90m)

Kitchen/Diner

16'5" x 12'3" (5.00m x 3.73m)

Bedroom 1

11'6" x 9'8" (3.51m x 2.95m)

Ensuite

6'8" x 4'4" (2.03m x 1.32m)

Bedroom 2

13'8" x 9'8" (4.17m x 2.95m)

Bedroom 3

9'3" x 6'4" (2.82m x 1.93m)

Bathroom

6'11" x 6'5" (2.11m x 1.96m)

What our vendors say...

GROUND FLOOR
413 sq.ft. (38.4 sq.m.) approx.

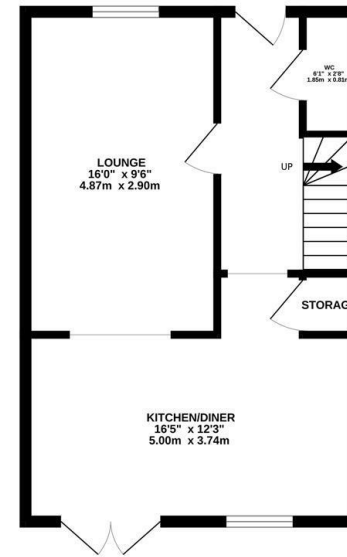

1ST FLOOR
404 sq.ft. (37.6 sq.m.) approx.

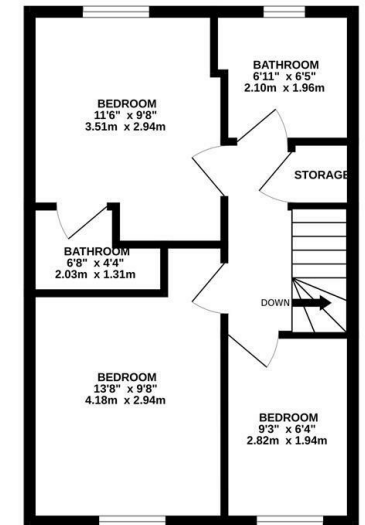

TOTAL FLOOR AREA: 818 sq.ft. (76.0 sq.m.) approx.

Whilst every attempt has been made to ensure the accuracy of the floorplan contained here, measurements of doors, windows, rooms and any other items are approximate and no responsibility is taken for any error, omission or mis-statement. This plan is for illustrative purposes only and should be used as such by any prospective purchaser. The services, systems and appliances shown have not been tested and no guarantee as to their operability or efficiency can be given.

Made with Metropix ©2023

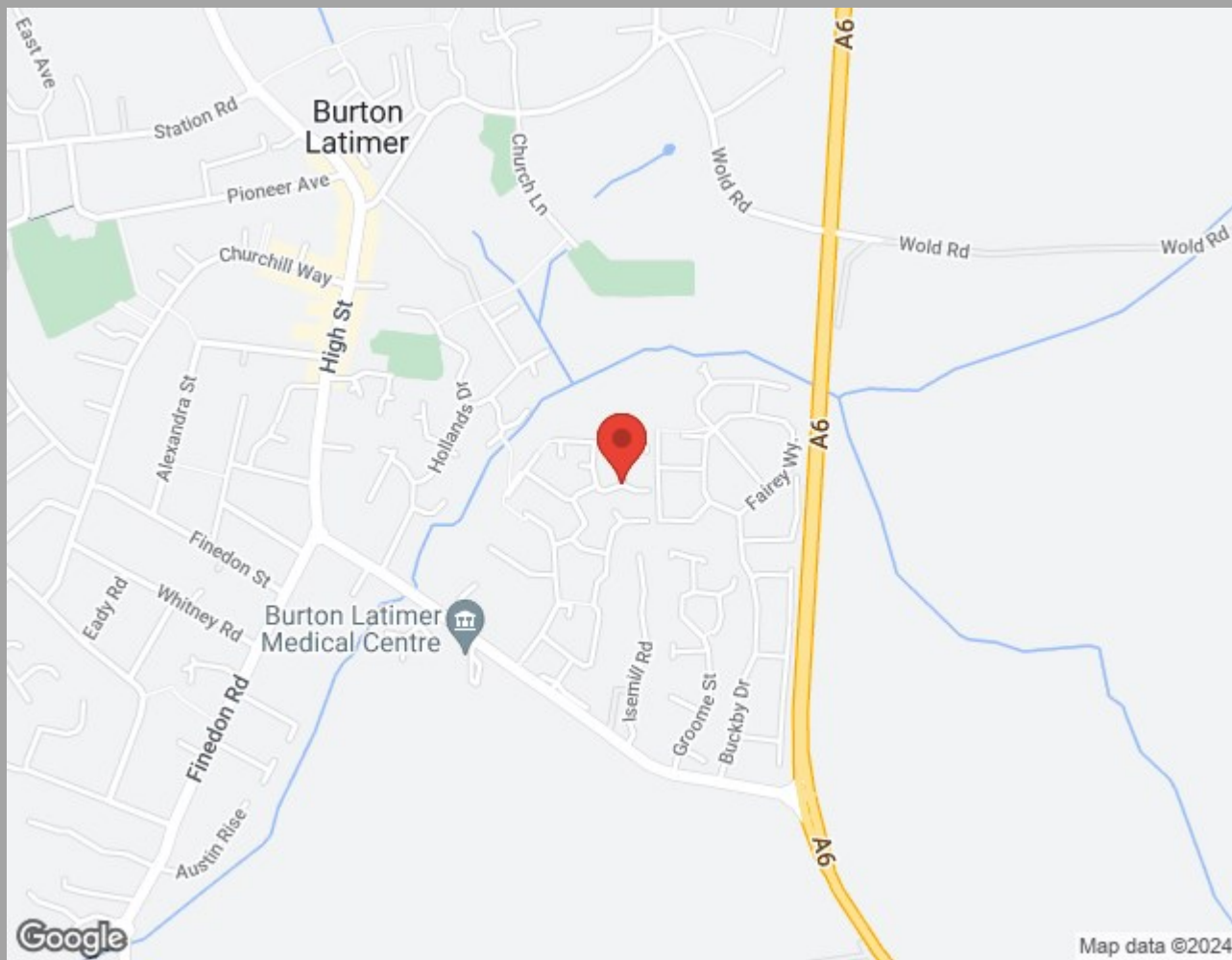

Find us at;
45 High Street
Burton Latimer, NN15 5LB

01536 722 222
burton@oscar-james.com
www.oscar-james.com
Follow us on Facebook

Whilst every attempt has been made to ensure the accuracy of the floor plan and details contained here, measurements of doors, windows, rooms and any other items are approximate and no responsibility is taken for any error, omission, or mis-statement. This plan is for illustrative purposes only and should be used as such by any prospective purchaser. The services, systems and appliances shown have not been tested and have no guarantee as to their operability or efficiency can be given. Floor plan made with Metropix 2014. Fixtures and fittings may vary at point of sale.