

69 Greening Road
Rothwell
NN14 6JB

£220,000



OSCAR JAMES

...expect excellence

FLOOR PLANS

GROUND FLOOR
447 sq.ft. (41.5 sq.m.) approx.

1ST FLOOR
359 sq.ft. (33.3 sq.m.) approx.

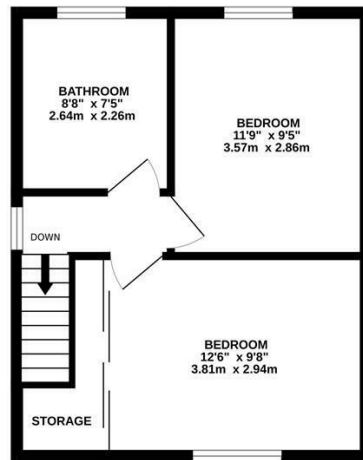
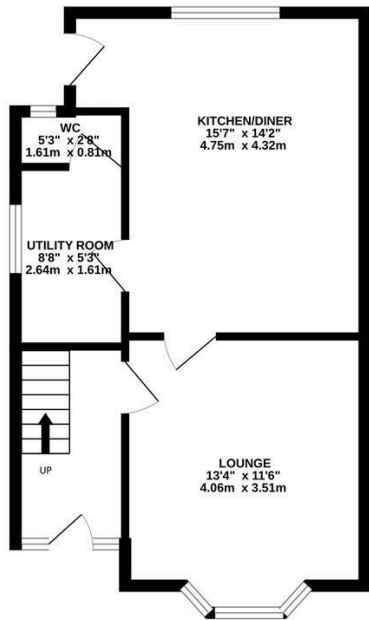

TOTAL FLOOR AREA: 805 sq.ft. (74.8 sq.m.) approx.

Whilst every attempt has been made to ensure the accuracy of the floorplan contained here, measurements of doors, windows, rooms and any other items are approximate and no responsibility is taken for any error, omission or mis-statement. This plan is for illustrative purposes only and should be used as such by any prospective purchaser. The services, systems and appliances shown have not been tested and no guarantee as to their operability or efficiency can be given.

Made with Metropix ©2024



AT A GLANCE...



Lounge



Extended Kitchen/Diner



Two Bedrooms



Family Bathroom



Good Sized Rear Garden



Off Road Parking



WHAT'S GREAT?

Situated in the popular market town of Rothwell is this lovely two bedroomed semi detached home, within walking distance to the local school and shops.

The ground floor accommodation consists of an entrance hall, a cosy lounge room to the front with bay window and feature fireplace, to the rear of the property you have an extended kitchen/diner and utility room, with door leading onto the rear garden.

Upstairs to the first floor both bedrooms are doubles and the family bathroom is an excellent size with bath and shower over.

Outside there is off road parking to the front of two cars, to the back of the property you have a good sized rear garden which is enclosed by timber fencing and a decking area to enjoy the evening sun.

Please call Oscar James to arrange a viewing.

...expect excellence



SELLER'S SECRET

This has been a wonderful family room, I am looking at down sizing.



Why we like it....

A great property in a good location.

To buy or not to buy....

OSCAR JAMES

1 Newland Street | Kettering | NN16 8JH

01536 415777

www.oscar-james.com
