

46 Kylesku Crescent
Kettering
NN15 5BH

£240,000



OSCAR JAMES

...expect excellence

FLOOR PLANS

GROUND FLOOR
358 sq.ft. (33.3 sq.m.) approx.

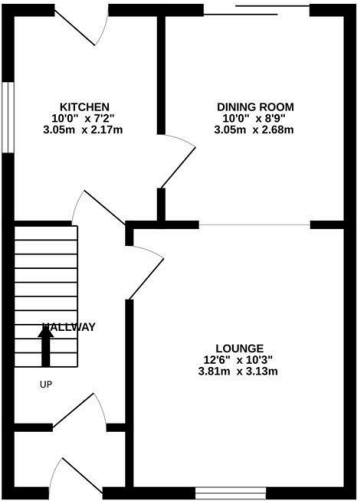

1ST FLOOR
358 sq.ft. (33.3 sq.m.) approx.

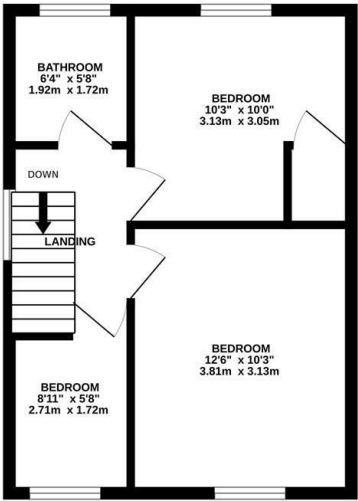

TOTAL FLOOR AREA : 716 sq.ft. (66.5 sq.m.) approx.

Whilst every attempt has been made to ensure the accuracy of the floorplan contained here, measurements of doors, windows, rooms and any other items are approximate and no responsibility is taken for any error, omission or mis-statement. This plan is for illustrative purposes only and should be used as such by any prospective purchaser. The services, systems and appliances shown have not been tested and no guarantee as to their operability or efficiency can be given.
Made with Metropix ©2025



AT A GLANCE...



Lounge



Kitchen



Three Bedrooms



Bathroom



Enclosed Rear Garden



Garage & Off Road Parking



WHAT'S GREAT?

Offered to market with NO ONWARD CHAIN and tucked into a cul de sac within the very popular Ise Lodge estate which is ideal for families and first time buyers alike. The estate itself has plenty of amenities including shops, takeaways, pub and schooling very close by.

The property is a good size, three bedroom semi detached home with a generous lounge leading through to a dining room, kitchen and to the first floor there are three bedrooms and a family bathroom.

Outside there are well maintained gardens front and rear, single garage and off road parking.

Call the sole selling agents Oscar James Kettering to make arrangements to view.

...expect excellence



SELLER'S SECRET

I have owned this property for over 20 years, it is now time for a change, I am looking at moving into rented with the local area



Why we like it....

A great property on a popular estate.

OSCAR JAMES

1 Newland Street | Kettering | NN16 8JH
01536 415777
www.oscar-james.com

To buy or not to buy....
