

6 Rannoch Close
Kettering
NN15 5BS

£200,000 offers in excess of



OSCAR JAMES

...expect excellence

FLOOR PLANS

GROUND FLOOR
343 sq.ft. (31.9 sq.m.) approx.

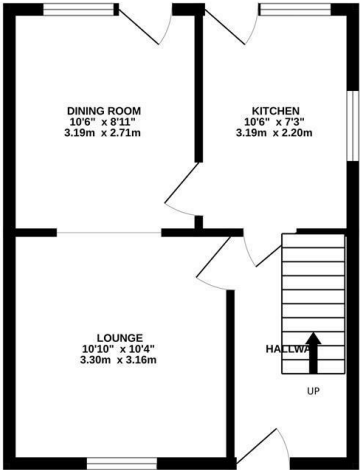

1ST FLOOR
343 sq.ft. (31.9 sq.m.) approx.

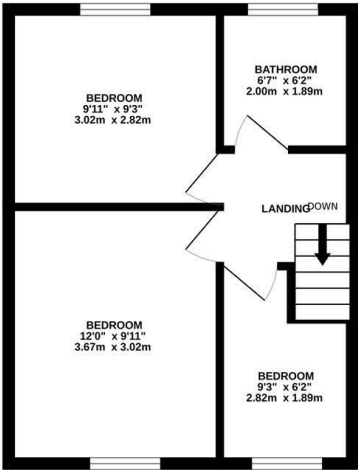

TOTAL FLOOR AREA : 686 sq.ft. (63.7 sq.m.) approx.
Whilst every attempt has been made to ensure the accuracy of the floorplan contained here, measurements of doors, windows, rooms and any other items are approximate and no responsibility is taken for any error, omission or mis-statement. This plan is for illustrative purposes only and should be used as such by any prospective purchaser. The services, systems and appliances shown have not been tested and no guarantee as to their operability or efficiency can be given.
Made with Metropix 11/2025



AT A GLANCE...



Lounge/diner



Kitchen



Three bedrooms



Bathroom



Gardens front and rear



Off road parking



WHAT'S GREAT?

In need of full refurbishment and renovation this three bedroom semi detached home on the Ise Lodge estate Kettering is offered to market with NO ONWARD CHAIN.

Situated within a secluded cul de sac this property has plenty of potential for the right buyer willing to invest and carry out the required works.

Accommodation comprises of an entrance hall, lounge/diner, kitchen, three bedrooms and bathroom.

Outside there are gardens front and rear, parking to side on the driveway for two/three vehicles.

Call sole selling agents Oscar James Kettering to make arrangements to view.

...expect excellence



SELLER'S SECRET

Being sold no chain to hopefully make things straight forward for the buyer. The property will be sold as seen with no more works/clearing to be carried out.



Why we like it....

An excellent investment for someone with knowledge and appreciation of the level of works required.

OSCAR JAMES

1 Newland Street | Kettering | NN16 8JH
01536 415777
www.oscar-james.com

To buy or not to buy....
