

Chepstow Close  
Kettering  
NN15 5EP

£1,250 Per Month



OSCAR JAMES

...expect excellence



# FLOOR PLANS

GROUND FLOOR  
531 sq.ft. (49.3 sq.m.) approx.

1ST FLOOR  
466 sq.ft. (43.2 sq.m.) approx.

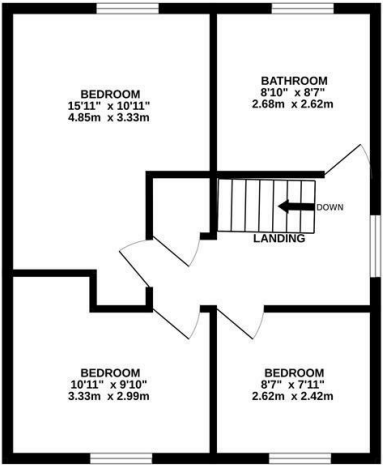
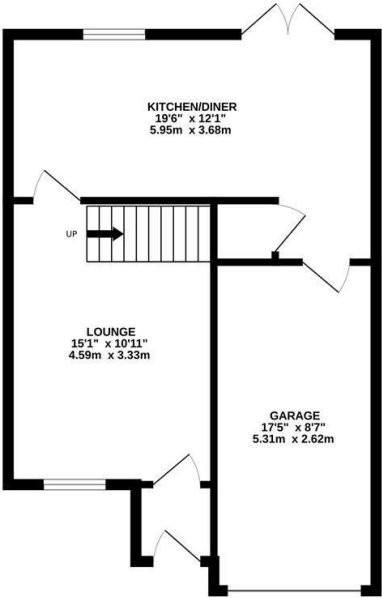

TOTAL FLOOR AREA : 996 sq.ft. (92.6 sq.m.) approx.  
Whilst every attempt has been made to ensure the accuracy of the floorplan contained here, measurements of doors, windows, rooms and any other items are approximate and no responsibility is taken for any error, omission or mis-statement. This plan is for illustrative purposes only and should be used as such by any prospective purchaser. The services, systems and appliances shown have not been tested and no guarantee as to their operability or efficiency can be given.  
Made with Metropix ©2024



## AT A GLANCE...



custom text 1



custom text 4



custom text 2



custom text 5



custom text 3



custom text 6



# WHAT'S GREAT?

## THREE BEDROOM DETACHED..... ISE LODGE KETTERING

Offered to the market is this beautifully presented, three bedroom home in a quiet close on the Ise Lodge Estate in Kettering.

The property briefly comprises entrance porch, lounge leading to the kitchen diner giving access to the integral garage and door to the large rear garden.

The first floor are three bedrooms, master boasting built in wardrobes and family bathroom with separate shower cubicle.

Offered to the market unfurnished and available mid July 2025

EPC D  
Council tax C

...expect excellence





# SELLER'S SECRET



Why we like it....

OSCAR JAMES

1 Newland Street | Kettering | NN16 8JH  
01536 415777  
[www.oscar-james.com](http://www.oscar-james.com)

To buy or not to buy....

---

---

---

---

---