

Main Street
Lubenham
LE16 9TF

£725 Per Month



OSCAR JAMES

...expect excellence

FLOOR PLANS

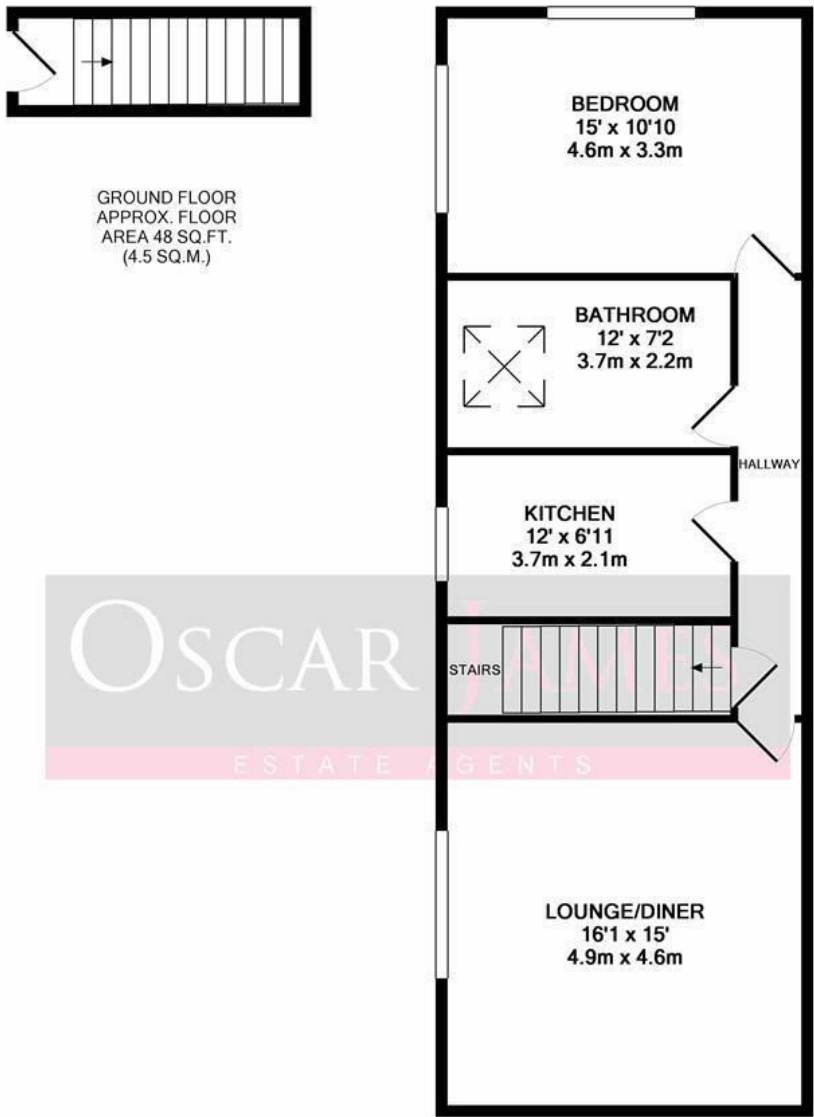

1ST FLOOR
APPROX. FLOOR
AREA 673 SQ.FT.
(62.6 SQ.M.)

TOTAL APPROX. FLOOR AREA 722 SQ.FT. (67.1 SQ.M.)

Whilst every attempt has been made to ensure the accuracy of the floor plan contained here, measurements of doors, windows, rooms and any other items are approximate and no responsibility is taken for any error, omission, or mis-statement. This plan is for illustrative purposes only and should be used as such by any prospective purchaser. The services, systems and appliances shown have not been tested and no guarantee as to their operability or efficiency can be given
Made with Metropix ©2018



AT A GLANCE...



custom text 1



custom text 4



custom text 2



custom text 5



custom text 3



custom text 6



WHAT'S GREAT?

AVAILABLE 18th April is this beautiful first floor coach house situated in the lovely village of Lubenham which is situated close to the market town of Market Harborough with its many shops, restaurants and Train Station.

Upon entering the generously sized property via its bright entrance hall there is access to a double bedroom, large bathroom, fabulous lounge and separate kitchen

To arrange your viewing contact Oscar James on 01536 415777 we will be glad to make arrangements for you.

LARGE ONE BEDROOM APARTMENT
MONTHLY RENT INCLUDES WATER RATES

EPC D
Council Tax A

...expect excellence



SELLER'S SECRET



OSCAR JAMES

1 Newland Street | Kettering | NN16 8JH
01536 415777
www.oscar-james.com

To buy or not to buy....

Why we like it....