

Leicester Street  
Kettering  
NN16 8EF

£1,095 Per Month



OSCAR JAMES

...expect excellence

# FLOOR PLANS

GROUND FLOOR  
526 sq.ft. (48.9 sq.m.) approx.

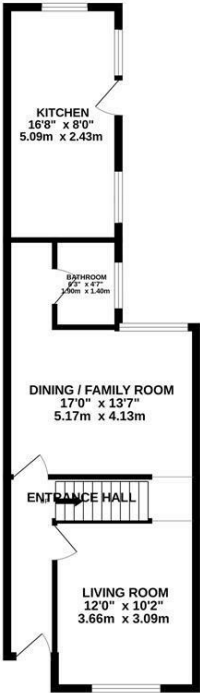

1ST FLOOR  
351 sq.ft. (32.6 sq.m.) approx.

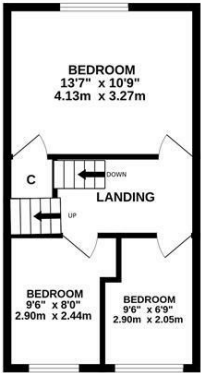

2ND FLOOR  
176 sq.ft. (16.3 sq.m.) approx.



TOTAL FLOOR AREA: 1052 sq.ft. (97.8 sq.m.) approx.  
Whilst every attempt has been made to ensure the accuracy of the floorplan contained here, measurements of doors, windows, rooms and any other items are approximate and no responsibility is taken for any error, omission or mis-statement. This plan is for illustrative purposes only and should be used as such by any prospective purchaser. The services, systems and appliances shown have not been tested and no guarantee as to their operability or efficiency can be given.  
Made with Metropix ©2025



## AT A GLANCE...



custom text 1



custom text 4



custom text 2



custom text 5



custom text 3



custom text 6





# WHAT'S GREAT?

FOUR BEDROOM HOME FOR RENT CLOSE TO KETTERING GENERAL HOSPITAL AND TOWN CENTRE

We are pleased to offer to the market this four bedroom home, close to Kettering town centre, Kettering General Hospital, schools and local amenities.

With separate reception rooms, kitchen with space for a small table, enclosed rear garden.

To the first floor are three bedrooms and family bathroom and a further double bedroom to the third floor.

Freshly decorated, plenty of windows to allow natural light throughout and a good family home.

Offered to the market unfurnished and available NOW

EPC D  
Council tax A

...expect excellence



## SELLER'S SECRET



Why we like it....

OSCAR JAMES

1 Newland Street | Kettering | NN16 8JH  
01536 415777  
[www.oscar-james.com](http://www.oscar-james.com)

To buy or not to buy....

---

---

---

---

---