

Summerfield Road
Kettering
NN15 6EN

£249,995



OSCAR JAMES

...expect excellence

FLOOR PLANS

GROUND FLOOR
386 sq.ft. (35.8 sq.m.) approx.

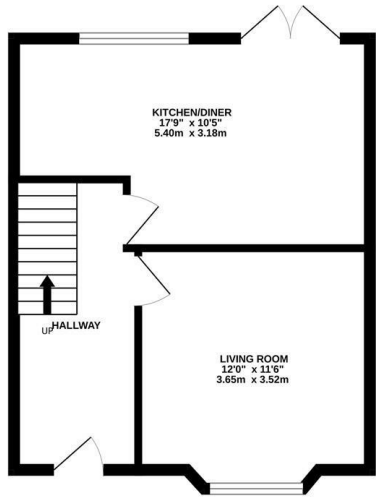

1ST FLOOR
380 sq.ft. (35.3 sq.m.) approx.

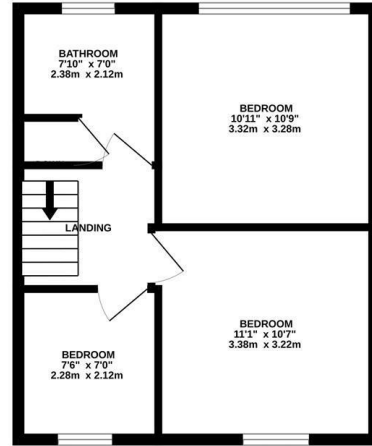

TOTAL FLOOR AREA: 766 sq.ft. (71.1 sq.m.) approx.

Whilst every attempt has been made to ensure the accuracy of the floorplan contained here, measurements of doors, windows, rooms and any other items are approximate and no responsibility is taken for any error, omission or mis-statement. This plan is for illustrative purposes only and should be used as such by any prospective purchaser. The services, systems and appliances shown have not been tested and no guarantee as to their operability or efficiency can be given.

Made with Metropix ©2025



AT A GLANCE...



custom text 1



custom text 4



custom text 2



custom text 5



custom text 3



custom text 6



WHAT'S GREAT?

A fabulous example of a period three bedroom bay fronted semi detached home situated in an excellent location, close to the Kettering town centre and train station.

This property benefits from off road parking to the front, a refitted kitchen and a fabulous size rear garden ideal for all the family to enjoy.

In brief the accommodation comprises of an entrance hall, lounge and refitted kitchen/diner on the ground floor. To the first floor there are three bedrooms and a family bathroom.

Outside expect to find off road parking to the front and the lovely large rear garden, mainly laid to lawn with patio area and raised decking area for entertaining and relaxing.

Call Oscar James Kettering to make arrangements to view.

...expect excellence



SELLER'S SECRET

We have seen a new build property that we have decided to proceed with hence we are now selling.



Why we like it....

A lovely home, we highly recommend an internal viewing to appreciate all it has to offer.

OSCAR JAMES

1 Newland Street | Kettering | NN16 8JH
01536 415777
www.oscar-james.com

To buy or not to buy....
