

Belton Road
Barton Seagrave
Kettering
NN15 5YY

£400,000



OSCAR JAMES

...expect excellence

FLOOR PLANS

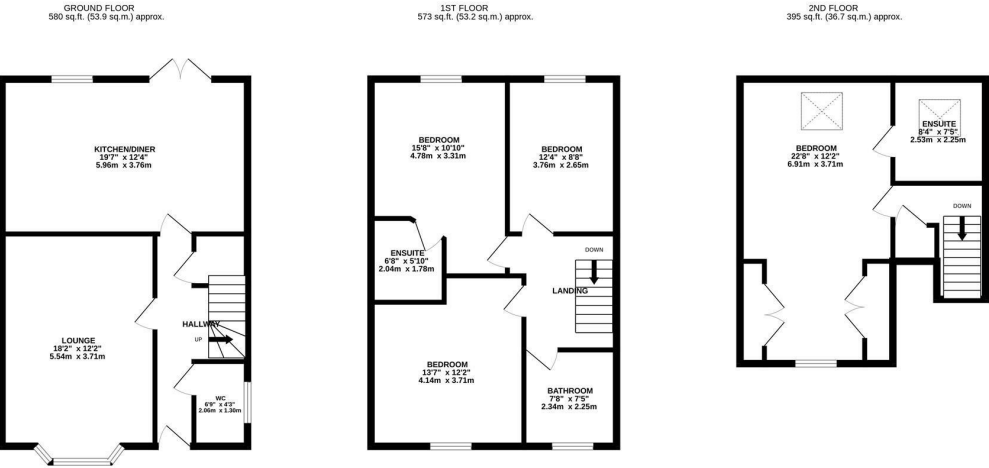

TOTAL FLOOR AREA : 1547 sq.ft. (143.7 sq.m.) approx.

Whilst every attempt has been made to ensure the accuracy of the floorplan contained here, measurements of doors, windows, rooms and any other items are approximate and no responsibility is taken for any error, omission or mis-statement. This plan is for illustrative purposes only and should be used as such by any prospective purchaser. The services, systems and appliances shown have not been tested and no guarantee as to their operability or efficiency can be given.

Made with Metropix ©2025



AT A GLANCE...



custom text 1



custom text 4



custom text 2



custom text 5



custom text 3



custom text 6



WHAT'S GREAT?

A fantastic four bed detached David Wilson built family home, situated on the popular Bertone Manor Estate.

The ground floor of the property comprises of: entrance hall, W.C, large bay fronted lounge and a superb kitchen / dining / family room with integrated appliances, this room gives access via French doors to the fully enclosed rear garden which is mainly laid lawn.

To the first floor there are three double bedroom, one of which benefits from an ensuite, also a family bathroom to complete this floor.

The master suite can be found on the second floor, offering built in wardrobes and large ensuite shower facilities.

To the rear of the property you have a private enclosed rear garden, to the front of the property you have off road parking for two cars and a single garage.

Please call Oscar James to arrange a viewing.

...expect excellence



SELLER'S SECRET

I have owned this property since new and have had it rented out, it is now time for me to sell.



Why we like it....

A great property in a fantastic location.

OSCAR JAMES

1 Newland Street | Kettering | NN16 8JH

01536 415777

www.oscar-james.com

To buy or not to buy....
