

Wolfe Close
Kettering
NN15 5DA

£190,000



OSCAR JAMES

...expect excellence

FLOOR PLANS

GROUND FLOOR
662 sq.ft. (61.5 sq.m.) approx.

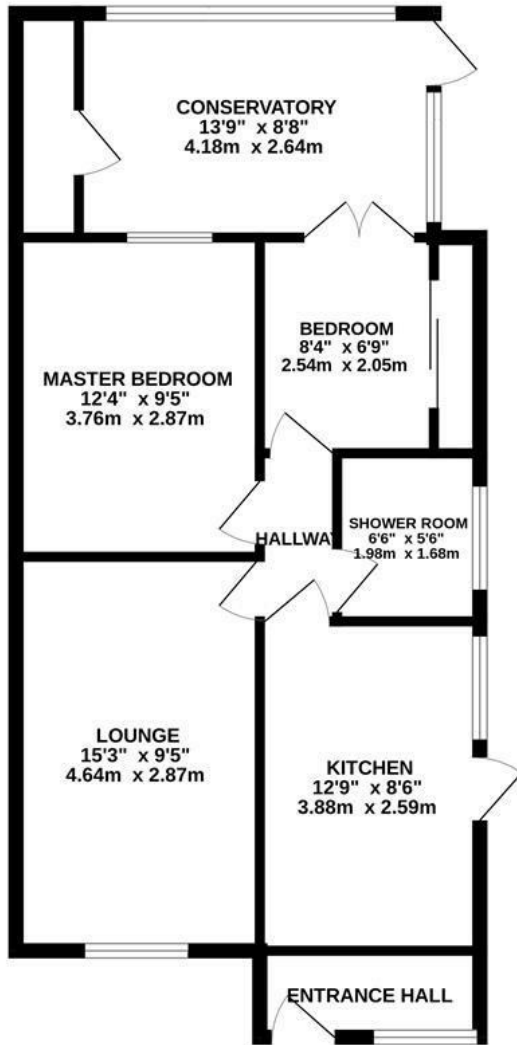

TOTAL FLOOR AREA : 662 sq.ft. (61.5 sq.m.) approx.

Whilst every attempt has been made to ensure the accuracy of the floorplan contained here, measurements of doors, windows, rooms and any other items are approximate and no responsibility is taken for any error, omission or mis-statement. This plan is for illustrative purposes only and should be used as such by any prospective purchaser. The services, systems and appliances shown have not been tested and no guarantee as to their operability or efficiency can be given.
Made with Metropix 6/2024



AT A GLANCE...



custom text 1



custom text 4



custom text 2



custom text 5



custom text 3



custom text 6



WHAT'S GREAT?

*****SOLD PRIOR TO MARKETING*****

2 bedroom semi detached bungalow situated on the Ise Lodge estate needing updating.

More required!!

...expect excellence



SELLER'S SECRET



Why we like it....

OSCAR JAMES

1 Newland Street | Kettering | NN16 8JH
01536 415777
www.oscar-james.com

To buy or not to buy....
