

Berneshaw Close
Corby
NN18 8EJ

£785 Per Month



OSCAR JAMES

...expect excellence

FLOOR PLANS

GROUND FLOOR
252 sq.ft. (23.4 sq.m.) approx.

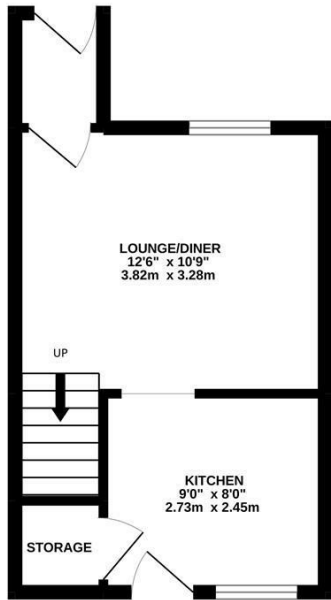

1ST FLOOR
236 sq.ft. (21.9 sq.m.) approx.

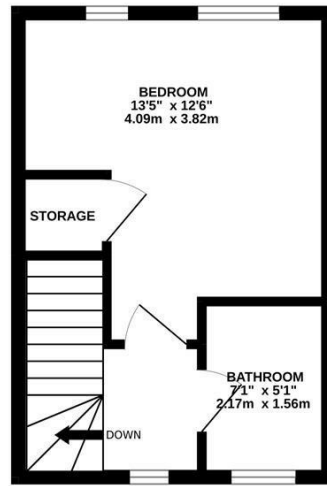

TOTAL FLOOR AREA: 488 sq.ft. (45.3 sq.m.) approx.

Whilst every attempt has been made to ensure the accuracy of the floorplan contained here, measurements of doors, windows, rooms and any other items are approximate and no responsibility is taken for any error, omission or mis-statement. This plan is for illustrative purposes only and should be used as such by any prospective purchaser. The services, systems and appliances shown have not been tested and no guarantee as to their operability or efficiency can be given.
Made with Metropix ©2022



AT A GLANCE...



custom text 1



custom text 4



custom text 2



custom text 5



custom text 3



custom text 6



WHAT'S GREAT?

Fantastic one bedroom home offered for rent.. available early August

The property briefly comprises lounge, fitted kitchen to the ground floor, rear garden which is mainly laid to lawn giving access to the single garage and off road parking

To the first floor is the bathroom with shower over bath and double bedroom with built in wardobes

MUST BE SEEN

EPC currently D but being re assessed since new UPVC windows are being fitted.
Council tax A

...expect excellence



SELLER'S SECRET



Why we like it....

OSCAR JAMES

1 Newland Street | Kettering | NN16 8JH
01536 415777
www.oscar-james.com

To buy or not to buy....
