

Donne Close  
Kettering  
NN16 9XS

£1,195 Per Month



OSCAR JAMES

...expect excellence

# FLOOR PLANS

GROUND FLOOR  
327 sq.ft. (30.4 sq.m.) approx.

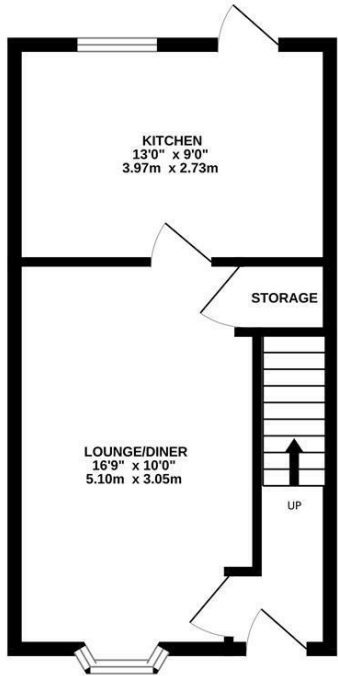

1ST FLOOR  
325 sq.ft. (30.2 sq.m.) approx.

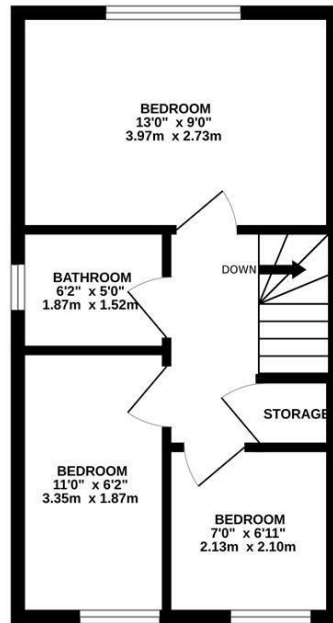

TOTAL FLOOR AREA : 653 sq.ft. (60.6 sq.m.) approx.

Whilst every attempt has been made to ensure the accuracy of the floorplan contained here, measurements of doors, windows, rooms and any other items are approximate and no responsibility is taken for any error, omission or mis-statement. This plan is for illustrative purposes only and should be used as such by any prospective purchaser. The services, systems and appliances shown have not been tested and no guarantee as to their operability or efficiency can be given.  
Made with Metropix ©2024



## AT A GLANCE...



custom text 1



custom text 4



custom text 2



custom text 5



custom text 3



custom text 6



# WHAT'S GREAT?

A charming property located on a quiet cul-de -sac to the North of Kettering.

The property briefly comprises: Lounge with bay window, modern kitchen with ample storage and five ring gas hob.

To the first floor are three bedrooms and family bathroom with shower over bath.

To the rear is a fabulous sized, enclosed rear garden with patio and lawn, side access to the parking area and large shed.

Offered to the market unfurnished and available NOW

EPC C  
Council tax C

...expect excellence



# SELLER'S SECRET



*Why we like it....*

**OSCAR JAMES**

1 Newland Street | Kettering | NN16 8JH  
01536 415777  
[www.oscar-james.com](http://www.oscar-james.com)

*To buy or not to buy....*

---

---

---

---

---