

1 Ise Court, French Drive
Kettering
Northamptonshire
NN15 5FB

£850 Per Month



OSCAR JAMES

...expect excellence

FLOOR PLANS

GROUND FLOOR
670 sq.ft. (62.3 sq.m.) approx.

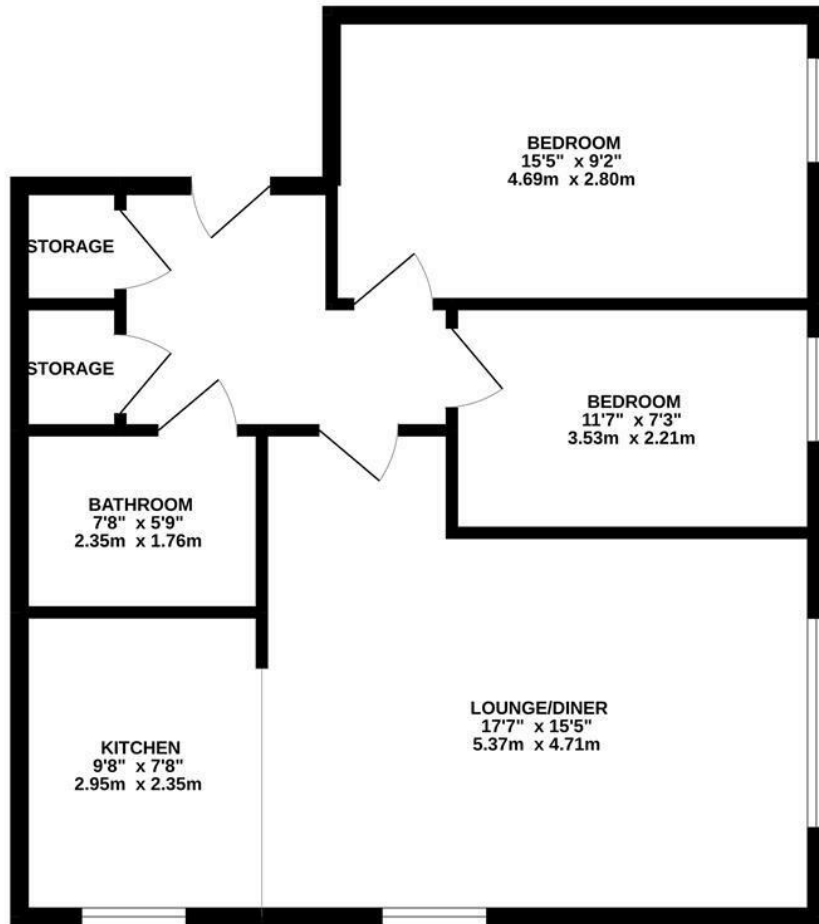

TOTAL FLOOR AREA : 670 sq.ft. (62.3 sq.m.) approx.
Whilst every attempt has been made to ensure the accuracy of the floorplan contained here, measurements of doors, windows, rooms and any other items are approximate and no responsibility is taken for any error, omission or mis-statement. This plan is for illustrative purposes only and should be used as such by any prospective purchaser. The services, systems and appliances shown have not been tested and no guarantee as to their operability or efficiency can be given.
Made with Metropix ©2022



AT A GLANCE...



custom text 1



custom text 4



custom text 2



custom text 5



custom text 3



custom text 6



WHAT'S GREAT?

Ground floor two bedroom apartment on Ise Lodge Kettering

This large apartment is light, airy and spacious throughout. With open plan living / kitchen, two double bedrooms and bathroom with shower over bath.

Offered to the market unfurnished and available for you to make your home from end of May

VIEWINGS AVAILABLE NOW

NO PETS

MUST BE SEEN

EPC D

Council Tax A

...expect excellence



SELLER'S SECRET



Why we like it....

OSCAR JAMES

1 Newland Street | Kettering | NN16 8JH
01536 415777
www.oscar-james.com

To buy or not to buy....
