



24 Riverside

This modern end-terrace town house is situated in the sought-after Riverside development off Tattershall Road in Boston. The property is located only a short, pleasant walk along the riverside from the historical town centre in one direction, and the Witham Country Park Nature Reserve in the other.

In brief, the ground floor accommodation comprises lounge, cloakroom and a good size dining kitchen with space for a table, whilst the first floor features two bedrooms and the bathroom.

The property also benefits from gas-fired central heating and uPVC double glazing, whilst outside there is an enclosed low-maintenance garden and parking space.

- Two Bedroom End-Terrace Property
- Well-Presented Throughout
- Built By Chestnut Homes
- Bathroom & Cloakroom
- Off-Road Parking
- Conveniently Situated For Amenities & Boston Marina
- Gas-Fired Central Heating & uPVC Double Glazing
- EPC - 'C' 78. Tenure: Freehold. Council Tax Band 'A'



The property is approached via a double-width paved footpath leading up to the front entrance with lantern style light and door leading into the:

Lounge 4.29m x 3.94m - With uPVC double glazed window to the front aspect, radiator, stairs to the first floor and door to the kitchen.

Dining Kitchen 4.26m x 2.68m red. to 2.36m - The kitchen has uPVC window and a part-glazed door leading out to the enclosed rear garden. Fitted units comprise a range of cupboard and drawer units to both base and eye level, with work surfaces having an inset one-and-a-half bowl stainless steel style sink/drainers unit with mixer tap, inset four ring stainless steel style gas hob with extractor canopy over and oven below. Spaces for washing machine and fridge. Tiling as appropriate and door to the cloakroom/WC.

Cloakroom/ WC – Comprising a modern white suite of low-profile close-coupled WC, hand basin with tiled splash back and radiator.

First Floor – The landing has an airing cupboard housing the Baxi gas-fired central heating boiler, loft access and doors arranged off to:

Bedroom One 4.28m red. to 3.27m x 3.09m – Having a uPVC sash window to the front aspect, over-stairs cupboard and radiator.

Bedroom Two 3.52m x 2.09m - Having a uPVC window to the rear aspect and radiator.

Bathroom – The bathroom comprises a modern white suite of panel bath with mixer tap and shower over, pedestal hand basin with mixer tap and low-profile WC. Radiator, shaver point and tiling as appropriate.





Outside

The property has been attractively bordered to the front with arrow-tip railing and dressed with shrubs and flowers, whilst the rear garden has been enclosed and is of a low-maintenance design combining gravel with a patio seating area. The property also has the added benefit of allocated parking.

NOTE: Tenure: Freehold. * SERVICE/ MAINTENANCE CHARGE APPLIES.

All measurements are approximate and should be used as a guide only. None of the services connected, fixtures or fittings have been verified or tested by the Agent and as such cannot be relied upon without further investigation by the buyer. All properties are offered subject to contract. Fairweather Estate Agents Limited, for themselves and for Sellers of this property whose Agent they are, give notice that:- 1) These particulars, whilst believed to be accurate, are set out as a general outline only for guidance and do not constitute any part of any offer or contract; 2) All descriptions, dimensions, reference to condition and necessary permissions for use and occupation, and other details are given without responsibility and any intending Buyers should not rely on them as statements or representations of fact but must satisfy themselves by inspection or otherwise as to their accuracy; 3) No person in this employment of Fairweather Estate Agents Limited has any authority to make or give any representation or warranty whatsoever in relation to this property.

Ground Floor

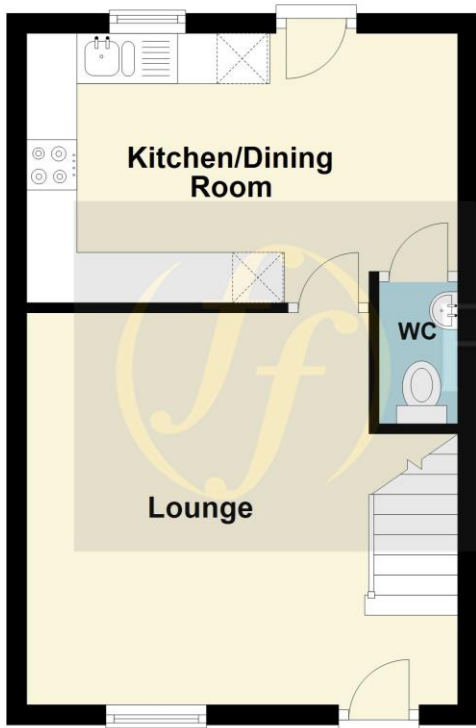

First Floor



22 Dolphin Lane, Boston
Lincolnshire PE21 6EU
T| 01205 336122
E| sales@fairweather-estateagents.co.uk

