

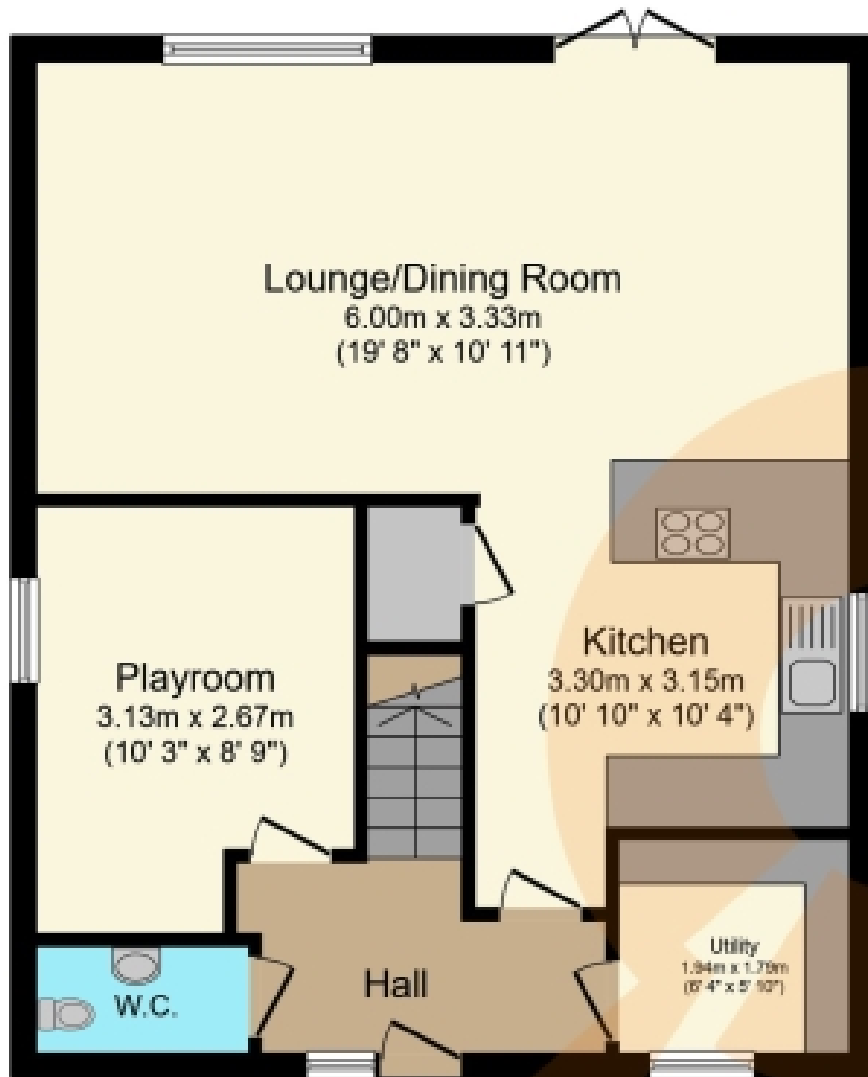

Eglinton Gardens, 39 Head Street, Beith

Offers Over £299,000





Ground Floor

Floor area 47.4 m² (510 sq.ft.)

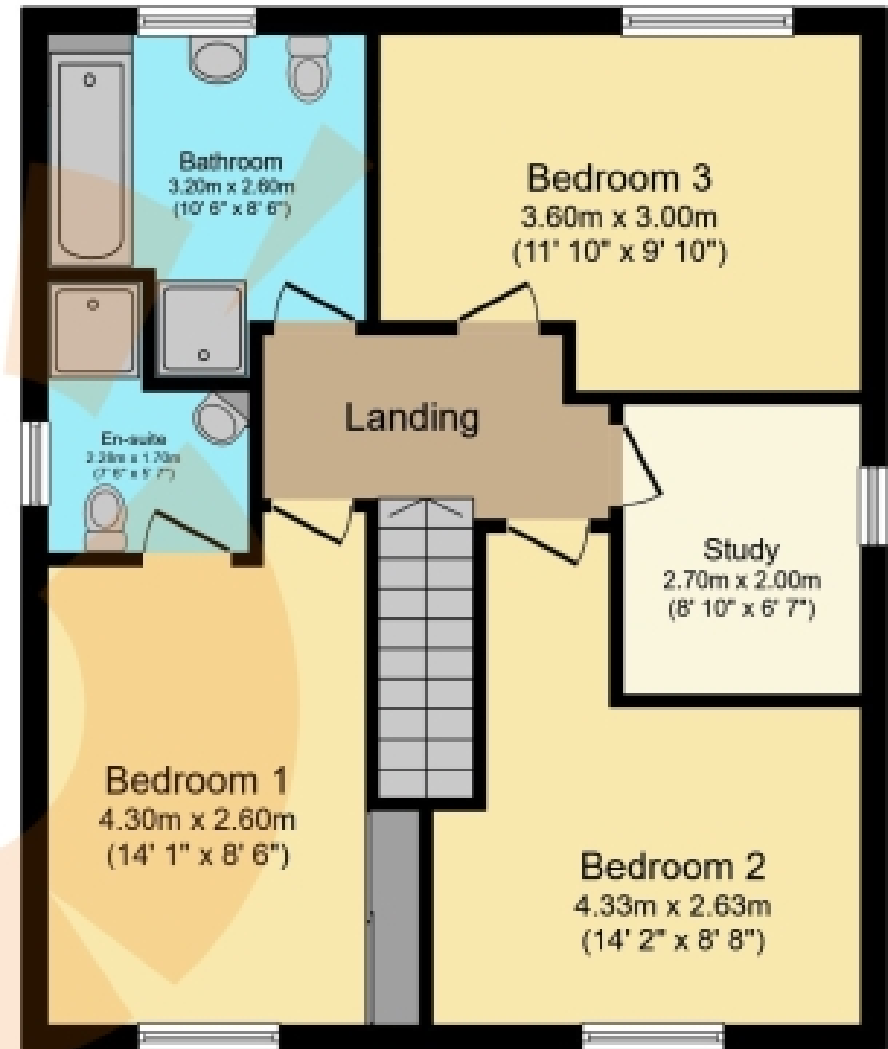

First Floor

Floor area 56.6 m² (609 sq.ft.)

TOTAL: 103.9 m² (1,119 sq.ft.)

This floor plan is for illustrative purposes only. It is not drawn to scale. Any measurements, floor areas (including any total floor area), openings and orientations are approximate. No details are guaranteed, they cannot be relied upon for any purpose and do not form any part of any agreement. No liability is taken for any error, omission or misstatement. A party must rely upon its own inspection(s). Powered by www.Propertybox.io

THE PROPERTY

The home you've been waiting for.... One of the final properties at Eglinton Gardens. Exquisitely designed residences by McEnhill Homes, renowned for their contemporary, luxurious properties of exceptional quality. Located in the desirable town of Beith in North Ayrshire, these exclusive homes are finished to an impressive high standard and perfectly situated to enjoy the abundant local amenities and transport links this popular area offers.

McEnhill Homes has meticulously crafted these generously proportioned residences to offer the perfect blend of style and functionality. Each home features bright, airy, and spacious open-plan living accommodation. Natural light floods these homes, highlighting their super stylish and sociable layout.

As you step inside, the ground floor impresses with an open-plan lounge and dining area that offers lovely views of the rear garden. French doors, leads to a charming patio and turfed lawn, perfect for outdoor entertaining. The high-quality, ultra-modern kitchen, complete with a separate utility room, boasts integrated appliances set within chic wall and floor-mounted units, topped with elegant Calcatta laminate worktops. Additionally, the ground floor includes a versatile playroom or home office and a conveniently located w.c.

Upstairs, the luxury continues with three double bedrooms, all featuring fitted wardrobes, and a single room. The master bedroom is a private retreat with a luxurious en-suite shower room, while the family bathroom is designed for comfort and convenience with a separate shower cubicle. The properties are also enhanced by a Worcester Bosch gas central heating system with thermostatically controlled radiators and showers.

Eglinton Gardens on Head Street is ideally situated within walking distance to local shops, cafes, and excellent schools. Commuting is easy with nearby transport links, including quick access to Glengarnock train station and bus services to Glasgow City Centre.

Don't miss the opportunity to own one of these exceptional homes. Contact Boom today to arrange a viewing and experience the perfect blend of luxury and convenience in the heart of Beith.

These fabulous family homes in a highly sought-after location will be very popular. We would highly recommend an early viewing. Viewing by appointment – please contact The Property Boom to arrange a viewing or to discuss the reservation process. Any areas, measurements or distances quoted are approximate and floor Plans are only for illustration purposes and are not to scale. Thank you.

THESE PARTICULARS ARE ISSUED IN GOOD FAITH BUT DO NOT CONSTITUTE REPRESENTATIONS OF FACT OR FORM PART OF ANY OFFER OR CONTRACT.

www.thepropertyboom.com
70 West Regent Street, Glasgow, G2 2QZ
Tel: 0333 900 9089 / Email: smile@thepropertyboom.com