

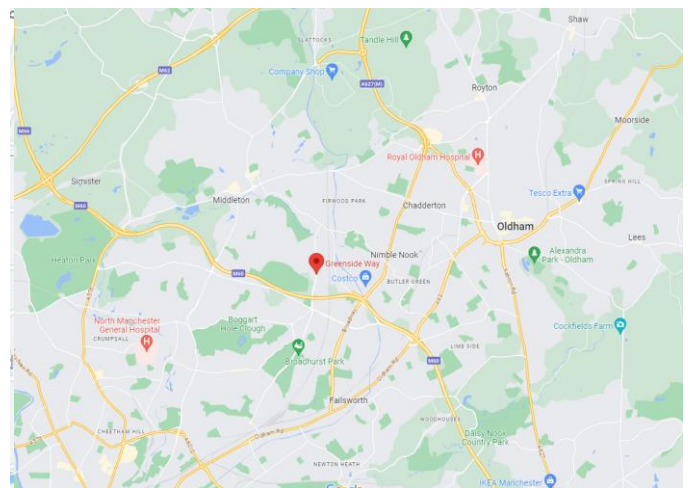

**Build to Suit Opportunity  
54,340 (5,050 sqm)**

**Property Highlights**

- 12m eaves
- 6 dock loading doors
- 2 drive in loading doors
- 5 trailer spaces
- Separate yard and parking
- 53 parking spaces



**ROB TAYLOR**  
Cushman & Wakefield  
Mobile: +44(0)7825 193365  
Email: [rob.p.taylor@cushwake.com](mailto:rob.p.taylor@cushwake.com)

**LAURENCE DAVIES**  
Cushman & Wakefield  
Mobile: +44 (0)7385 410942  
Email: [Laurence.davies@cushwake.com](mailto:Laurence.davies@cushwake.com)

**ANDY BACKHOUSE**  
Sixteen Real Estate  
Mobile: +44 (0)7548 596271  
Email: [andy@sixteenrealestate.com](mailto:andy@sixteenrealestate.com)

## Location

The property is located on the junction of Greengate and Greenside Way. Both Junction 20 and 21 of the M60 are situated just 1.5 miles away, with Junction 20 of the M62 2 miles to the north. Manchester City centre lies 5 miles to the south with Rochdale 8 miles to the north and Oldham 5 miles to the east.

| Transport                   | Distance  |
|-----------------------------|-----------|
| Junction 20 & 21 M60        | 1.5 miles |
| Junction 20 of M62 Motorway | 2 miles   |
| Manchester City Centre      | 5 miles   |
| Manchester Airport          | 19 miles  |
| Source: Google Maps         |           |

## Description

The unit can be delivered within 9 months of exchanging contracts. The unit will have an eaves height of 12m, 2 level access loading doors, 6 dock loading doors, 10% rooflights, fenced yard, two storey office provision and 53 parking spaces.

## Accommodation

| Unit 10            | Sqft   | Sqm   |
|--------------------|--------|-------|
| Warehouse          | 50,055 | 4,651 |
| First Floor Office | 4,285  | 398   |
| Total              | 54,340 | 5,050 |

## Rent

On Application

## Rateable Value

TBC

## Service Charge

TBC

## EPC

Upon Application

**ROB TAYLOR**  
Cushman & Wakefield  
Mobile: +44(0)7825 193365  
Email: [rob.p.taylor@cushwake.com](mailto:rob.p.taylor@cushwake.com)

**LAURENCE DAVIES**  
Cushman & Wakefield  
Mobile: +44 (0)7385 410942  
Email: [Laurence.davies@cushwake.com](mailto:Laurence.davies@cushwake.com)

**ANDY BACKHOUSE**  
Sixteen Real Estate  
Mobile: +44 (0)7548 596271  
Email: [andy@sixteenrealestate.com](mailto:andy@sixteenrealestate.com)

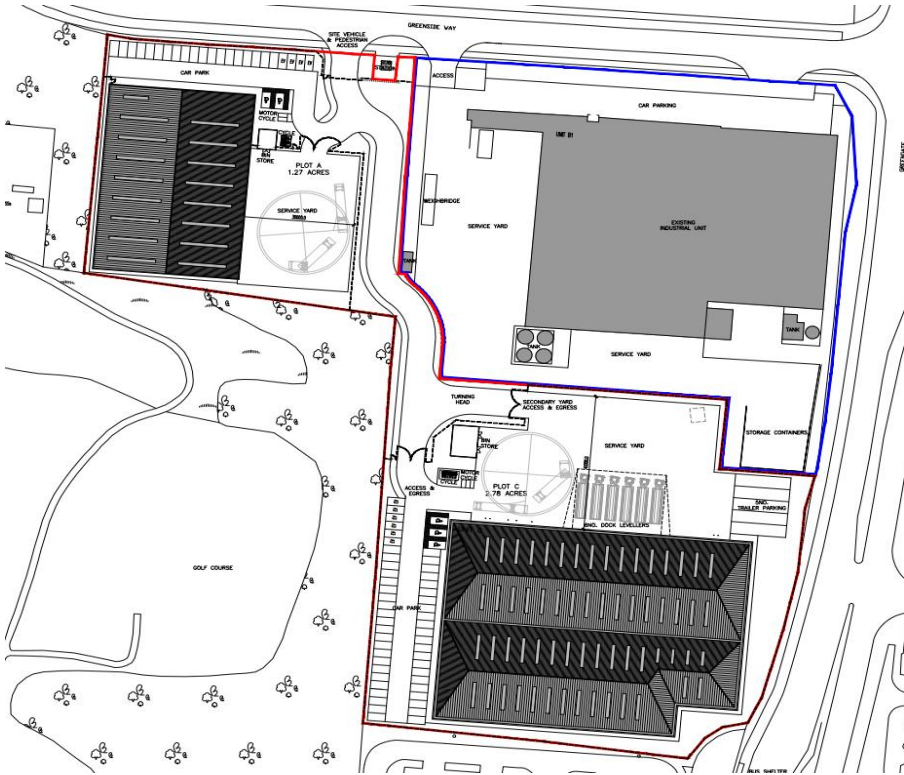

**The Misrepresentation Act 1967.**

Cushman & Wakefield (and any joint agent appointed) for themselves and for vendors or lessors of this property, whose agents they are, gives notice that: 1 The particulars are produced in good faith, but are a general guide only and do not constitute any part of a contract. 2 No person in the employment of the agent(s) has any authority to make or give any representation or warranty whatsoever in relation to this property. 3 The property is offered subject to contract and unless otherwise stated all rents are quoted exclusive of VAT. 4 Nothing in these particulars should be deemed a statement that the property is in good condition, or that any services or facilities are in working order. 5 Unless otherwise stated, no investigations have been made regarding pollution, or potential land, air or water contamination. Interested parties are advised to carry out their own investigations if required. July 2023