



Great Gables  
Stevenage | SG1 6GL

AGENT HYBRID



Guide Price £275,000 -  
£290,000



We welcome to the market, a CHAIN FREE, Two Bedroom Mid Terraced Home, located in the heart of Great Ashby. An ideal first time or investment purchase. Accommodation briefly comprises of. An Entrance Hallway, with doors leading to the Downstairs WC, a well equipped Kitchen and a good-sized Lounge. Stairs from the lounge rise to the first floor landing where you will find Two Good Sized Bedrooms and the Bathroom. Externally, the property benefits from a Private, South West facing Rear Garden and a Single Garage. Parking is technically inside the garage, with ample areas to park within the road on a first come, first served basis. Within walking distance you will find 'The Neighbourhood Centre, offering an array of day to day amenities. The property also falls within the catchment of the highly regarded, Round Diamond Primary School.

DIMENSIONS

- Entrance Hallway
- Downstairs WC
- Kitchen 8'7 x 6'5
- Lounge/Diner 136 x 12'7
- Bedroom 1: 11'5 x 10'7
- Bedroom 2: 11'0 x 6'4
- Bathroom

Energy Efficiency Rating		
	Current	Potential
Very energy efficient - lower running costs		
(92 plus) A		90
(81-91) B		
(69-80) C	74	
(55-68) D		

Ground Floor

Approx. 26.2 sq. metres (281.9 sq. feet)

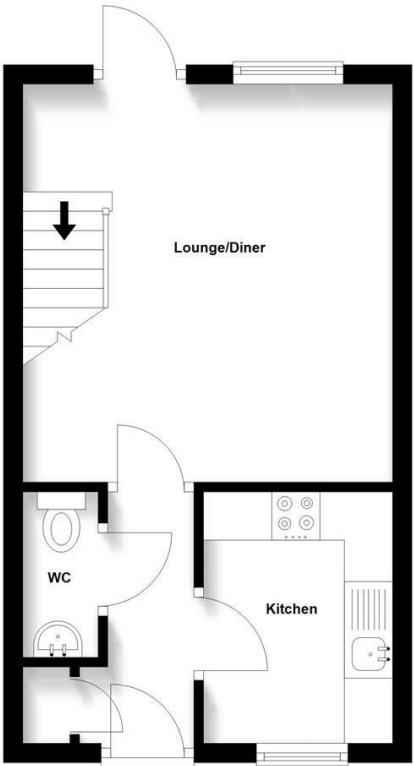

First Floor

Approx. 26.2 sq. metres (281.9 sq. feet)

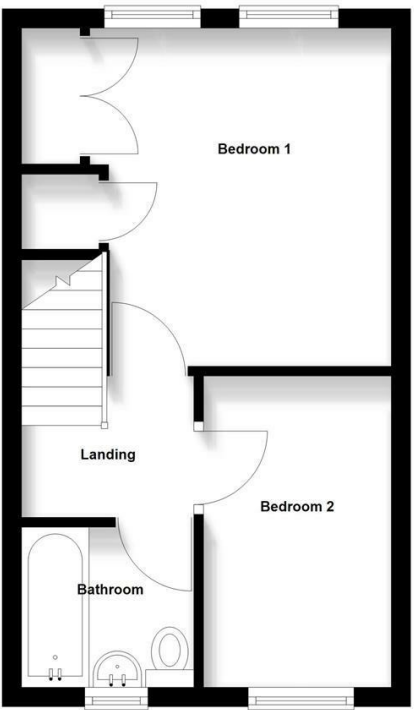

Total area: approx. 52.4 sq. metres (563.9 sq. feet)

IMPORTANT: We would like to inform prospective purchasers that these sales particulars have been prepared as a general guide only. A details survey has not been carried out, not the service, appliances and fittings tested. Rome sizes should not be relied upon for furnishing purposed and are approximate. If floor plans are included, they are for guidance and illustration purposes only and may not be to scale. If there are any important matters likely to affect your decision to buy, please contact us before viewing the property.

Agent Hybrid  
57 High Street, Stevenage, Hertfordshire, SG1 3AQ  
Tel: 01438 870673 - enquiries@agenthybrid.co.uk  
www.agenthybrid.co.uk

AGENT HYBRID