



Clouds
Gravelly Bank



Welcome Home

On first appearances, this property appears to take on the form of a modest bungalow. But after further inspection, you soon discover its enchanting secrets.

Standing on a generous plot along Gravelly Bank, this four-bedroom home is just a stone's throw from many sought-after amenities. Close to this peaceful location, you'll find highly regarded schools, handy public transport links and plenty of walking routes right from the front door, making it a desirable property for families with a love for nature.

Approach 'Clouds' from Gravelly Bank and pull onto the driveway, where there's ample off-road parking for three vehicles.

Enchanting Spaces

Open the heavy oak front door to discover what lies behind its charming, whitewashed façade. A spacious entrance hall welcomes you into the ground floor and the solid oak floor leads you further into the heart of the home. You'll no doubt be surprised to find that four bedrooms, ensuite and the family shower room reside on this floor.

Turn right into the study, an airy space with dual aspect windows and a wraparound desk, perfect for home working or a fourth bedroom for guests.

Across the hall lies a double bedroom looking onto the front elevation. Outside of the large window, a mature conifer adds a certain degree of privacy without blocking natural light.

Continue along the hall to the family shower room. Contemporary in design, this room has been recently refurbished to feature a heated towel and walk-in shower.





Views of Tree-lined Hillsides

To the rear of the ground floor are bedroom two and the Master Bedroom, both boasting captivating views over the tree-lined hillsides, which inspired the property's name, 'Clouds'. However, on a clear day, the views are uninterrupted and appear to go on forever.

Walk into the Master Bedroom, where a large window perfectly frames the natural backdrop. An ensuite bathroom adds to the allure and has all the hallmarks of a boutique hotel with its wet-room style rain shower, heated towel rail and a built-in television above the bath. If you can't resist a spot of pampering, this is the ultimate space for unwinding and washing away the stresses of the day.





Return to the entrance hall and follow the staircase down to the lower ground floor. Although a little unconventional, this unusual layout enhances the property and adds to its lovable eccentricities.

Continuing with the contemporary design, the large kitchen/diner is the jewel in the crown of 'Clouds'. Spanning the breadth of the house, the open-plan kitchen also features a dining area and cosy seating space for an L-shaped sofa. Imagine pouring yourself a drink and sinking into total relaxation or rustling up a gastronomic delight for friends and family, all the while soaking up the stunning views. Solid oak covers the floor and staircase, and beautiful bespoke wooden units with matching island add a rich warmth.

Following on from the kitchen is a useful utility room, ideal for hiding any clutter and doing the laundry. The understair store provides further storage, in addition to an extra area (accessed by a short ladder) which serves as an alternative to loft space.



The Secret Garden

Make your way back into the reception area of the kitchen/diner to access the rear garden which slopes down to the garden's edge. This is nothing short of magical, with its tall trees that have been left in the hands of Mother Nature to create a secret space that children love to explore.

Wander round to the Indian stone patio, a fabulous spot for private entertaining or a midsummer barbecue. From here, stone steps lead to a lawned area before luring you down into the secret garden.



Ground Floor

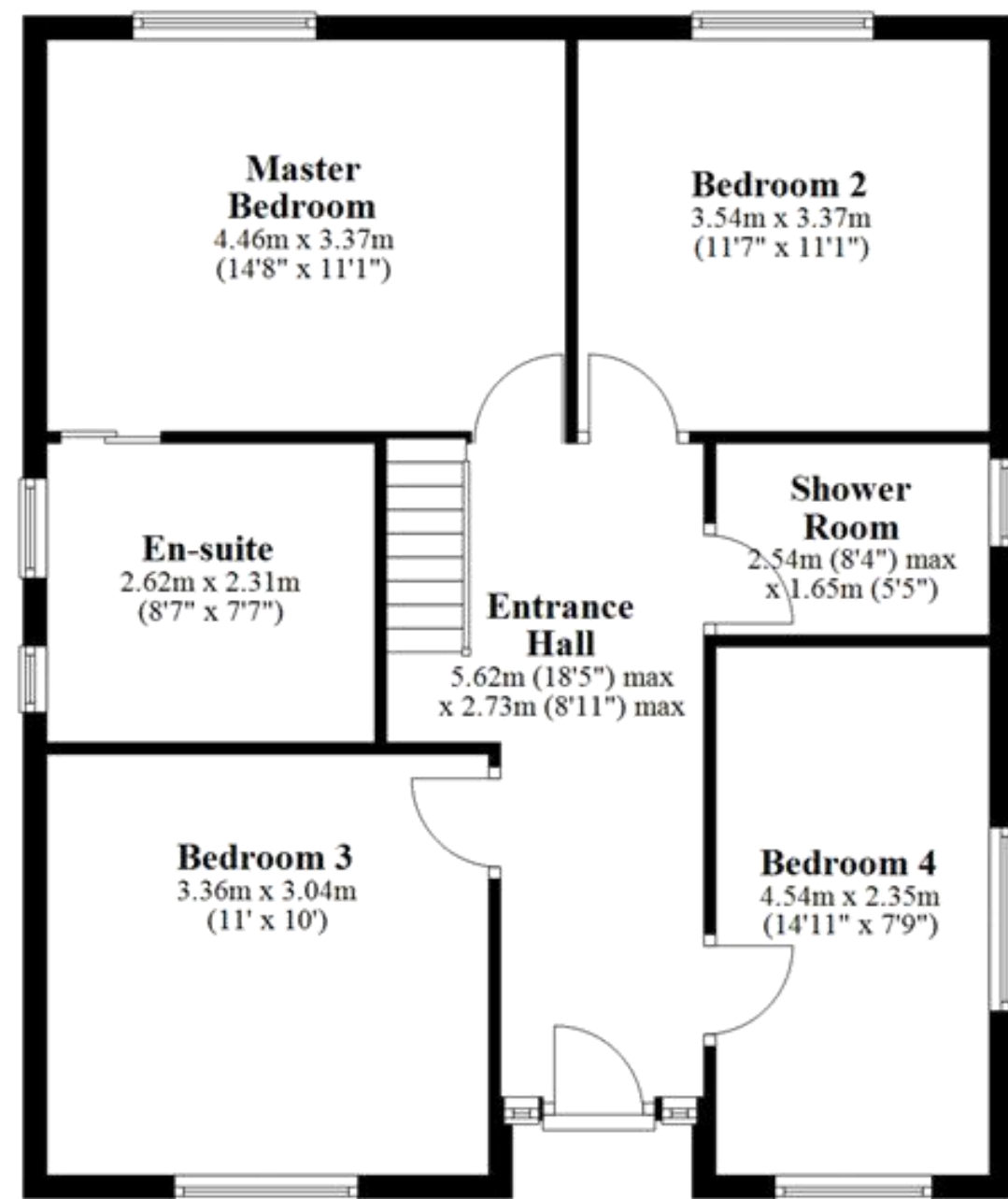

Lower Ground Floor

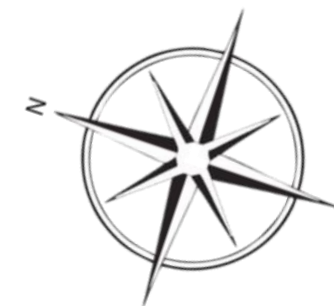
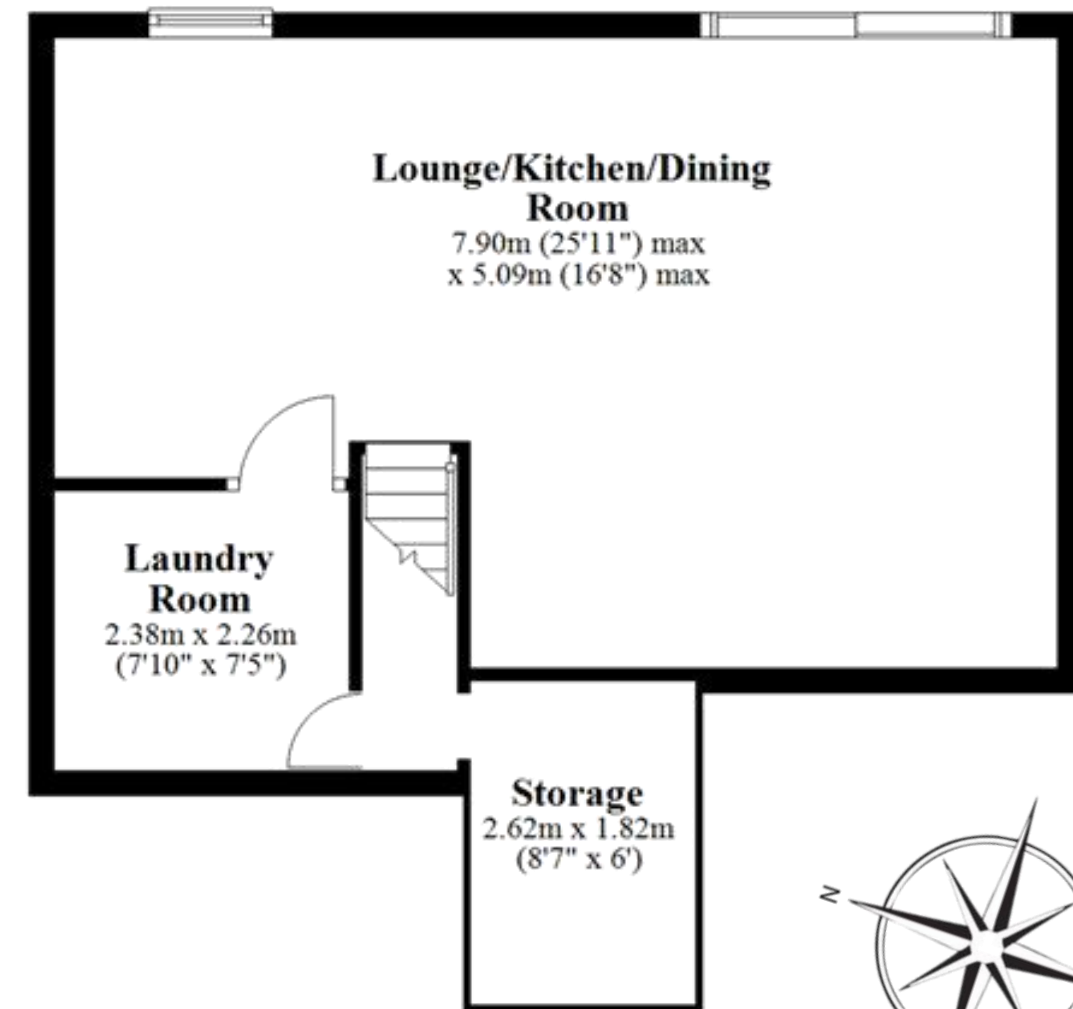



Clouds
Gravelly Bank



Contact Adam for more information

01538 493333

sales@addisonmead.co.uk

Addison Mead
— EXCLUSIVE —