



barnard marcus

Zanara Court Sydenham Road, London SE26 5QW



welcome to
Zanara Court Sydenham Road, London

An eye catching and dazzling duplex stylish apartment with spectacular interior design with the highest standard of finish on the ever popular Sydenham Road SE26!

This stylish apartment is magnificent from every angle and amounts to over 1,100sqft of living accommodation and benefits from lots of natural light flooding the apartment. This gorgeous apartment, with a house-like feel, comprises three fantastic sized bedrooms with secondary glazing installed, a huge cloak room, an ever so handy Utility Room, a sensational contemporary bathroom to unwind in and an astonishing open-plan modern entertainment area with featured vaulted ceiling, tall floor to ceiling windows, a contemporary kitchen design and direct access onto your very own balcony!

Sydenham High Street offers a good selection of local shops and boutiques, as well as being within reach of Wells Park, Dulwich Woods and Crystal Palace Park. Cobbs Corner is minutes away, as is the highly regarded Greyhound gastro pub and Good Food artisan grocery store and deli. Sydenham Station is only a 2 minute walk away and provides you with direct access into Central London or East London, to stations such as London Bridge, Canary Wharf via Canada Water and Shoreditch.



ZANARA COURT, SYDENHAM ROAD

APPROXIMATE GROSS INTERNAL FLOOR AREA: 1103 SQ FT - 102.47 SQ M

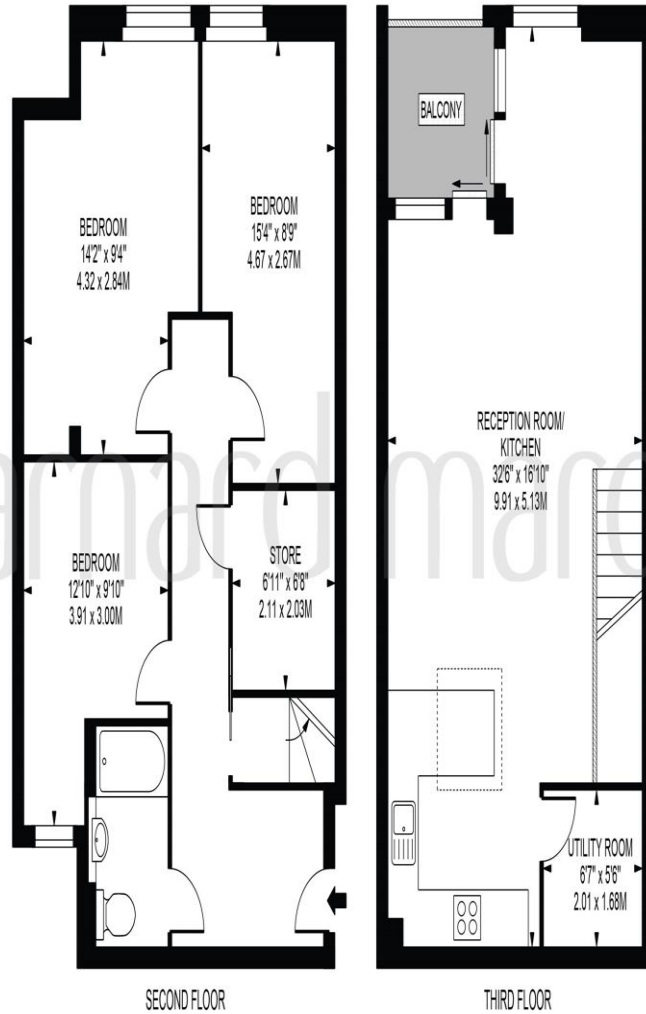

FOR ILLUSTRATION PURPOSES ONLY

THIS FLOOR PLAN SHOULD BE USED AS A GENERAL OUTLINE FOR GUIDANCE ONLY AND DOES NOT CONSTITUTE IN WHOLE OR IN PART AN OFFER OR CONTRACT.
ANY INTENDING PURCHASER OR LESSEE SHOULD SATISFY THEMSELVES BY INSPECTION, SEARCHES, ENQUIRIES AND FULL SURVEY AS TO THE CORRECTNESS OF EACH STATEMENT.
ANY AREAS, MEASUREMENTS OR DISTANCES QUOTED ARE APPROXIMATE AND SHOULD NOT BE USED TO VALUE A PROPERTY OR BE THE BASIS OF ANY SALE OR LET.



welcome to

Zanara Court Sydenham Road, London

- Duplex-Style Apartment with house-like feel
- 3 Double Bedrooms
- Large Open Plan Kitchen/Lounge with Vaulted Ceilings
- Private Balcony
- Access to large communal courtyard
- Fantastic location
- Cloak & Utility Rooms

Tenure: Leasehold EPC Rating: B

This is a Leasehold property. We are awaiting further details about the Term of the lease. For further information please contact the branch. Please note additional fees could be incurred for items such as Leasehold packs.

offers in excess of

£550,000



Please note the marker reflects the postcode not the actual property

view this property online barnardmarcus.co.uk/Property/SYD102449



Property Ref:
SYD102449 - 0005

1. MONEY LAUNDERING REGULATIONS Intending purchasers will be asked to produce identification documentation at a later stage and we would ask for your co-operation in order that there is no delay in agreeing the sale. 2. These particulars do not constitute part or all of an offer or contract. 3. The measurements indicated are supplied for guidance only and as such must be considered incorrect. Potential buyers are advised to recheck measurements before committing to any expense. 4. We have not tested any apparatus, equipment, fixtures or services and it is in the buyers interest to check the working condition of any appliances. 5. Where an EPC, or a Home Report (Scotland only) is held for this property, it is available for inspection at the branch by appointment. If you require a printed version of a Home Report, you will need to pay a reasonable production charge reflecting printing and other costs. 6. We are not able to offer an opinion either written or verbal on the content of these reports and this must be obtained from your legal representative. 7. Whilst we take care in preparing these reports, a buyer should ensure that his/her legal representative confirms as soon as possible all matters relating to title including the extent and boundaries of the property and other important matters before exchange of contracts.



barnard marcus



020 8776 9384



sydenham@barnardmarcus.co.uk



13 Sydenham Road, LONDON, SE26 5EX



barnardmarcus.co.uk