



HOLYHEAD ROAD

OAKENGATES | TF2 6DW



FOR SALE
Offers in the Region Of
£485,000
Freehold



MANNLEYS

- Stunning Six Bedroom Detached New Build Home over 2100sqft of Accommodation
- Established Location with Fantastic Local Amenities & Road Links
- Superb Open Kitchen/Dining/Family Room with Dual French Patio Doors
- Sitting Room & Study & Utility & Ground Floor wc
- Reception Hallway with Feature Oak & Glass Staircase
- First Floor Main Bedroom & Guest Bedroom with En-Suite Showers
- Two Further First Floor Double Bedrooms & Family Bathroom
- Two Further Top Floor Bedrooms with Shower Room
- Extensive Driveway Parking & Landscaped Gardens
- Air Source Heating with Underfloor to Ground Floor



Mannleys Sales & Lettings

23A Market Street, Wellington,
Telford, TF1 1DT

01952 245 064

info@mannleysproperty.co.uk
mannleysproperty.co.uk

IMPORTANT: we would like to inform prospective purchasers that these sales particulars have been prepared as a general guide only. A detailed survey has not been carried out, nor the services, appliances and fittings tested. Room sizes should not be relied upon for furnishing purposes and are approximate. If floor plans are included, they are for guidance only and illustration purposes only and may not be to scale. If there are any important matters likely to affect your decision to buy, please contact us before viewing the property.



Introducing this exquisite new-build six-bedroom detached executive home, offering over 2100 sq ft of flexible and stunning family accommodation. Nestled in a highly sought-after established location with excellent local amenities and convenient road links, this property is a true gem.

The ground floor presents an impressive open-plan kitchen/dining /family room featuring a central island and integrated appliances. Complementing this, there is a spacious sitting room, a family room, utility, ground floor WC, and a welcoming entrance hallway with an oak and glass staircase.



Mannleys Sales & Lettings

23A Market Street, Wellington,
Telford, TF1 1DT

01952 245 064

info@mannleysproperty.co.uk
mannleysproperty.co.uk

IMPORTANT: we would like to inform prospective purchasers that these sales particulars have been prepared as a general guide only. A detailed survey has not been carried out, nor the services, appliances and fittings tested. Room sizes should not be relied upon for furnishing purposes and are approximate. If floor plans are included, they are for guidance only and illustration purposes only and may not be to scale. If there are any important matters likely to affect your decision to buy, please contact us before viewing the property.



On the first floor, you'll find the main and guest bedrooms, both with en-suite showers, along with two additional double bedrooms and a family bathroom.

The top floor of Field View offers two more double bedrooms and a convenient shower room.

Notable features include extensive driveway parking, landscaped gardens, air source heating with underfloor heating to the ground floor, and radiators to the first floor.

An inspection is a must to fully appreciate the superb merits of this lovely home.



Mannleys Sales & Lettings

23A Market Street, Wellington,
Telford, TF1 1DT

01952 245 064

info@mannleysproperty.co.uk
mannleysproperty.co.uk



Mannleys Sales & Lettings
23A Market Street, Wellington,
Telford, TF1 1DT
01952 245 064
info@mannleysproperty.co.uk
mannleysproperty.co.uk

IMPORTANT: we would like to inform prospective purchasers that these sales particulars have been prepared as a general guide only. A detailed survey has not been carried out, nor the services, appliances and fittings tested. Room sizes should not be relied upon for furnishing purposes and are approximate. If floor plans are included, they are for guidance only and illustration purposes only and may not be to scale. If there are any important matters likely to affect your decision to buy, please contact us before viewing the property.

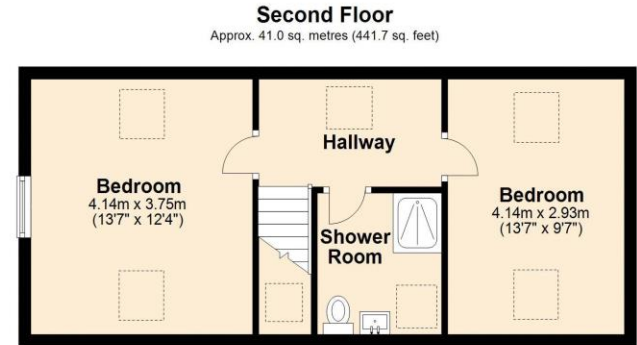
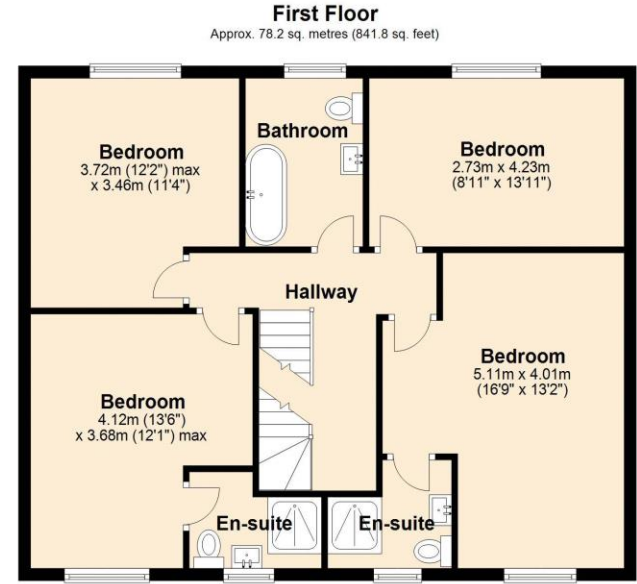

Total area: approx. 201.4 sq. metres (2168.4 sq. feet)

All images used are for illustrative purposes only and are intended to convey the concept and vision for the development/apartments/houses. They are for guidance only, may alter as work progresses and do not necessarily represent a true and accurate depiction of the finished product and specification may vary.
Plan produced using PlanUp.

Mannleys Sales & Lettings
23A Market Street, Wellington,
Telford, TF1 1DT
01952 245 064
info@mannleysproperty.co.uk
mannleysproperty.co.uk

IMPORTANT: we would like to inform prospective purchasers that these sales particulars have been prepared as a general guide only. A detailed survey has not been carried out, nor the services, appliances and fittings tested. Room sizes should not be relied upon for furnishing purposes and are approximate. If floor plans are included, they are for guidance only and illustration purposes only and may not be to scale. If there are any important matters likely to affect your decision to buy, please contact us before viewing the property.