



Woodlands View, Leegomery, Telford

£165,000



Freehold | EPC rating: B

- Ideal First Time Purchase Or Investment
- Allocated Parking

- Fitted Kitchen with Intergrated Appliances
- Downstairs WC

BELVOIR!

Property is personal

Email
telford@belvoir.co.uk

Phone
01952 258562

Description

Belvoir are pleased to present to market this smart, terraced house within the popular residential area of Leegomery which is conveniently located to local amenities which includes shops, doctors surgery, primary school and within walking distance to the Princess Royal Hospital.

Woodlands View is an ideal first time purchase or investment opportunity and offers living accommodation briefly comprising; Fitted Kitchen with integrated oven and hob, fridge freezer and washer dryer, downstairs WC, lounge/diner with patio doors leading to the enclosed rear garden. Rising to the first floor, there is a double and a good sized single bedroom and bathroom with shower over the bath.

Freehold - Council Tax Band B - EPC Rating B

Advised by Vendor Annual Service Charge of £171.07

Floorplan

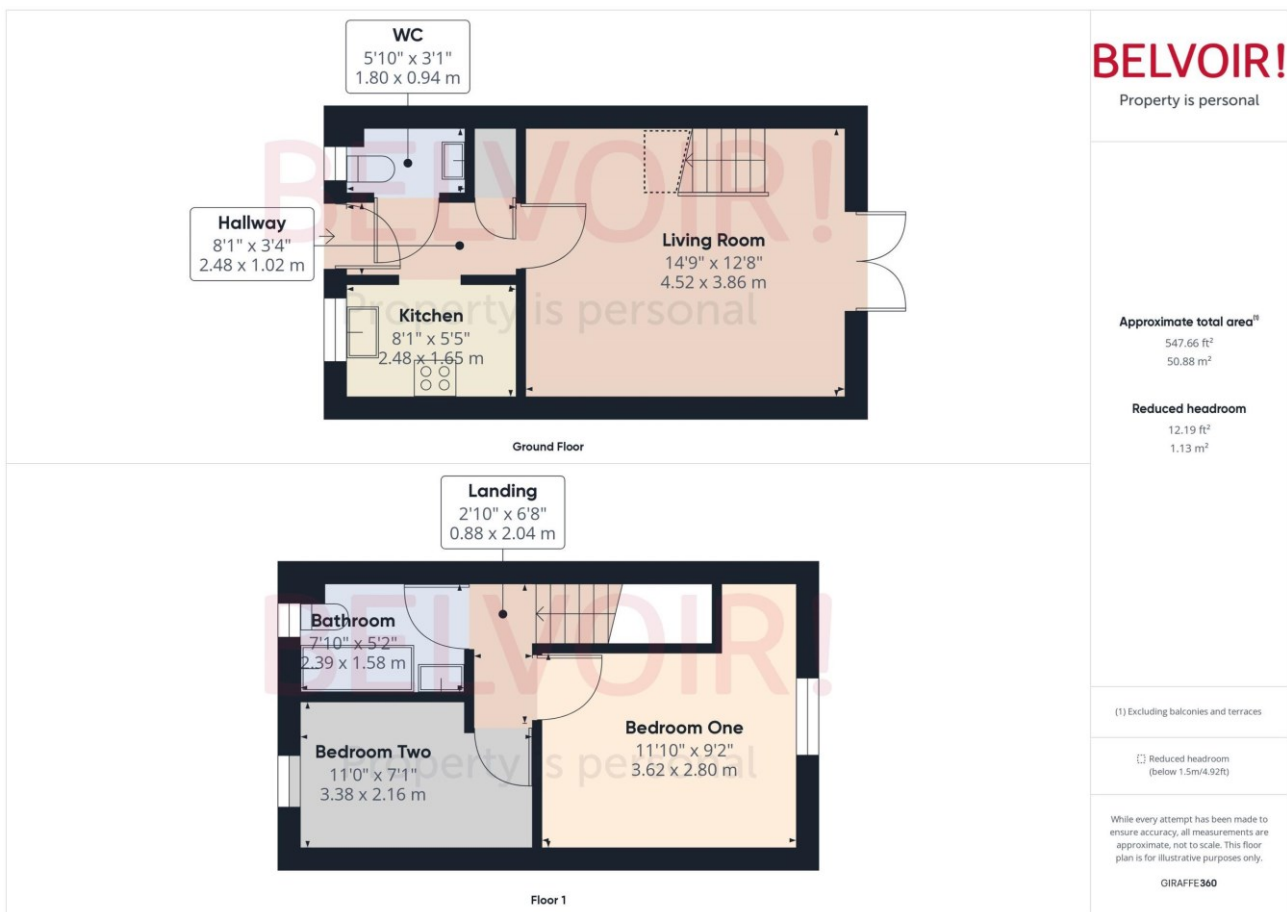

Rooms

Hallway

1.02m x 2.48m (3'4" x 8'1")

Living Room

4.52m x 3.86m (14'10" x 12'8")

Kitchen

1.65m x 2.48m (5'5" x 8'1")

Bedroom One

2.80m x 3.62m (9'2" x 11'11")

Bedroom Two

2.16m x 3.38m (7'1" x 11'1")

Bathroom

1.58m x 2.39m (5'2" x 7'10")

Landing

0.88m x 2.04m (2'11" x 6'8")

WC

0.94m x 1.80m (3'1" x 5'11")

Photographs



Map



Notes