



Furnace Avenue, Lightmoor, Telford
Shared ownership £56,250



Leasehold | EPC rating: B

- SHARED OWNERSHIP
- Fitted Kitchen & Open Plan Living
- Close To Local Primary School

- NEW BUILD DEVELOPMENT
- Downstairs WC
- LEASEHOLD

BELVOIR!

Property is personal

Email
telford@belvoir.co.uk

Phone
01952 258562

Description

*** NEW BUILD DEVELOPMENT*** A brand new semi detached two bedroom of modern style living, ***SHARED OWNERSHIP***

Nestled in the beautiful village of Lightmoor, The Croppings is an established development and is your gateway to an enhanced lifestyle, lasting memories, and a smart investment in your future. This exclusive property opportunity is not to be missed.

The brand new development is the perfect setting, with a blend of local amenities, near to the tranquility of open countryside , and convenient transport links, The Croppings in Lightmoor Village offers the perfect fusion of a serene village lifestyle and modern convenience. The Historical Charm of the The World Heritage town of Ironbridge lies just 3 miles to the south of this development. An ideal First-Time Buyers purchase or for Growing Families, you can find the space and comfort you and your loved ones deserve. Begin your home ownership journey in a thriving community .

SHARED OWNERSHIP

Price: Secure a 25% share for just £56,250 with flexible options for shares from 25% available - the share will be determined by the financial assessment.

Monthly Rent: Your 25% share comes with a monthly rent of £387.72 Monthly Service Charge: £42.52

Before you take the next step towards your dream home, we kindly request that interested parties complete a brief financial assessment. This will help ensure a seamless and efficient viewing process.

Leasehold / Council Tax Band B / EPC Rating B

Additional liabilities or obligations: Service charge pcm £42.52

Rent on 25% share is £387.72

Photographs



Rooms

Kitchen/Living Area

3.45m x 7.53m (11'4" x 24'8")

WC

1.02m x 1.76m (3'4" x 5'10")

Landing

1.11m x 2.24m (3'7" x 7'4")

Bedroom One

2.74m x 4.57m (9'0" x 15'0")

Bedroom Two

2.54m x 4.57m (8'4" x 15'0")

Bathroom

2.02m x 2.41m (6'7" x 7'11")

Floorplan

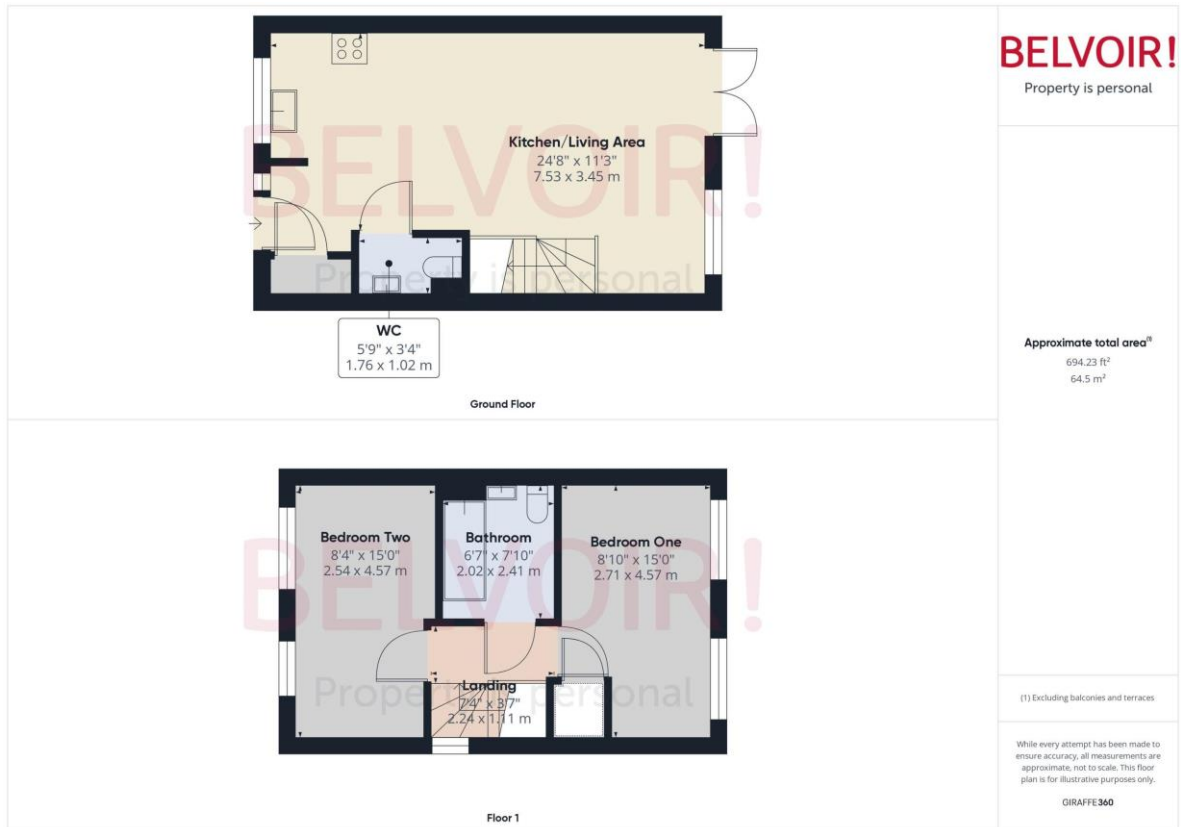

Map

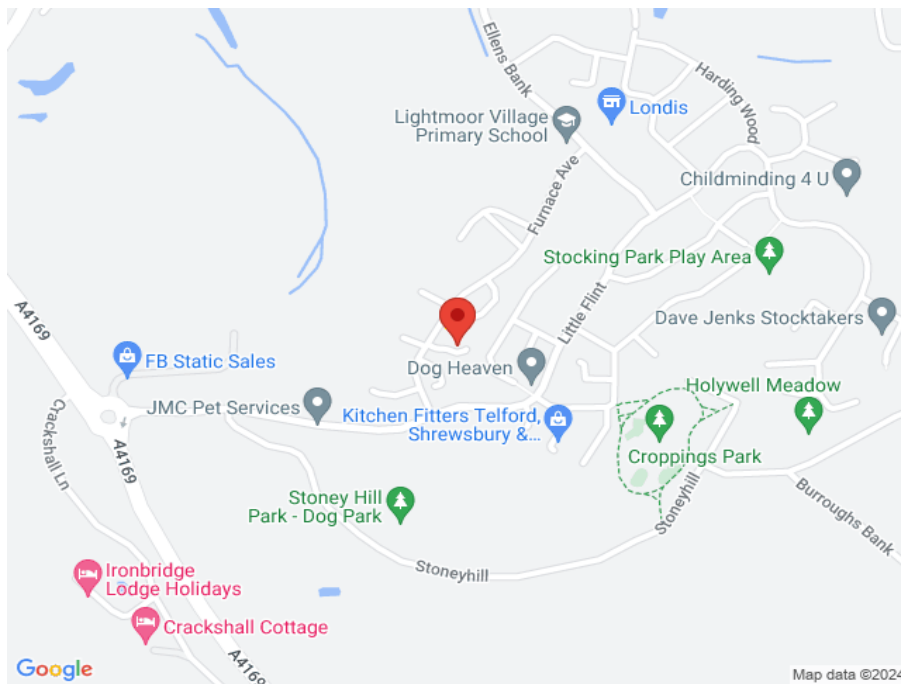

belvoir.co.uk/telford-estate-agents/