



**Furnace Avenue, Lightmoor, Telford**  
**Shared ownership £66,250**



 3  1  1

**Leasehold | EPC rating: B**

- Three Bedroom Semi Detached
- Private Parking
- Village Location

- New Build Development
- Shared Ownership
- Close to amenities

**BELVOIR!**

Property is personal

Email  
[telford@belvoir.co.uk](mailto:telford@belvoir.co.uk)

Phone  
**01952 258562**

## Description

\*\*\* NEW BUILD DEVELOPMENT\*\*\* A brand new semi detached two bedrooms of modern style living, \*\*\*SHARED OWNERSHIP\*\*\*

nestled in the beautiful village of Lightmoor, The Croppings is an established development and is your gateway to an enhanced lifestyle, lasting memories, and a smart investment in your future. This exclusive property opportunity is not to be missed.

The brand new development is the perfect setting, with a blend of local amenities, near to the tranquility of open countryside , and convenient transport links, The Croppings in Lightmoor Village offers the perfect fusion of a serene village lifestyle and modern convenience. The Historical Charm of the The World Heritage town of Ironbridge lies just 3 miles to the south of this development. An ideal First-Time Buyers purchase or for Growing Families, you can find the space and comfort you and your loved ones deserve. Begin your home ownership journey in a thriving community .

\*\*\*SHARED OWNERSHIP\*\*\*

Price: Secure a 25% share for just £65,250 with flexible options for shares from 25% available - the share will be determined by the financial assessment.

Monthly Rent: Your 25% share comes with a monthly rent of £455.47

Monthly Service Charge: £45.70

Before you take the next step towards your dream home, we kindly request that interested parties complete a brief financial assessment. This will help ensure a seamless and efficient viewing process.

## Floorplan

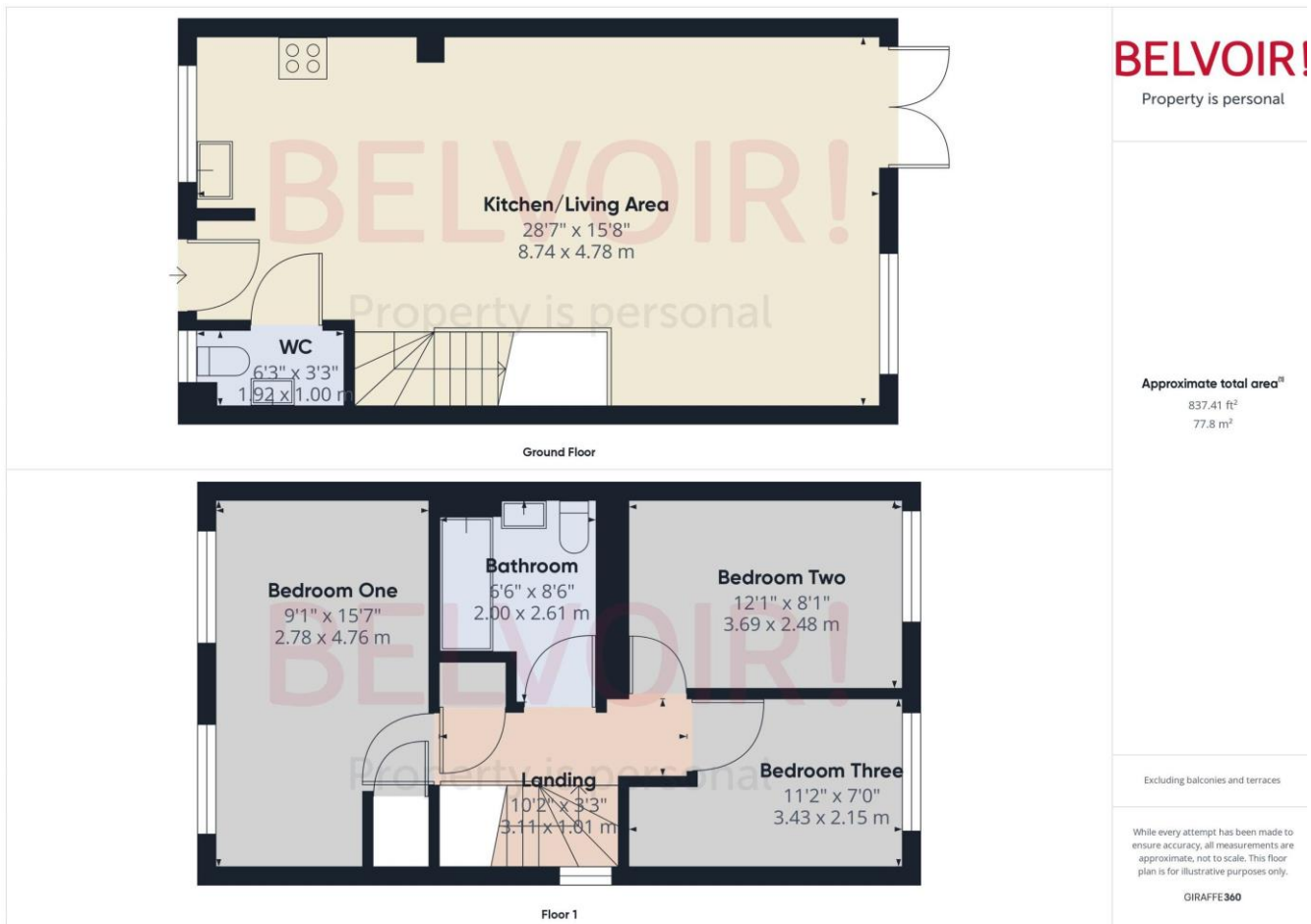

## Rooms

### **Kitchen/Living Area**

4.78m x 8.74m (15'8" x 28'8")

### **WC**

1.00m x 1.92m (3'4" x 6'4")

### **Landing**

1.01m x 3.11m (3'4" x 10'2")

### **Bedroom One**

2.78m x 4.76m (9'1" x 15'7")

### **Bedroom Two**

2.48m x 3.69m (8'1" x 12'1")

### **Bathroom**

2.00m x 2.61m (6'7" x 8'7")

### **Bedroom Three**

2.40m x 2.61m (7'11" x 8'7")

# Photographs



