



MILES ESTATE AGENTS

**51 Quantock View Bishops Lydeard
Taunton TA4 3AP £275,000**



Calling all garden lovers! A well presented and upgraded 3 bedroom semi detached house set in fabulous large and productive gardens with multiple sheds and outbuildings and uninterrupted views to the Quantock Hills in this ever popular village. Cosy sitting room with wood burning stove, lovely kitchen/dining room, multiple sheds and hidden log cabin at the bottom of the garden - off road parking & EV charge point too! Early viewing highly recommended. Freehold Council Tax Band B EPC : C





- Features:
- Entrance hall
 - Spacious sitting room with woodburner
 - Refitted kitchen/dining room with range cooker
 - 3 bedrooms
 - Family bathroom
 - Utility / store
 - Fantastic productive gardens with raised beds, multiple sheds & outbuildings, greenhouse, chicken run, pizza oven and firepit
 - Detached log cabin - ideal work from home space / cosy retreat
 - Off road parking & EV charging point
 - Freehold
 - EPC : C
 - Council Tax Band B



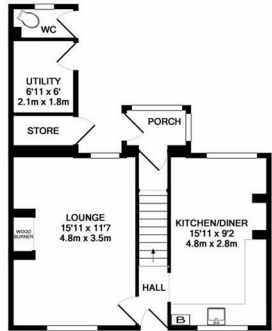
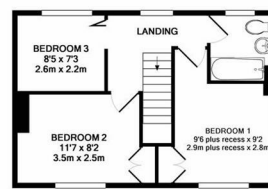

GROUND FLOOR
APPROX. FLOOR
AREA 647 SQ.FT.
(60.1 SQ.M.)

1ST FLOOR
APPROX. FLOOR
AREA 372 SQ.FT.
(34.6 SQ.M.)

TOTAL APPROX. FLOOR AREA 1019 SQ.FT. (94.7 SQ.M.)
Whilst every attempt has been made to ensure the accuracy of the floor plan contained herein, measurements of doors, windows, rooms and any other items are approximate and no responsibility is taken for any error, omission, or mis-statement. This plan is for illustrative purposes only and should be used as such by any prospective purchaser. The services, systems and appliances shown have not been tested and no guarantee as to their operability or efficiency can be given.
Made with Metropix 6.0.19

Energy Efficiency Rating		
	Current	Potential
Very energy efficient - lower running costs		
(92 plus) A		84
(81-91) B		
(69-80) C	69	
(55-68) D		
(39-54) E		
(21-38) F		
(1-20) G		
Not energy efficient - higher running costs		
England & Wales		EU Directive 2002/91/EC



Viewings strictly through the selling agents:

Miles Estate Agents

2 Piffin Lane, Bishops Lydeard, Taunton,
Somerset, TA4 3AS

Tel: 01823 470 500

lydeard@milesestateagents.co.uk

www.milesestateagents.co.uk



rightmove

OnTheMarket.com

MILES ESTATE AGENTS

