



**MILES ESTATE AGENTS**

**13 Hither Mead Bishops Lydeard  
Taunton TA4 3NH £275,000**





A modernised and well presented 3 bed semi detached house overlooking the village green and close to the many amenities of this wonderful Quantock village. Refitted kitchen and shower room, lovely enclosed garden, garage and parking. Early viewing recommended and NO ONWARD CHAIN. Freehold Council Tax Band C EPC : C.







## Features:

- Entrance hall
- Spacious sitting/dining room
- Refitted kitchen
- Cloakroom
- 3 good size bedrooms
- Refitted shower room
- Lovely enclosed garden
- Single garage in a block
- Off road parking
- NO ONWARD CHAIN
- Freehold
- Council Tax Band C
- EPC : C





# Hither Mead, Bishops Lydeard, Taunton, TA4

Approximate Area = 864 sq ft / 80.2 sq m

For identification only - Not to scale

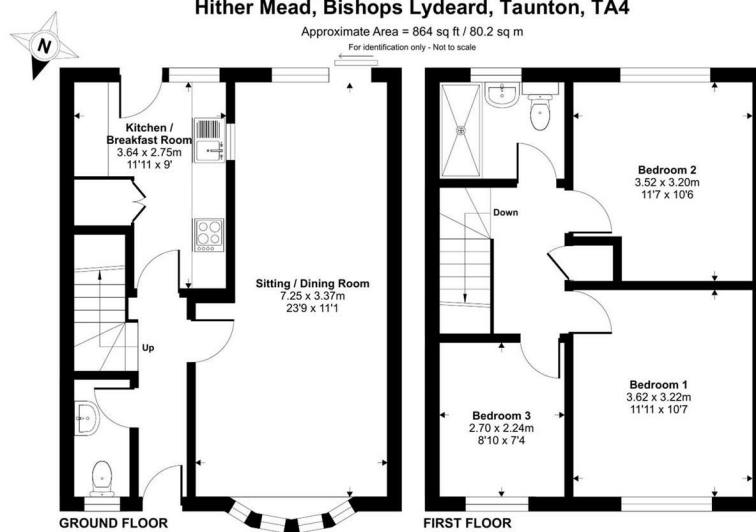

Floor plan produced in accordance with RICS Property Measurement 2nd Edition, incorporating International Property Measurement Standards (IPMS2 Residential). © richcom 2025. Produced for Miles Alexander Limited T/A Miles Estate Agents. REP.

Energy Efficiency Rating		
Very energy efficient - lower running costs	Current	Potential
(92 plus) A		85
(81-91) B		
(69-80) C	70	
(55-68) D		
(39-54) E		
(21-38) F		
(1-20) G		
Not energy efficient - higher running costs		
England & Wales		EU Directive 2002/91/EC



Viewings strictly through the selling agents:

**Miles Estate Agents**

2 Piffin Lane, Bishops Lydeard, Taunton, Somerset, TA4 3AS

**Tel: 01823 470 500**

[lydeard@milesestateagents.co.uk](mailto:lydeard@milesestateagents.co.uk)

[www.milesestateagents.co.uk](http://www.milesestateagents.co.uk)

**rightmove** 

**OnTheMarket.com** 

**MILES ESTATE AGENTS**

